

Note: Water Elev. 198
Taken on 3-17-69

SCALE: 1"=100'

NOTE: ESTIMATED SAND FILL
QUANTITY 111,400 C.Y.

NOTE: Earthwork has been computed
on quantities in place on the basis
of average end areas only, without any
factor for shrinkage. The earthwork
quantities have been carefully estimated
but are not guaranteed. These quantities
are presented for information only, and
it is the responsibility of the Contractor
to verify them and submit his lump sum
bid for earthwork accordingly.

NOTE: Finished grades are from a
computer print-out. The contractor
is responsible for staking the elevations
to the nearest tenth of a foot.

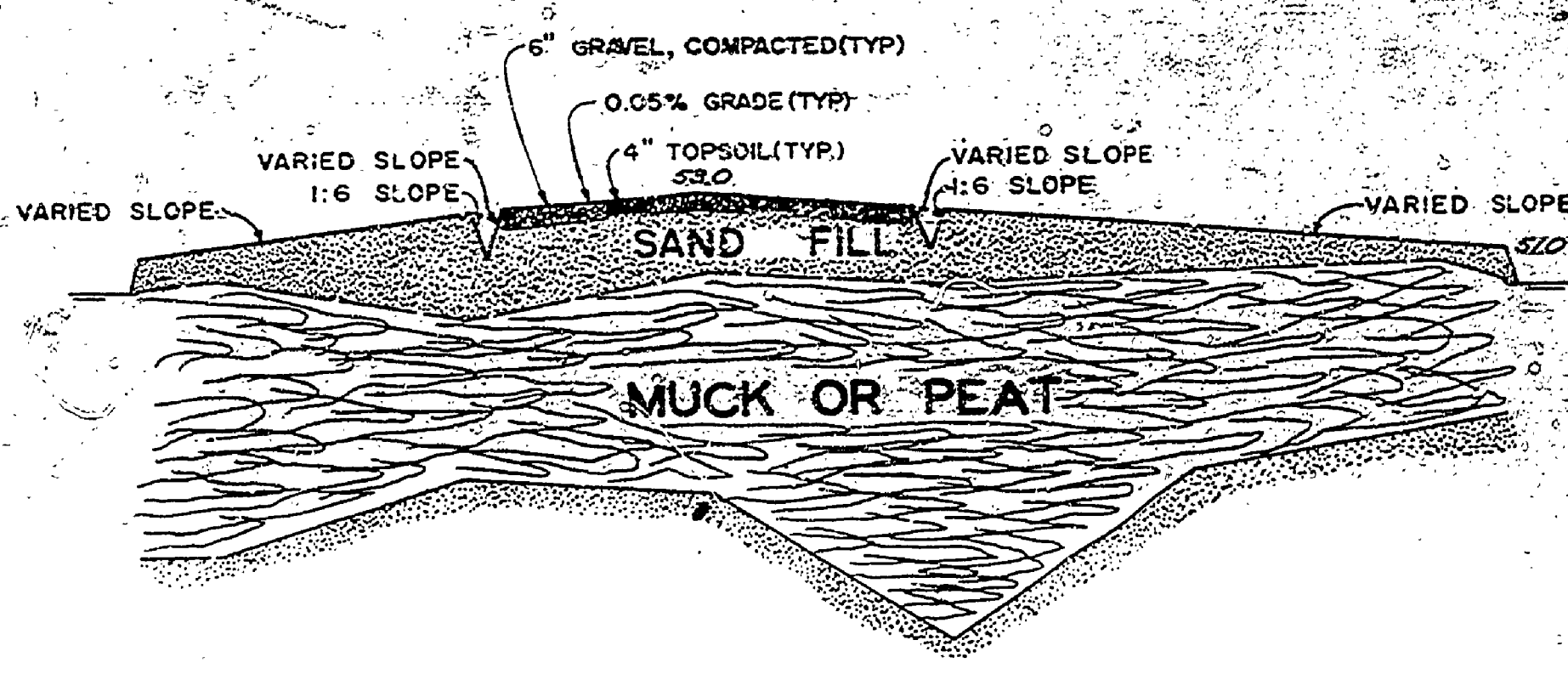
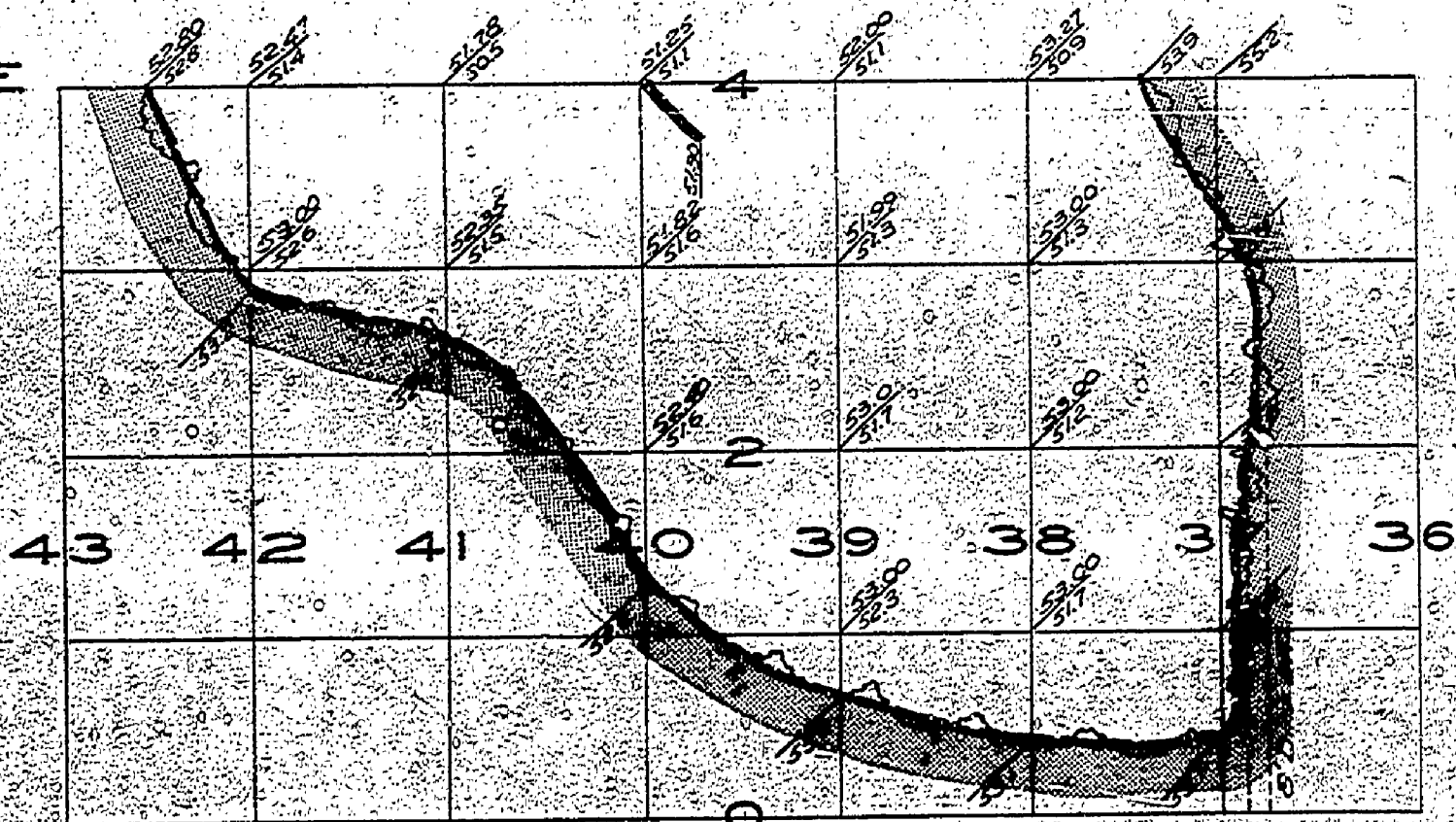

SECTION A-A
SCALE: HOR. 1"=100'
VER. 1"=5'

- LEGEND
- DITCH CENTERLINE
 - OUTSIDE LIMITS OF GRADING WORK
 - OUTSIDE LIMITS OF WORK
 - ▲ PROPOSED ELEV.
▲ EXISTING ELEV.

GRADING PLAN-PICNIC AREA

PROJECT NO. - P.C. 110-75-2499-028-C6				MICHIGAN DEPARTMENT of	
DR. BY	DATE	CHD. BY	DATE	NATURAL RESOURCES	
R.D.R.	9-69	E.M.F.	9-69	PARKS	DIVISION:
NO. REVISIONS				YANKEE SPRINGS RECREATION AREA	
				WILLIAMS & WORKS	
				ENGINEERS - PLANNERS - SURVEYORS	
				GRAND RAPIDS, MICHIGAN	
				SHEET NO. 3/10	