

NOTE: Water Elev. 498
taken on 3-17-69

WEST GUN LAKE

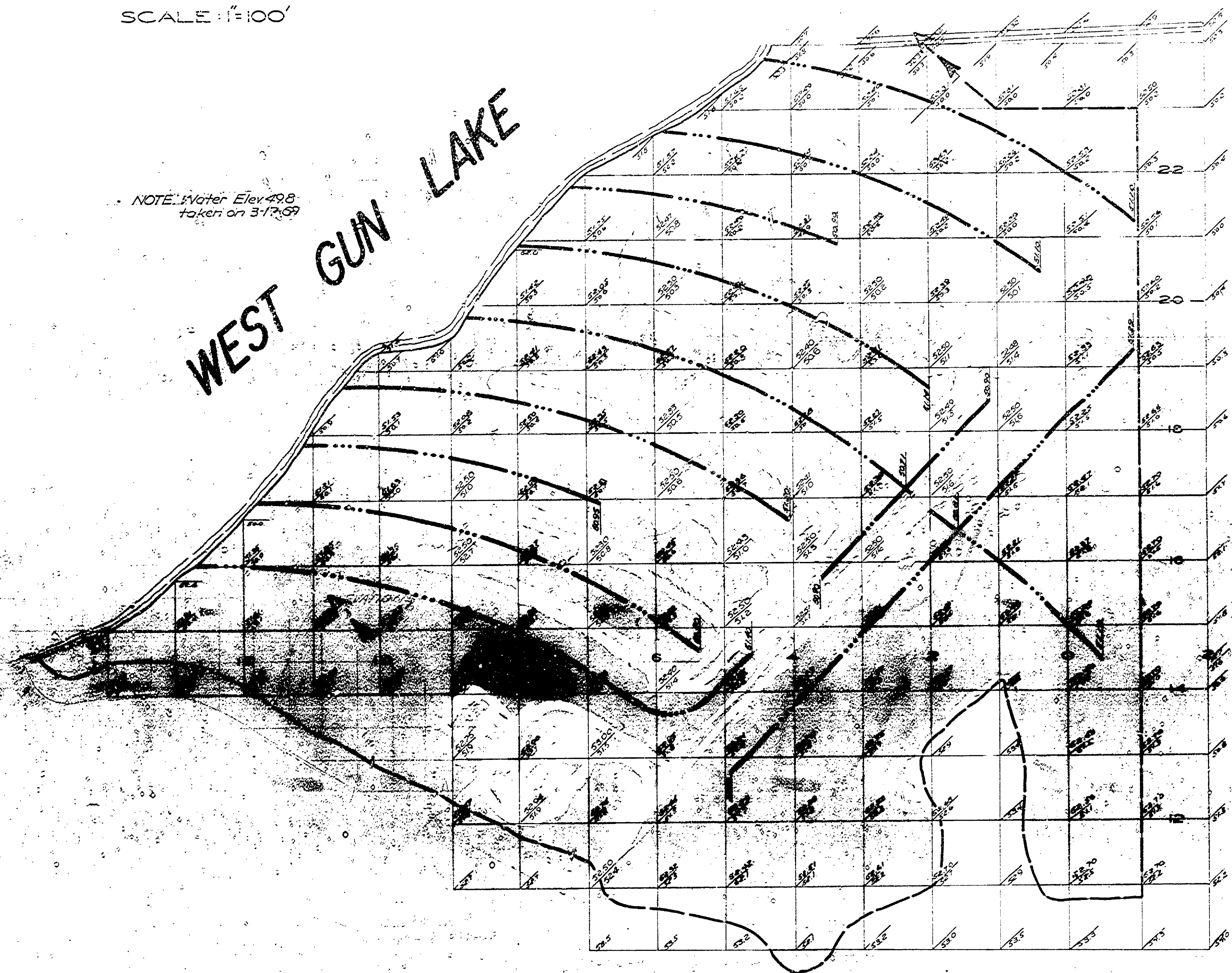

NOTE: ESTIMATED SAND FILL
QUANTITY: 60900 CY.

NOTE: Finished grades are from a
computer print-out. The contractor
is responsible for staking the elevations
to the nearest tenth of a foot.

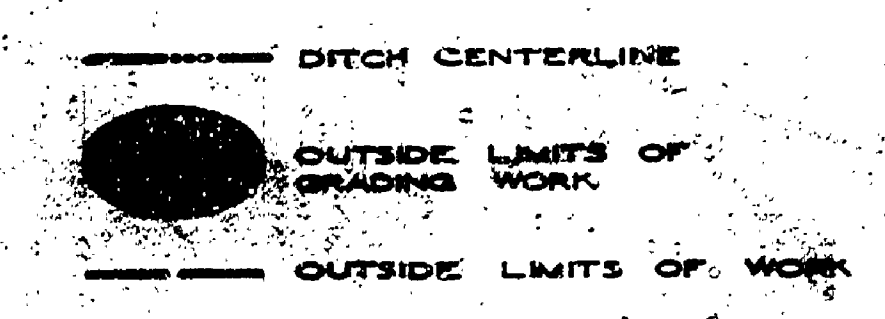

LEGEND

NOTE: Earthwork has been computed on
quantities in place on the basis of average
end areas only, without any factor for
shrinkage. The earthwork quantities have
been carefully estimated, but are not
guaranteed. These quantities are presented
for information only, and it is the responsibility
of the Contractor to verify them and submit
his lump sum bid for earthwork accordingly.

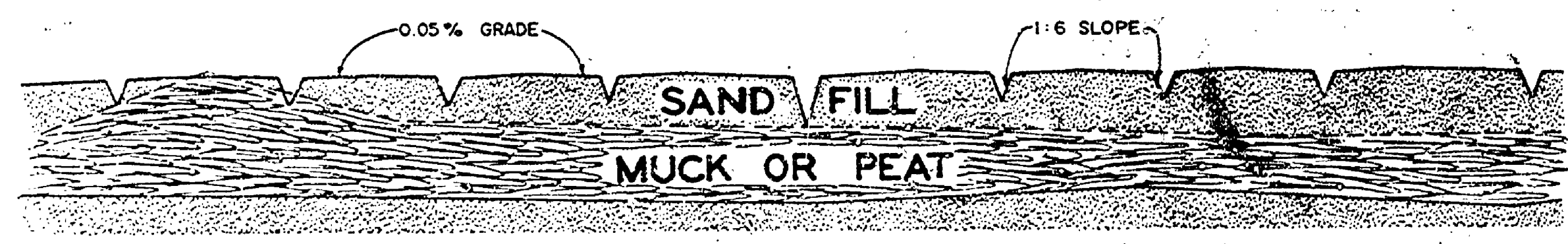

SECTION A - A

SCALES: HOR. 1" = 100'
VERT. 1" = 5'

GRADING PLAN - NORTH AREA

PROJECT NO. - Pa. 110-75-2499-028 C6				MICHIGAN DEPARTMENT of	
DR. BY DATE		CHD. BY DATE		NATURAL RESOURCES	
R.D.R. 9-69		E.M.F. 9-69		PARKS DIVISION	
NO. REVISIONS				YANKEE SPRINGS RECREATION AREA	
				WILLIAMS & WORKS	
				ENGINEERS - PLANNERS - SURVEYORS	
				GRAND RAPIDS, MICHIGAN	
				SHEET NO. 7/10	

E-145