

DRAWN BY	L.M.C.	REVIEWED BY SECTIONS	DATE	APPROVED BY	NO. DATE BY	REVISIONS	DATE	BY
TRACED BY		ARCHITECTURAL		ASSISTANT CHIEF IN CHARGE	1	4		
CHECKED BY		ENGINEERING		OF DESIGN	2	5		
DATE	12-11-53	LANDSCAPE			3	6		

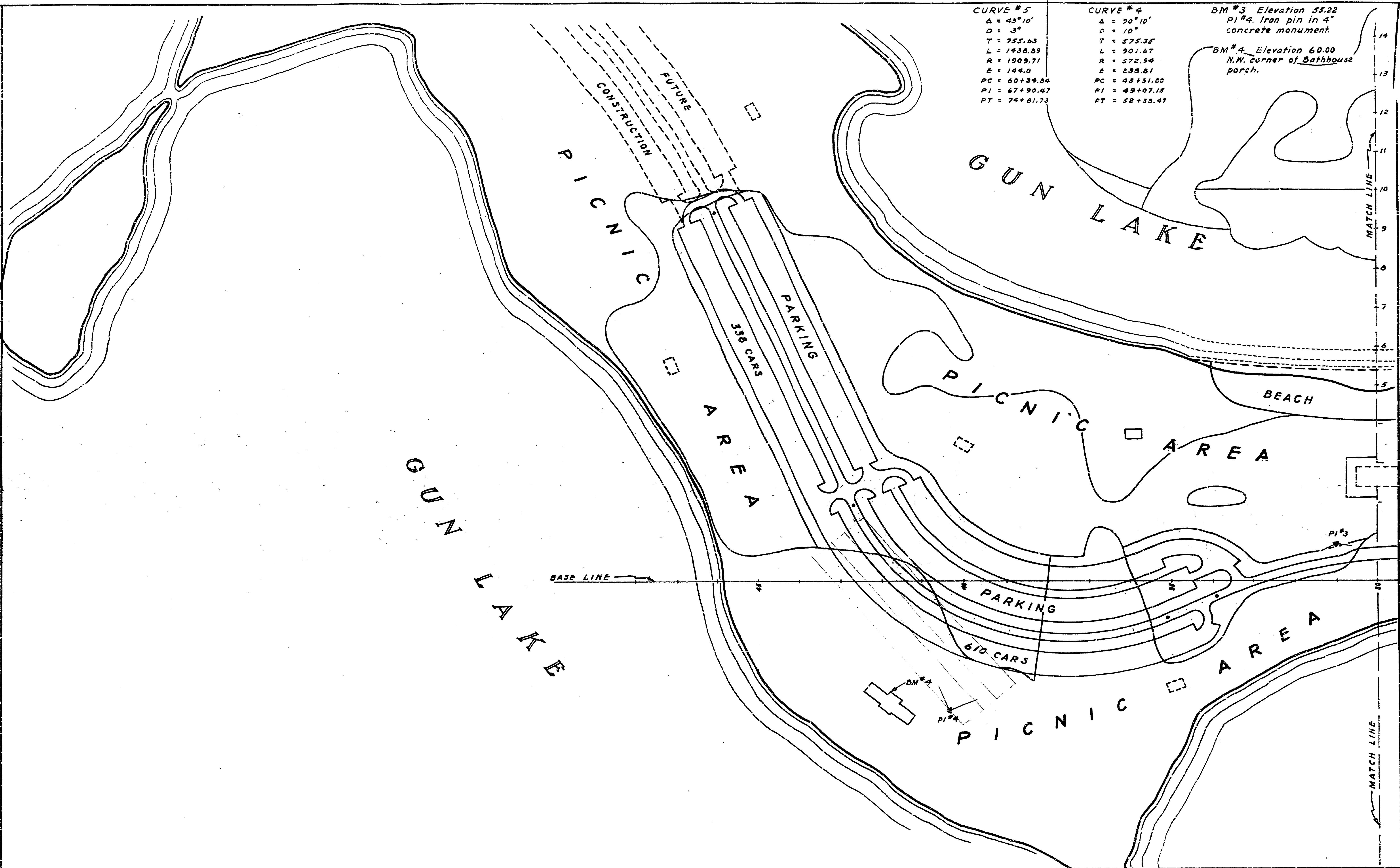

CURVE #5  
 $\Delta = 43^{\circ}10'$   
 $D = 3^{\circ}$   
 $T = 755.63$   
 $L = 1438.89$   
 $R = 1909.71$   
 $E = 144.0$   
 $PC = 60+34.84$   
 $PI = 67+90.47$   
 $PT = 74+01.73$

CURVE #4  
 $\Delta = 90^{\circ}10'$   
 $D = 10^{\circ}$   
 $T = 575.35$   
 $L = 901.67$   
 $R = 572.94$   
 $E = 238.81$   
 $PC = 43+31.60$   
 $PI = 49+07.15$   
 $PT = 52+33.47$

BM #3 Elevation 55.22  
 PI #4, Iron pin in 4" concrete monument.  
 BM #4 Elevation 60.00  
 N.W. corner of Bathhouse porch.

SCALE - 1" = 100'

MICHIGAN DEPARTMENT OF CONSERVATION  
 PARKS AND RECREATION DIVISION

YANKEE SPRINGS RECREATION AREA  
 GUN LAKE DAY USE SECTION  
 ROAD & PARKING AREA LAYOUT

SHEET NO. 3 OF 10

PLAN NO. L-123