

CURVE DATA

Δ = 23° 22' L
 D = 8° 00'
 T = 148.1'
 L = 292.1'
 E = 75.1'
 R = 716.8'
 P.C. 25+50.8
 P.T. 26+48.9
 P.T. 28+42.9

B.M.#5 Elev. 591.05
 Tag in 18" Poplar
 Location as per topo.

U.S. Coast Guard Station

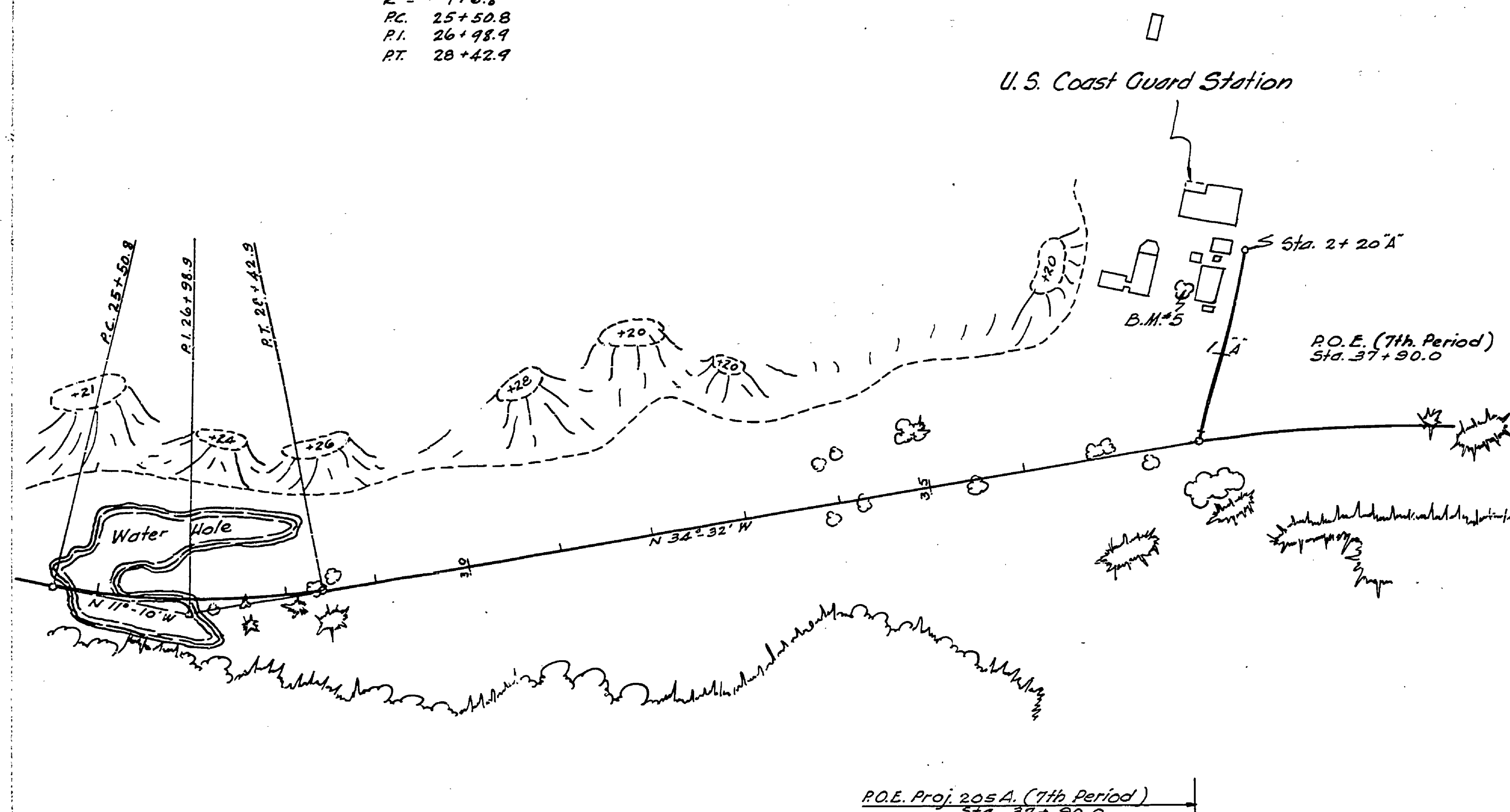

P.O.E. Proj. 205A (7th Period)
 Sta. 37+90.0

DATE 5-36
 BY R.A. Fujiz
 CHECKED BY [Signature]
 DRAWN BY [Signature]

DATE 7-36
 BY K.M. Knudson
 CHECKED BY [Signature]
 DRAWN BY [Signature]

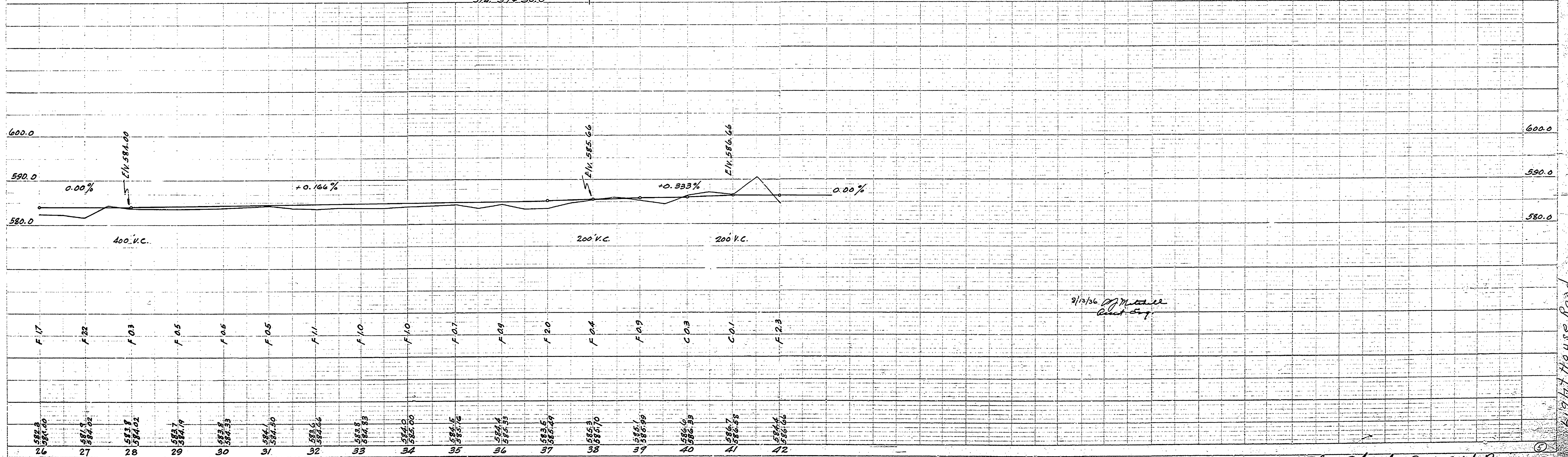

9/12/36 J.M. Knudson
 Check Eng.

Light House Road

Approved Sterling Myrick
 Ludington S.P. E-81