

Approved
K. H. H. H.

Approved & Registered
K. H. H. H.

PROJECT

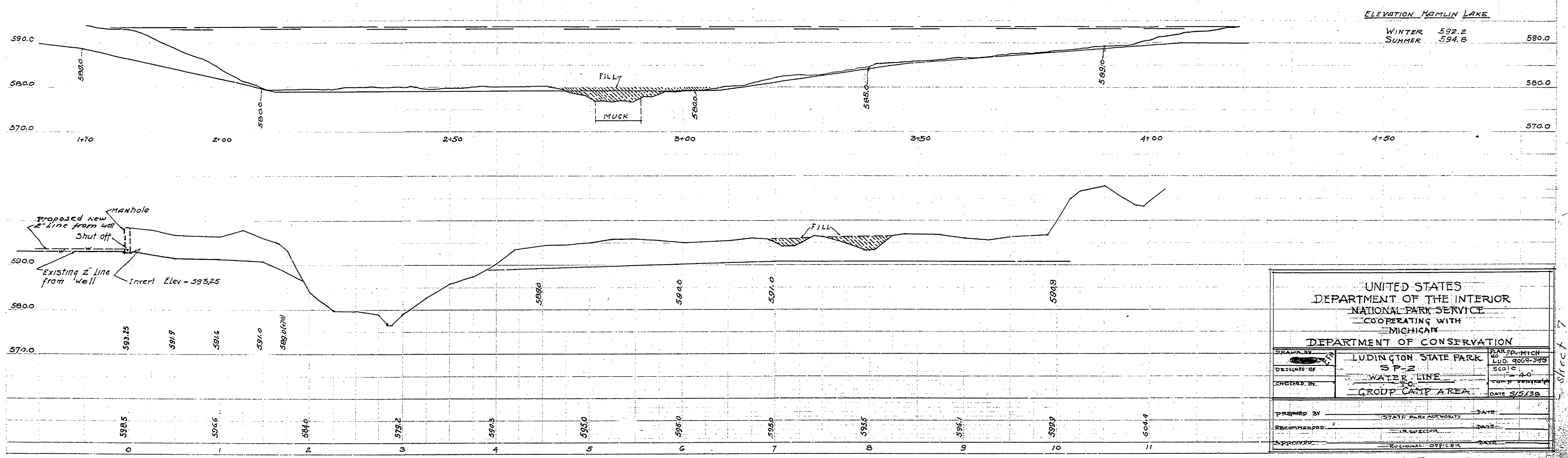
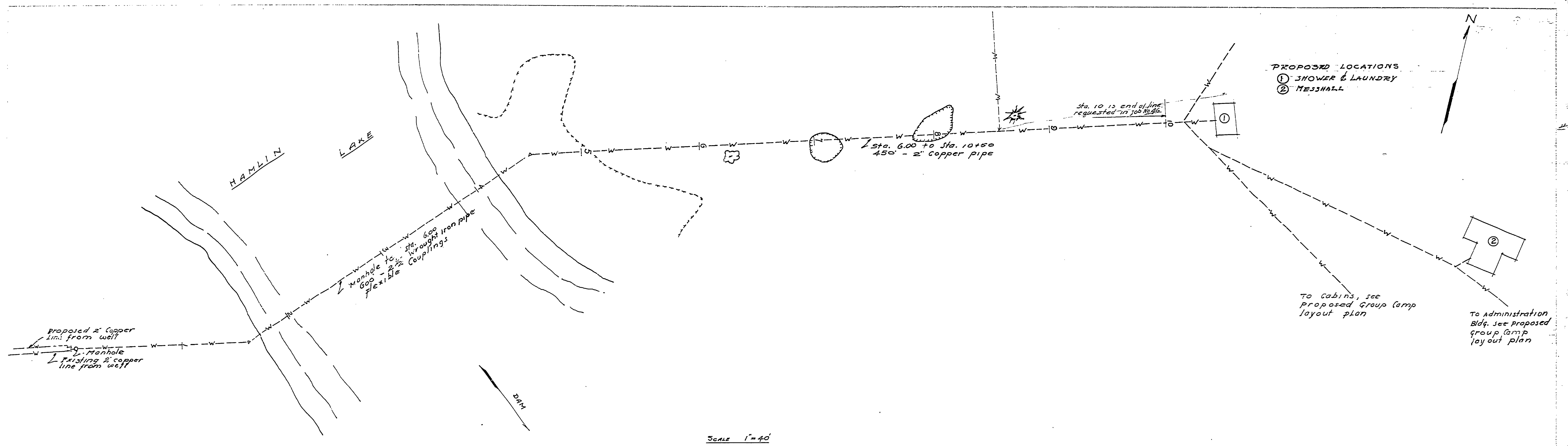

UNITED STATES DEPARTMENT OF THE INTERIOR NATIONAL PARK SERVICE COOPERATING WITH MICHIGAN DEPARTMENT OF CONSERVATION		
DRAWN BY DESIGNED BY CHECKED BY	LUDINGTON STATE PARK SP-2 WATER LINE GROUP CAMP AREA	PARK PD-MICH NO. 4069-398 SCALE 1" = 40' DATE 5/5/38
PREPARED BY RECOMMENDED BY APPROVED BY	STATE PARK AUTHORITY REGIONAL OFFICE REGIONAL OFFICE	DATE DATE DATE