

LUDINGTON STATE PARK CONSTRUCTION PLANS FOR PUMPHOUSE & WATER LINES AT CEDARS CAMPGROUND

PROJECT NO. PA 999-9972-976-020-C8

LEGEND

	EXISTING PIPE & MANHOLE
	PROPOSED PIPE LINE
	EXISTING DRINKING FOUNTAIN
	WATERLINE MARKER

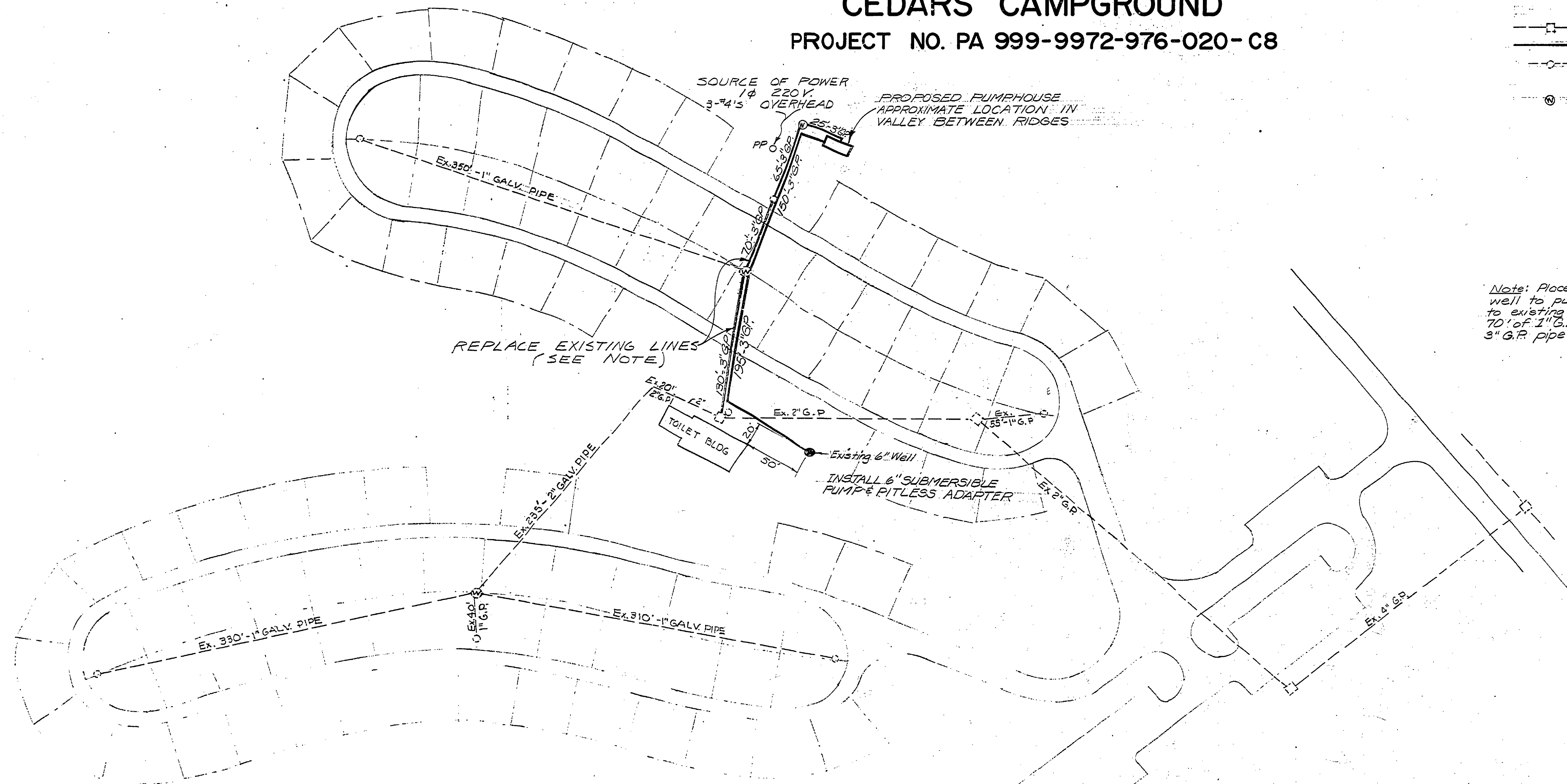

REPLACE EXISTING LINES
(SEE NOTE)

Note: Place 3" Galv. iron pipe from well to pumphouse & from pumphouse to existing drinking fountain. Replace 70' of 1" G.P. & 130' of 2" G.P. with 3" G.P. pipe.

NOTES:
ALL WATER LINES TO BE INSTALLED WITH A MINIMUM COVER OF 4 FEET

RUN 3-#4 CONDUCTORS UNDERGROUND FROM PUMPHOUSE TO SUBMERSIBLE PUMP. PIPE ALIGNMENT MAY BE FOLLOWED IF A 5' HORIZONTAL SEPARATION IS MAINTAINED.

WATER LINE MARKERS TO BE A 4" DIA. BY 2' LONG CONCRETE CYLINDER WITH "W" INSCRIBED IN TOP. INSTALL WHERE SHOWN.

INSTALL 60 AMP CIRCUIT BREAKER ON EXISTING POWER POLE FOR OVERHEAD SERVICE TO PUMPHOUSE.

BUILDING COMMITTEE APPROVAL	
BY: _____	DATE: _____
DESIGN	
RECOMMENDED FOR APPROVAL: <i>H. E. Beuba</i>	DATE: <i>5/29/69</i>
DESIGNER	
RECOMMENDED FOR APPROVAL: <i>E. J. Pentel</i>	DATE: <i>5/29/69</i>
PROGRAM MANAGING COORDINATOR	
DIVISION APPROVAL	
BY: <i>R. O. Dooly</i>	DATE: <i>6-6-69</i>
DIVISION CHIEF	
MICHIGAN DEPARTMENT OF NATURAL RESOURCES	
APPROVED: <i>H. C. Mendenhall</i>	DATE: <i>6-9-69</i>
CHIEF ENGINEER	
PLAN NO. _____	PROJECT NUMBER _____
_____	SHEET OF _____

SURVEYED BY	DRAWN BY	NO.	DATE	BY	REVISIONS	NO.	DATE	BY	REVISIONS
DESIGNED BY RHM	5-66	1.	5/28/69	H.M.	Cedars Campground Water Syst.	3.			
		2.				4.			