

DESIGNED BY	DATE	REVIEWED	DATE	APPROVED	DATE	NO.	DATE	BY	REVISIONS	DATE	BY
DRAWN BY R. CHARD	4-62	ARCHITECTURAL				1			4		
CHECKED BY		ENGINEERING				2			5		
		LANDSCAPE				3			6		

- BUILDING CODE**
- 1- BATH HOUSE
 - 2- MANAGERS HOUSE
 - 3- GARAGE
 - 4- STAFF QUARTERS
 - 5- STAFF GARAGE
 - 6- STORAGE GARAGE
 - 7- COMBINATION BLDG
 - 8- TOILET BUILDING
 - 9- FIRE CIRCLE

- LEGEND**
- PP— PUBLIC POWER LINE
 - P— PARK POWER LINE
 - UTILITY POLE
 - ⊞ TRANSFORMER
 - ⊞ TRANS. METER
 - ⊞ ELECTRICAL OUTLET BOX

- LEGEND**
- W— WATER LINE
 - S— SEWER LINE
 - ⊞ DRINKING FOUNTAIN
 - ⊞ STORAGE TANK

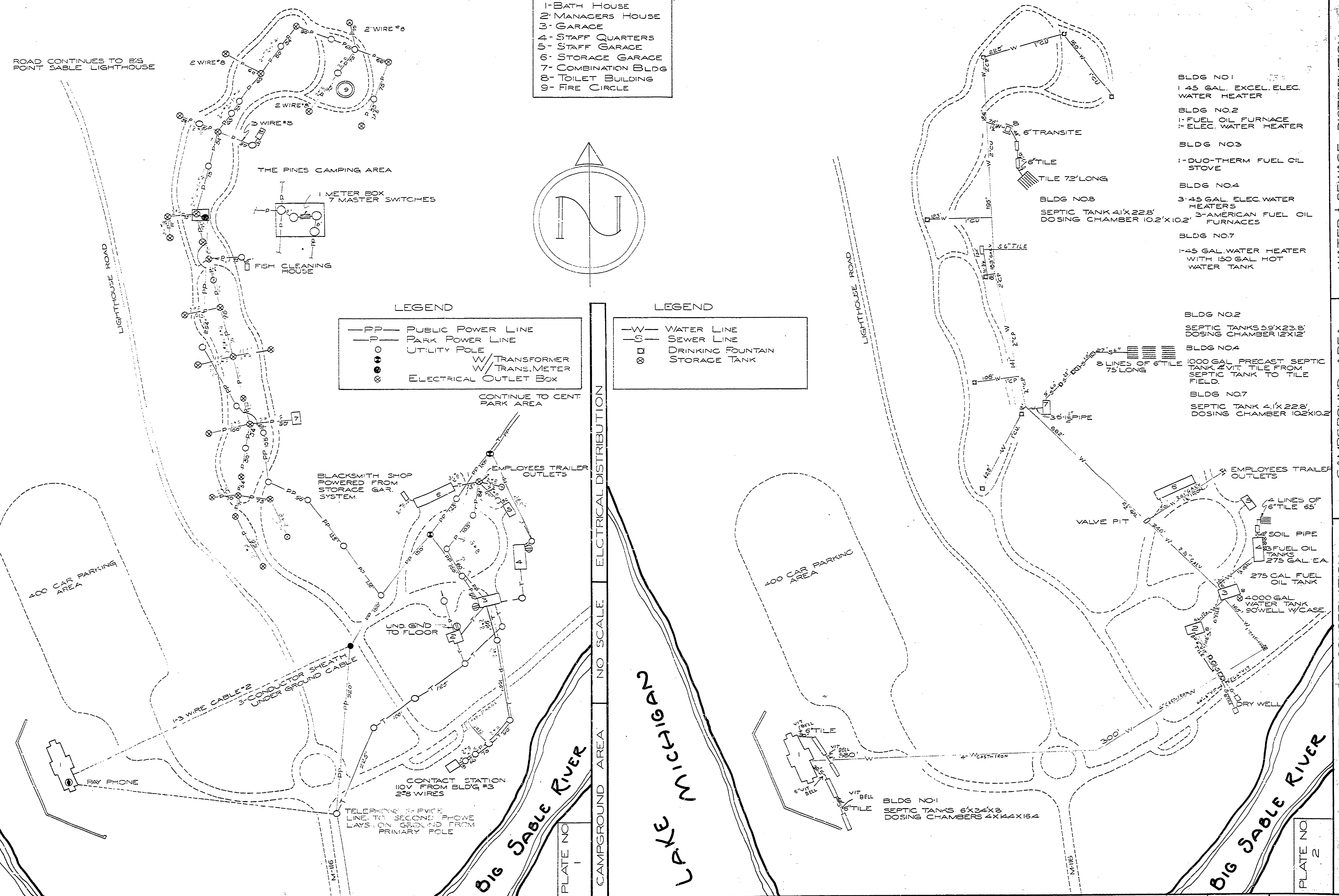

- BLDG NO. 1**
1-45 GAL. EXCEL. ELEC. WATER HEATER
- BLDG NO. 2**
1- FUEL OIL FURNACE
1- ELEC. WATER HEATER
- BLDG NO. 3**
1- DUO-THERM FUEL OIL STOVE
- BLDG NO. 4**
3-45 GAL. ELEC. WATER HEATERS
SEPTIC TANK 4'X22'
DOSING CHAMBER 10.2'X10.2'
- BLDG NO. 7**
1-45 GAL. WATER HEATER WITH 150 GAL. HOT WATER TANK
- BLDG NO. 2**
SEPTIC TANKS 5.5'X23.8'
DOSING CHAMBER 12'X12'
- BLDG NO. 4**
1000 GAL. PRECAST SEPTIC TANK 4'X17'
TILE FROM SEPTIC TANK TO TILE FIELD.
- BLDG NO. 7**
SEPTIC TANK 4'X22'
DOSING CHAMBER 10.2'X10.2'

LUDINGTON STATE PARK

MICHIGAN DEPARTMENT OF CONSERVATION
PARKS AND RECREATION DIVISION

CAMPGROUND AREA
ELECTRICAL WATER AND SEWAGE DIST.
NO SCALE

SHEET NO. 3 OF 4
PLAN NO. C-1

MICHIGAN DEPARTMENT OF CONSERVATION CAMPGROUND AREA WATER & SEWAGE DISTRIBUTION