

**NOTES**

The following notes are included to clarify construction details:

**Campground Entrance Road:** The existing road from the existing blacktop to the first intersection and the road to the campground loop should be raised a minimum of six inches. The approximate length of road involved is 1,500 feet. Additional areas need to be identified for raising one foot or more to assist in drainage and allow for more culverts and ditches.

**Campsite Roads:** Realignment of the road system will require construction of 400 feet of new road and eliminate 600 feet of existing road. All roads in the campground should be raised one foot. Additional culverts will also be needed to improve drainage.

**Campsites:** In conjunction with the raising of the roads, a portion of each site (15' x 40' minimum) will also be raised and graded for drainage. Care will be taken to save as many trees as possible and to reestablish drainage patterns which have become ineffective over time due to lack of regular maintenance. A total of 87 campsites will be constructed. This is an increase of 62 sites. Each site is approximately 50' x 50' in size or 2,500 square feet.

REVIEWED BY: Henry H. [Signature] 1-9-84  
IN CHARGE, PROGRAM PLANNING DATE

APPROVED BY: Jack Butterfield 1-9-84  
CHIEF, PARKS DIVISION DATE

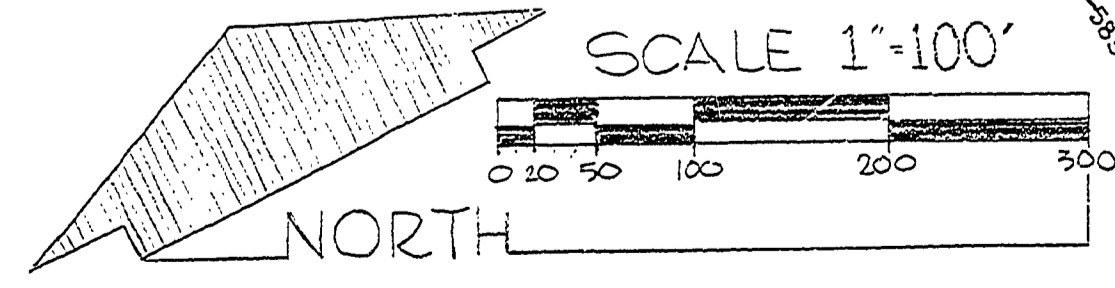

VOID

SURVEYED BY	DESIGNED BY WICKS	DRAWN BY HELMIC	1-9-84	NO.	DATE	BY	REVISIONS	NO.	DATE	BY	REVISIONS	MICHIGAN DEPARTMENT OF NATURAL RESOURCES	RUSTIC CAMPGROUND IMPROVEMENT	ALGONAC STATE PARK AREA OR PARK PROJECT	PROJECT NO.	SHEET 1 OF 1	PLAN NO. 112
		CHECKED BY		1.	1-9-84	S.H.	CHANGED ROAD PATTERN AT CROSS	3.									
				2.				4.									