

R.P. #	COORD'S
11	N 6402.297 E 4287.115
13	N 7006.233 E 4289.753

HORIZONTAL CURVE NO. 1	HORIZONTAL CURVE NO. 2	HORIZONTAL CURVE NO. 3
$\Delta=29^{\circ}07'18''$ $D=38^{\circ}11'50''$ $R=150.00'$ $T=38.96'$ $L=76.24'$ $PC=1+00.94$ $PT=1+77.18$ $PI=1+39.90$	$\Delta=38^{\circ}24'01''$ $D=5^{\circ}43'46''$ $R=150.00'$ $T=52.24'$ $L=100.54'$ $PC=2+57.15$ $PT=3+57.69$ $PI=3+9.39$	$\Delta=23^{\circ}16'58''$ $D=5^{\circ}43'46''$ $R=1000.00'$ $T=206.02'$ $L=406.37'$ $PC=4+48.42$ $PT=8+54.79$ $PI=6+54.45$
$\begin{matrix} N & 5771.569 \\ E & 4098.037 \\ N & 5808.118 \\ E & 4111.534 \\ N & 5846.617 \\ E & 4105.538 \end{matrix}$	$\begin{matrix} N & 5925.633 \\ E & 4093.232 \\ N & 5977.747 \\ E & 4085.194 \\ N & 6022.689 \\ E & 4110.954 \end{matrix}$	$\begin{matrix} N & 6101.623 \\ E & 4155.701 \\ N & 6280.852 \\ E & 4257.301 \\ N & 6485.645 \\ E & 4279.784 \end{matrix}$

WITNESS TO R.P.
 R.P. #11 (1/2" BAR EAST SIDE ROAD)
 SET NAIL AND TAG EAST SIDE 24" ASH, NORTH, 40.05'
 SET NAIL AND TAG NORTH SIDE 6" MAPLE, S60°W, 96.70'
 R.P. #13 (1/2" BAR EAST SIDE ROAD)
 SET NAIL AND TAG SOUTH SIDE 10" 7MN ASH, S80°W, 22.38'
 SET NAIL AND TAG NORTH SIDE 6" SASAFRAS, EAST, 10.33'
 SET NAIL AND TAG EAST SIDE 4" SASAFRAS, N10°E, 13.20'
 BENCH MARK 3
 PK NAIL IN THE NORTH SIDE OF 30" MAPLE 530E
 87.5' FROM RP #2 ELEVATION 88.88
 ALL ELEVATIONS ARE 50.00 FEET PLUS



WAGON WHEEL SERVICE DRIVE QUANTITIES		
STA. 0+41 TO STA.15+10 AND STA. 0+00 TO STA. 2+67		
ITEM	ESTIMATED QUANTITIES	UNIT USED
REMOVING TREES 8"-18" DIAMETER	5	EACH
REMOVING TREES 19"-36" DIAMETER	3	EACH
* EARTH EXCAVATION	541	C.Y.
EMBANKMENT (CIP)	959	C.Y.
MACHINE GRADING MODIFIED	17.28	STA.
* SUBBASE (CIP)	2814	C.Y.
AGGREGATE BASE BITUMINOUS	1711	TON
MDOT 22A SHOULDERS	321	TON
BITUMINOUS MIXTURE NO. 1100T, 20AA	436	TON
FAST DRY PAVEMENT MARKINGS, 4" YELLOW	990	L.F.
12" CORRUGATED PIPE	170	L.F.
12" CORRUGATED END SECTION RESTORATION	2	EACH
	L.S.	L.S.

* SAND SUBBASE IS NEEDED ONLY IN AREAS WHERE EXISTING SOILS ARE UNSTABLE. THE EARTH EXCAVATION AND SUBBASE QUANTITIES WILL BE ADJUSTED IF SAND SUBBASE IS NOT REQUIRED.

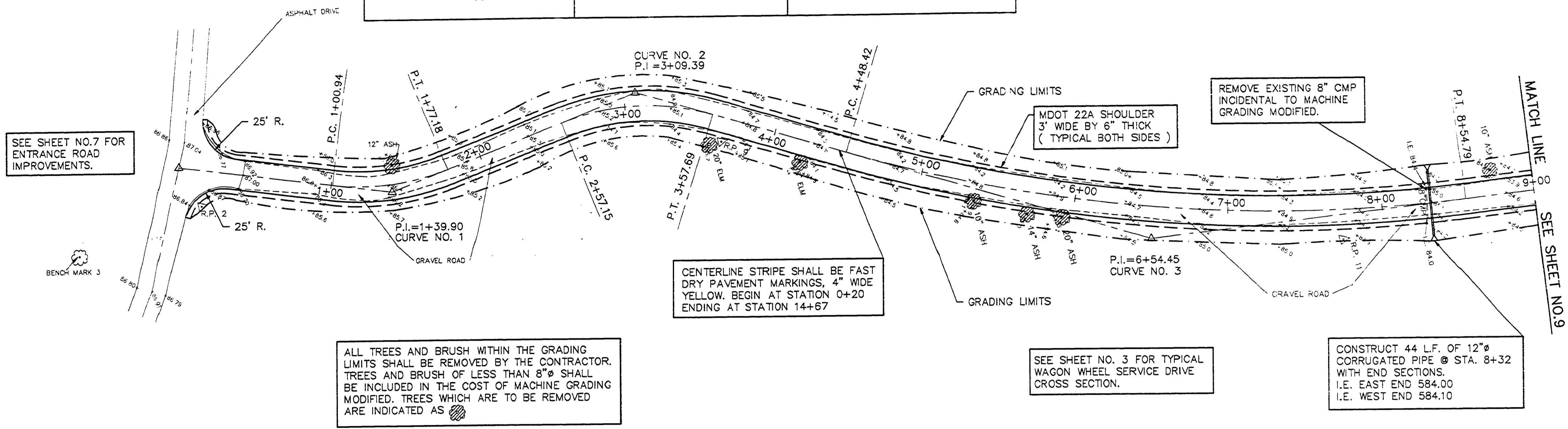

ALL TREES AND BRUSH WITHIN THE GRADING LIMITS SHALL BE REMOVED BY THE CONTRACTOR. TREES AND BRUSH OF LESS THAN 8" SHALL BE INCLUDED IN THE COST OF MACHINE GRADING MODIFIED. TREES WHICH ARE TO BE REMOVED ARE INDICATED AS

CENTERLINE STRIPE SHALL BE FAST DRY PAVEMENT MARKINGS, 4" WIDE YELLOW. BEGIN AT STATION 0+20 ENDING AT STATION 14+67

SEE SHEET NO. 3 FOR TYPICAL WAGON WHEEL SERVICE DRIVE CROSS SECTION.

CONSTRUCT 44 L.F. OF 12" CORRUGATED PIPE @ STA. 8+32 WITH END SECTIONS. I.E. EAST END 584.00 I.E. WEST END 584.10

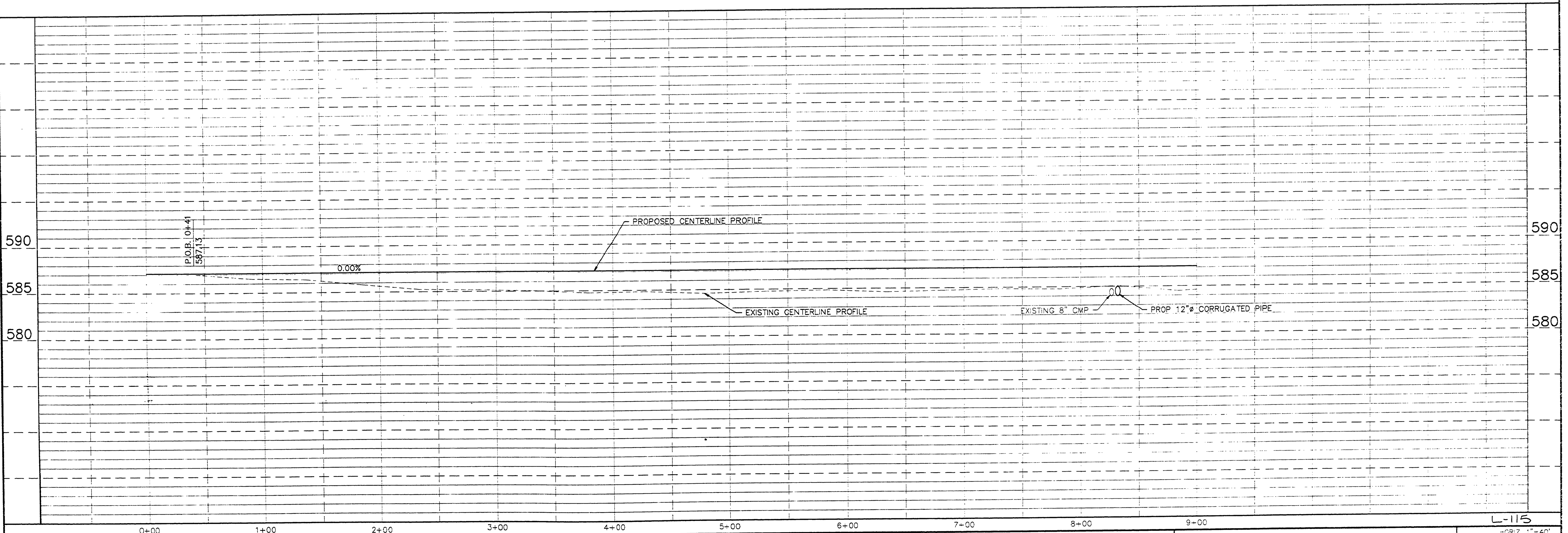

5-4-90
0103PP1