

R.P. #	COORD'S
11	N 6402.297 E 4287.115
13	N 7006.233 E 4289.753

HORIZONTAL CURVE NO. 4

Δ=14°36'52"
D=7°09'43"
R=800.00'
T=102.59'
L=204.06'
PC=9+27.33
PI=10+29.92
PT=11+31.39

HORIZONTAL CURVE NO. 5

Δ=11°41'29"
D=11°27'33"
R=500.00'
T=51.19'
L=102.03'
PC=12+44.66
PI=12+95.85
PT=13+46.68

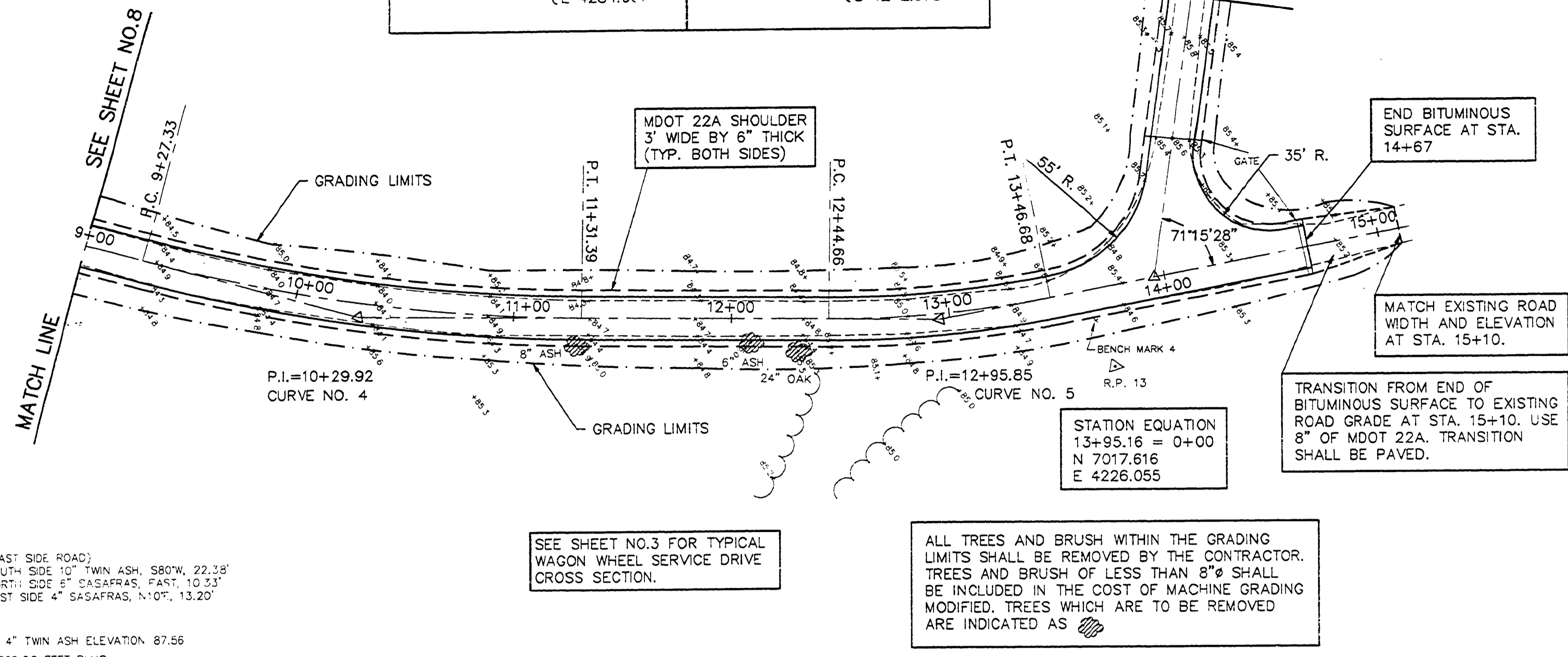

WITNESS TO R.P.

R.P. #13 (1/2" BAR EAST SIDE ROAD)
SET NAIL AND TAG SOUTH SIDE 10" TWIN ASH, S80°W, 22.35'
SET NAIL AND TAG NORTH SIDE 8" SAFAFRAS, EAST, 10.33'
SET NAIL AND TAG EAST SIDE 4" SAFAFRAS, N10°, 13.20'

BENCH MARK 4
PK NAIL IN WEST SIDE 4" TWIN ASH ELEVATION 87.56
ALL ELEVATIONS ARE 500.00 FEET PLUS

SEE SHEET NO.3 FOR TYPICAL WAGON WHEEL SERVICE DRIVE CROSS SECTION.

ALL TREES AND BRUSH WITHIN THE GRADING LIMITS SHALL BE REMOVED BY THE CONTRACTOR. TREES AND BRUSH OF LESS THAN 8"Ø SHALL BE INCLUDED IN THE COST OF MACHINE GRADING MODIFIED. TREES WHICH ARE TO BE REMOVED ARE INDICATED AS

STATION EQUATION
13+95.16 = 0+00
N 7017.616
E 4226.055

TRANSITION FROM END OF BITUMINOUS SURFACE TO EXISTING ROAD GRADE AT STA. 15+10. USE 8" OF MDOT 22A. TRANSITION SHALL BE PAVED.

MATCH EXISTING ROAD WIDTH AND ELEVATION AT STA. 15+10.

END BITUMINOUS SURFACE AT STA. 14+67

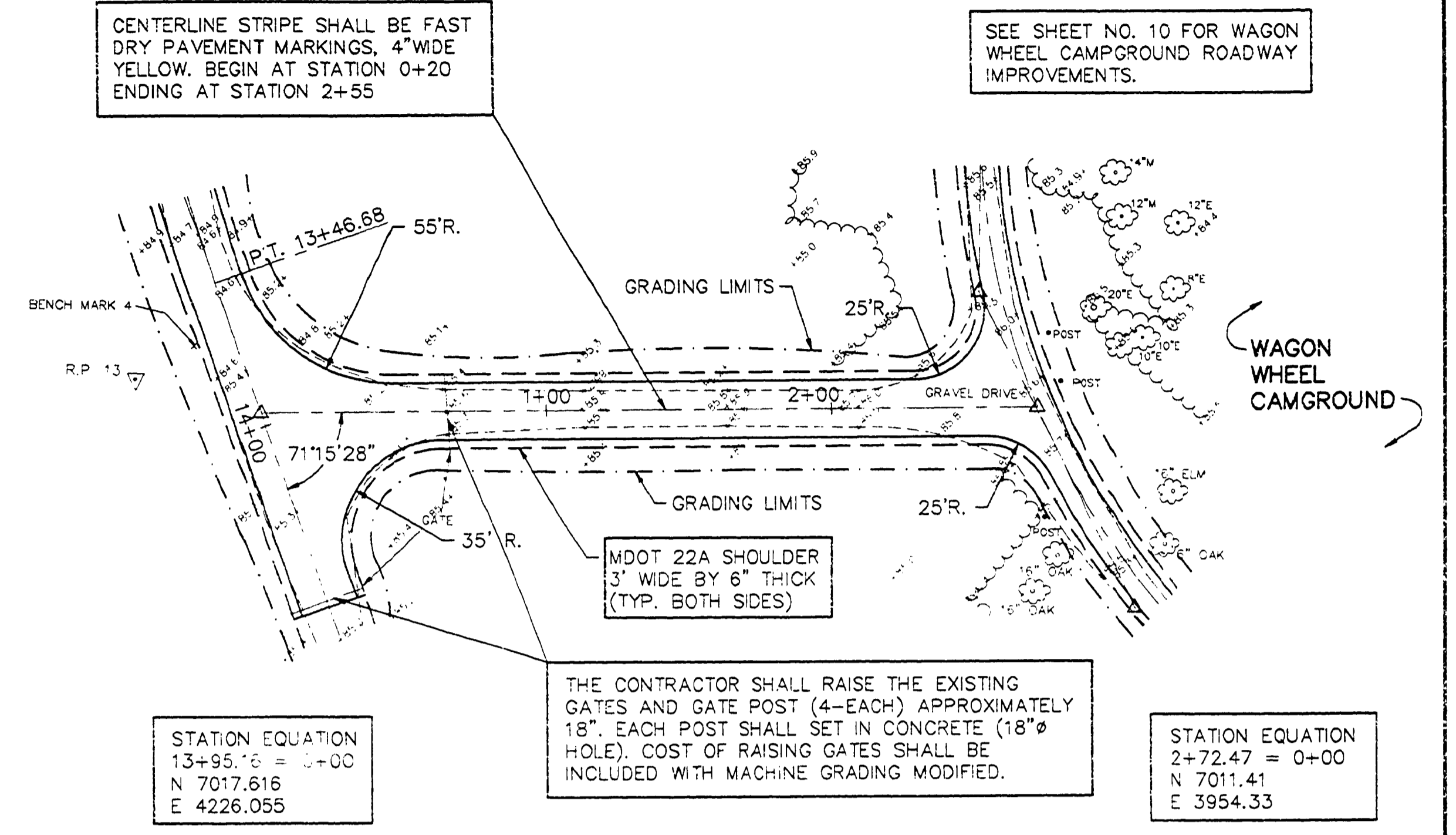

CENTERLINE STRIPE SHALL BE FAST DRY PAVEMENT MARKINGS, 4" WIDE YELLOW. BEGIN AT STATION 0+20 ENDING AT STATION 2+55

SEE SHEET NO. 10 FOR WAGON WHEEL CAMPGROUND ROADWAY IMPROVEMENTS.

STATION EQUATION
13+95.16 = 0+00
N 7017.616
E 4226.055

THE CONTRACTOR SHALL RAISE THE EXISTING GATES AND GATE POST (4-EACH) APPROXIMATELY 18". EACH POST SHALL SET IN CONCRETE (18"Ø HOLE). COST OF RAISING GATES SHALL BE INCLUDED WITH MACHINE GRADING MODIFIED.

STATION EQUATION
2+72.47 = 0+00
N 7011.41
E 3954.33

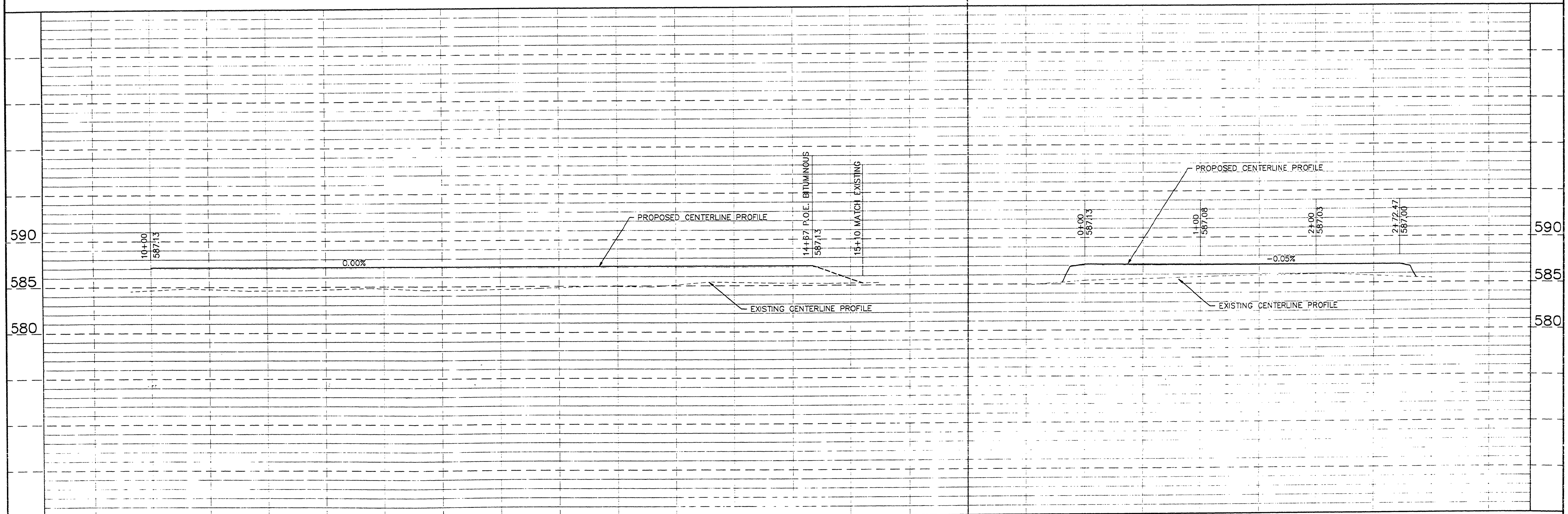

5-4-90
000372