

ST CLAIR RIVER

SOUTHEASTERN MICH. GAS CO.  
6" MAIN 4' DEEP

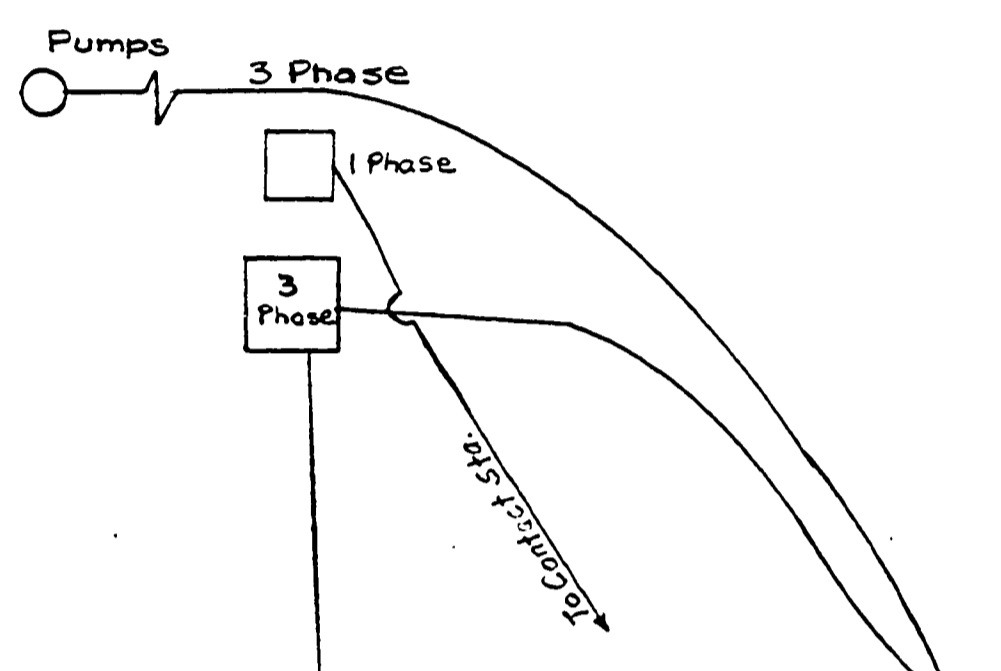
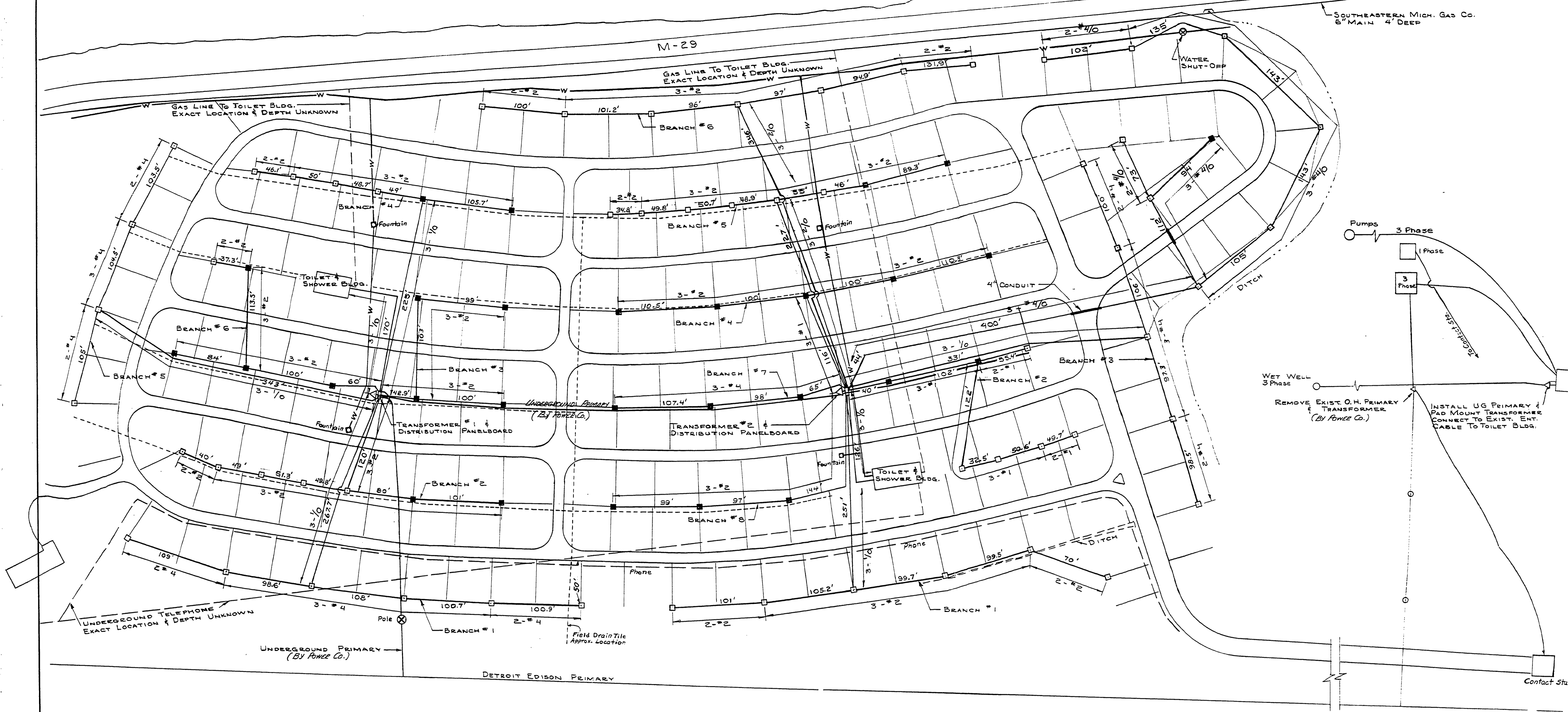

LEGEND  
 □ 2 SITE BOX  
 ■ 4 SITE BOX

**CONSTRUCTION NOTES**  
 ALL CONDUCTORS WILL BE ALUMINUM. GROUND WILL BE #6 BARE STRANDED COPPER WIRE THROUGHOUT ENTIRE SYSTEM, EXCEPT TO TOILET BLDG.  
 PLACE CONCRETE MARKERS (4" DIA. X 24" LONG) MARKED WITH AN "E" AT ALL UNMARKED CHANGES IN ALIGNMENT.  
 ALL UNDERGROUND PRIMARY WILL HAVE 36" MIN. BURY. ALL UNDERGROUND SECONDARY WILL HAVE 30" MIN. BURY. THE SAME TRENCH MAY BE USED WHERE PRIMARY & SECONDARY LINES RUN PARALLEL BY MAINTAINING A 6" VERTICAL SEPARATION.  
 THE TRANSFORMERS WILL BE SUPPLIED & INSTALLED BY THE DETROIT EDISON CO. THE CONDUIT WITH LONG SWEEP ELBOWS & TRANSFORMER PAD WILL BE FURNISHED & INSTALLED UNDER THIS CONTRACT. CONSTRUCTION DETAILS WILL HAVE TO BE OBTAINED FROM POWER CO BEFORE INSTALLATION.

PROVIDE WEATHERPROOF ENTRANCE JUNCTION RACK, COMPLETE WITH METEER SOCKET & CIRCUIT BREAKER. DISTRIBUTION PANELBOARD TO SERVE AS MAIN DISCONNECT. RACK TO BE INSTALLED ADJACENT TO PAD MOUNTED TRANS.  
 INSTALL CIRCUIT BREAKERS IN PANELBOARD FOR RESPECTIVE LINES DESIGNATED ON PLAN AS FOLLOWS:  
 TRANSFORMER #1 TRANSFORMER #2  
 MAIN BREAKER 350 AMP MAIN BREAKER 800 AMP  
 BRANCH #1 60 AMP BRANCH #1 60 AMP  
 BRANCH #2 90 AMP BRANCH #2 90 AMP  
 " #3 90 AMP " #3 50A  
 " #4 70 A " #4 50A  
 " #5 50 A " #5 50A  
 " #6 30 A " #6 70A  
 T & S BLDG 100 AMP " #7 60A  
 " " #8 60A  
 T & S BLDG. NEW BRANCH 150A

BUILDING COMMITTEE APPROVAL	
BY: _____	DATE: _____
RECOMMENDED FOR APPROVAL: _____ ENGINEER OR ARCHITECTURAL SUPERVISOR DATE	
RECOMMENDED FOR APPROVAL: _____ PROGRAM AND PLAN COORDINATOR DATE	
DIVISION/REGION APPROVAL	
BY: _____	DATE: _____
DIVISION CHIEF/REGIONAL MANAGER ENGINEERING DIVISION	
APPROVED: _____	DATE: _____

SURVEYED BY	DRAWN BY J. YMA	G-74	NO. DATE BY REVISIONS	NO. DATE BY REVISIONS	MICHIGAN DEPARTMENT OF NATURAL RESOURCES	UNDERGROUND ELECTRICAL DISTRIBUTION SYSTEM	ALGONAC STATE PARK AREA OR PARK PROJECT
DESIGNED BY R. H. MERRILL	CHECKED BY	DATE	1. 11-1-74 J.Y. REV. TO 1971 N.E.C.	3. 11-89 J.Y. CO. EXPANSION ADDED. AS BUILT		SHEET TITLE	
			2. 9-27-76 J.E. As Built	4.			SHEET 2 OF 3 PLAN NO. U-1