

ST. CLAIR RIVER

M-29

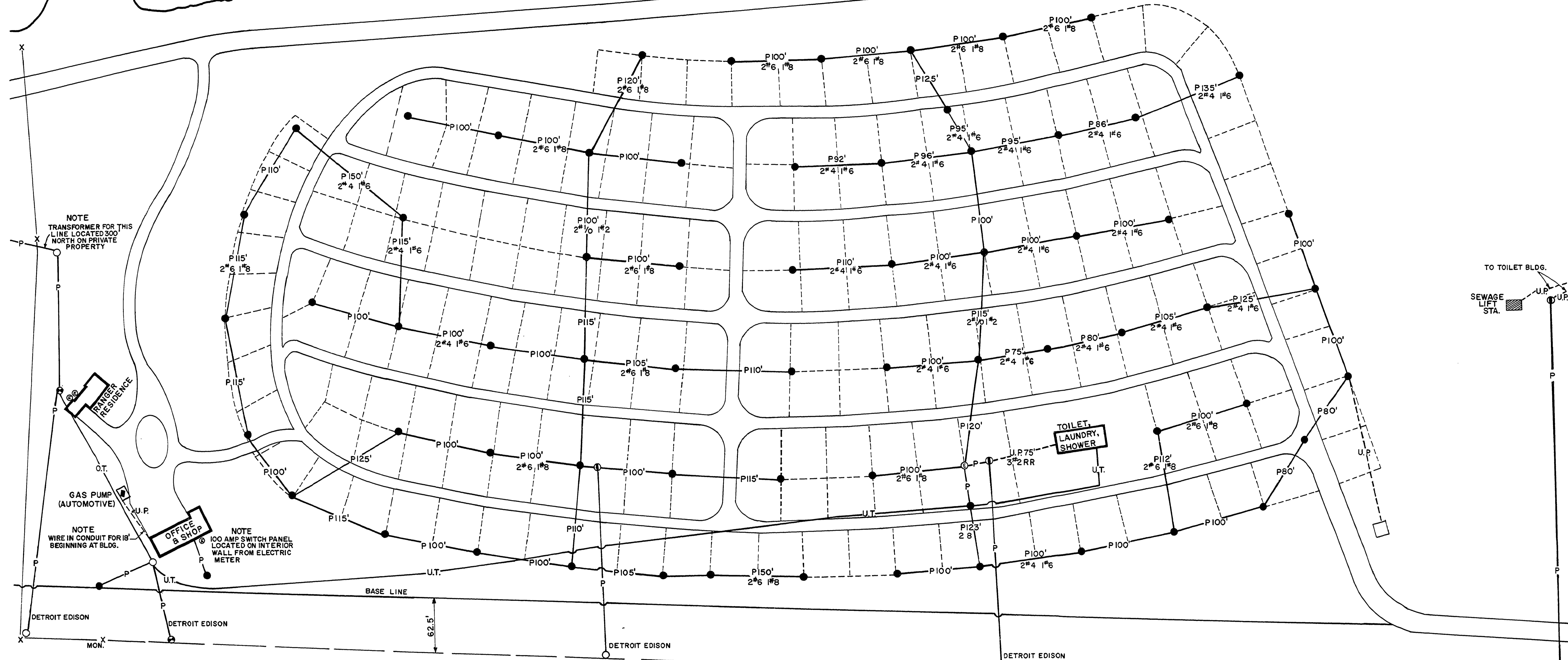

NOTE
TRANSFORMER FOR THIS
LINE LOCATED 300'
NORTH ON PRIVATE
PROPERTY

TRANSFORMER
RESIDENCE

GAS PUMP
(AUTOMOTIVE)

NOTE
WIRE IN CONDUIT FOR IS
BEGINNING AT BLDG.

OFFICE
& SHOP

NOTE
100 AMP SWITCH PANEL
LOCATED ON INTERIOR
WALL FROM ELECTRIC
METER

TOILET,
LAUNDRY,
SHOWER

TO TOILET BLDG.
SEWAGE
LIFT
STA.

- LEGEND**
- P POWER LINE
 - U.P. UNDERGROUND POWER LINE
 - O UTILITY POLE
 - OUTLET BOX
 - ⊙ UTILITY POLE & TRANSFORMER
 - ⊙ UTILITY POLE, METER & TRANSFORMER
 - ⊙ ELECTRIC METER
 - U.T. UNDERGROUND TELEPHONE LINE
 - O.T. OVERHEAD TELEPHONE LINE

OBSELETE
SEE V-1 AS BUILT DATED 11/89

SURVEYED BY	DRAWN BY G.H. CRAY	7-9-65	NO. DATE BY	REVISIONS	NO. DATE BY	REVISIONS	MICHIGAN DEPARTMENT OF NATURAL RESOURCES	POWER, TELEPHONE SHEET TITLE	AREA OR PARK ALGONAC STATE PARK	PROJECT NO.
DESIGNED BY	CHECKED BY	1. 12-12-67	3.		4.				PROJECT	SHEET 2 OF 3 PLAN NO. U-1
DATE	DATE	2.								