

WITNESSES PT. 0+00 SURVEY LINE 3/4" PIPE & CAP
 N 47° W, 15.05', PK. NAIL IN 30' SIDE 18" DSH.
 N 39° E, 48.44', PK. NAIL IN 12" ASH.
 S 80° E, 9.8', 15M WETWELL.

B.M. "A" ELEV. 584.16
 E.R. SPIKE IN W. SIDE OF 12" BLACK CDR.
 B.M. WETWELL ELEV. 584.14
 CURSELED N.E. COR. STEEL FRAME
 FOR WETWELL COVER 10 FT. STA. 0+00

SOIL BORING
 STA. 6+20 SURVEY LINE
 0.0-1.0' MUCK LOAM
 1.0-3.0' SAND SILTY CLAY LOAM
 3.0-5.0' COARSE SAND SILT
 W/TRACE CLAY
 WATER TABLE 3.0'

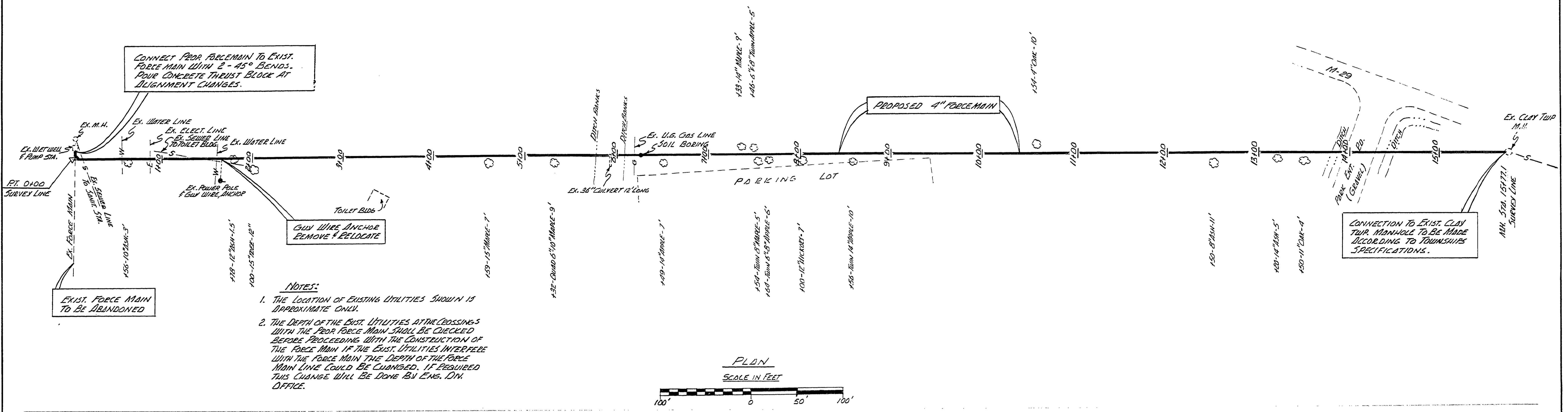

- NOTES:**
1. THE LOCATION OF EXISTING UTILITIES SHOWN IS APPROXIMATE ONLY.
 2. THE DEPTH OF THE EXIST. UTILITIES AT THE CROSSINGS WITH THE PROP. FORCE MAIN SHALL BE CHECKED BEFORE PROCEEDING WITH THE CONSTRUCTION OF THE FORCE MAIN IF THE EXIST. UTILITIES INTERFERE WITH THE FORCE MAIN THE DEPTH OF THE FORCE MAIN LINE COULD BE CHANGED. IF REQUIRED THIS CHANGE WILL BE DONE BY ENG. D.N. OFFICE.

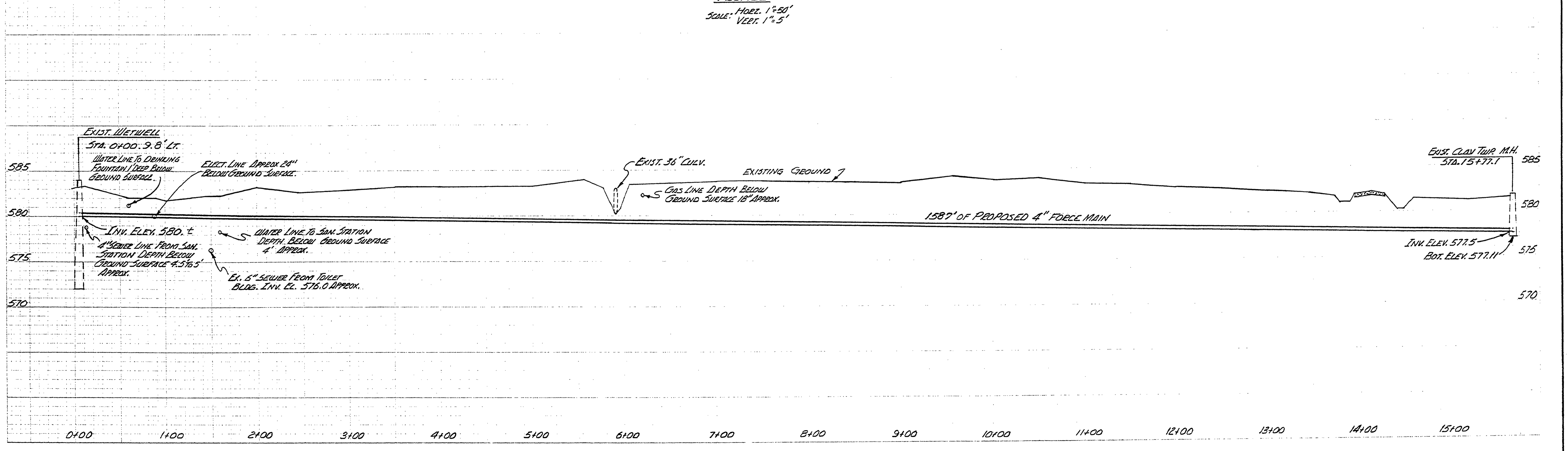
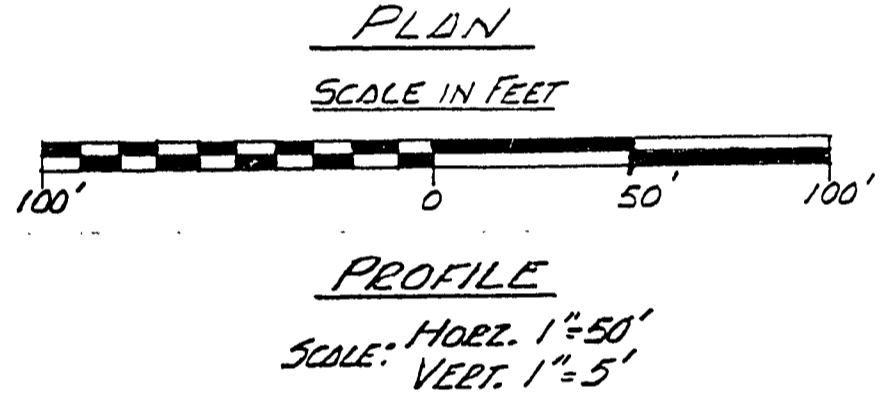

SURVEYED BY	L. THOMPSON	3-78	DRAWN BY	J. LEMMON	5-78	NO.	DATE	BY	REVISIONS	NO.	DATE	BY	REVISIONS	MICHIGAN DEPARTMENT OF NATURAL RESOURCES	MUNICIPAL SEWER CONNECTION PLAN & PROFILE	SHEET NO. _____ OF _____ FOR PROJECT NO. 24-1965	ALGONAC STATE PARK SHEET 2 OF 4 PLAN NO. E-116
DESIGNED BY	A. BURRISHI	4-78	CHECKED BY			1.				3.							
						2.				4.							