

2' x 2' x 4" TYPICAL

1	2	1	2	1	2	1	2	1	2
2	1	2	1	2	1	2	1	2	1
1	2	1	2	1	2	1	2	1	2
2	1	2	1	2	1	2	1	2	1
1	2	1	2	1	2	1	2	1	2
2	1	2	1	2	1	2	1	2	1

PRECAST OR CAST IN PLACE CONCRETE BLOCKS SHALL BE INSTALLED IN A CHECKER BOARD PATTERN AS INDICATED

PLAN OF SLOPE PAVING, CONCRETE

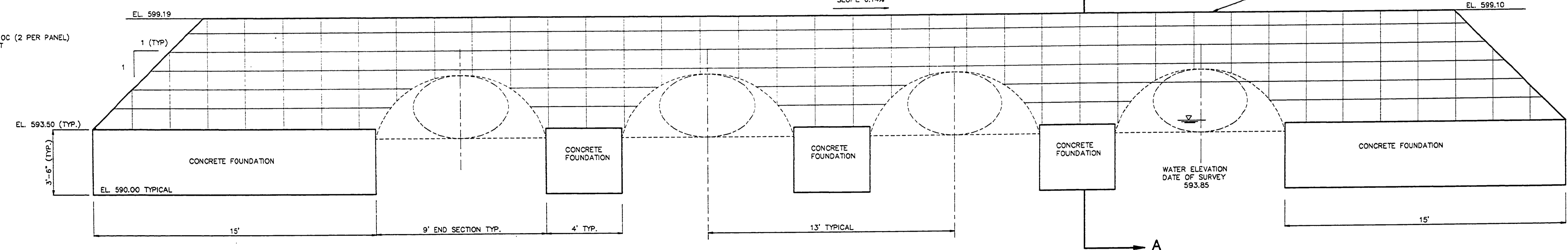
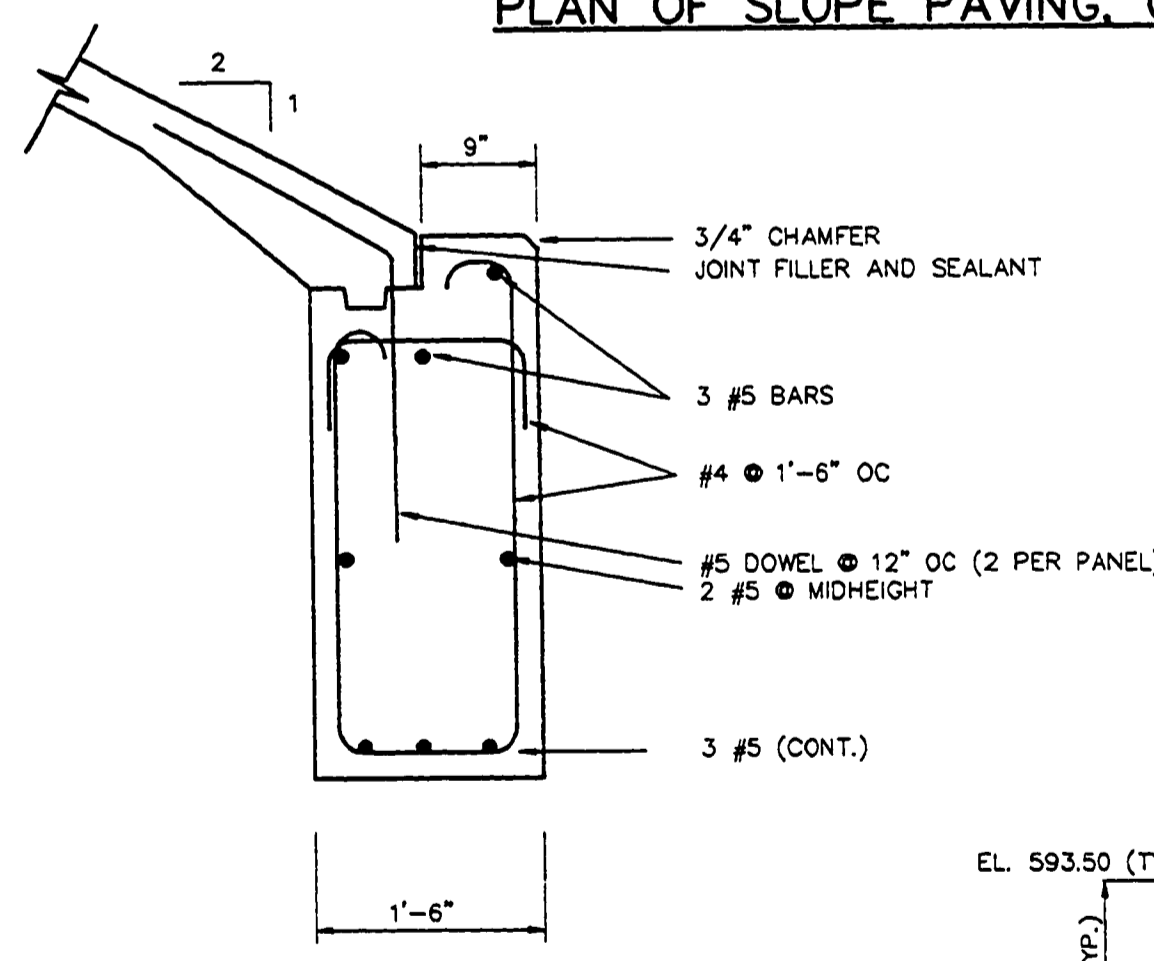
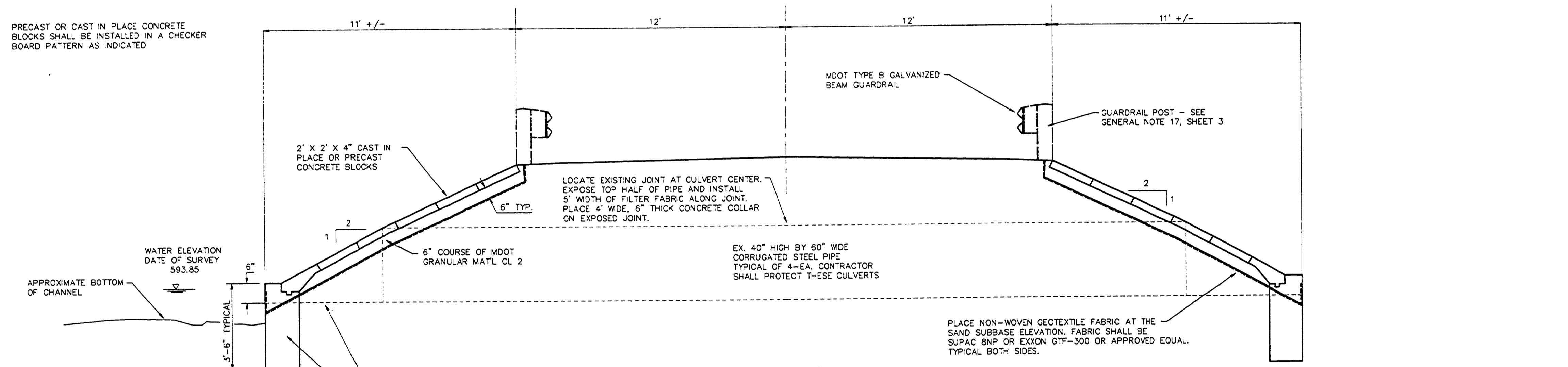

FILE NO.: 11655102
PLOT DATE: 7-13-93
UPDATED BY: GJF

DRN BY:	DAF	IDENTIFICATION NO.	PROJECT - ALOHA	ISSUED FOR	PRELIMINARY	DATE	7-06-92
DES. BY:	GJF	STATE ACCOUNT	607-75-2450-400	CONSTRUCTION	<input checked="" type="checkbox"/>	7-14-93	
APP'D BY:	GDA			FINAL RECORD	<input type="checkbox"/>		

Capital Consultants, Inc. ENGINEERS
602 N. WASHINGTON AVE., LANSING, MICHIGAN 48206 TELEPHONE 91-721-1100

STATE OF MICHIGAN DEPARTMENT OF MANAGEMENT AND BUDGET
Office of Facilities

QUALITY OF LIFE RECREATION BOND
MICHIGAN DEPARTMENT OF NATURAL RESOURCES
PARKS DIVISION - STATE ACCT. NO. 607-75-2450-400

ALOHA STATE PARK
DETAILS

SCALE: AS SHOWN
PROJ. NO.: 91165
SHEET 4 OF 17

L-118