

28 33  
29 32

**COMMISSION APPROVED BOUNDARY**

**PROPOSED BOUNDARY**

**SECTION CORNER**

**EXISTING CONTOUR LINE**

**EXISTING CREEK**

**EXISTING PUBLIC ROAD**

**EXISTING PARK ROAD**

**EXISTING BUILDING**

**EXISTING FOOT TRAIL**

**LEGEND**

SHOOTING RANGE - APPROXIMATELY 250 L.F. OF DRIVE NEAR THE CULVERT SHALL BE REMOVED AND REPLACED WITH ADEQUATE BASE COURSE PREPARED POSSIBLY UNDER THE CULVERT IF NEEDED. THE ENTIRE ROAD AND PARKING LOT WILL REQUIRE 175#/CY BITUMINOUS MATERIAL. A FLUSH CURB SHALL BE INSTALLED AT THE ROAD EDGE TO SEPARATE THE GRAVEL ON KEEN ROAD AND THE BITUMINOUS DRIVE INTO THE SHOOTING RANGE. WHEN SURFACING IS COMPLETED, THE PARKING LOTS AND ROAD SHALL RECEIVE PAVEMENT MARKINGS.

THE EXISTING SEWAGE LAGOONS SHALL BE PROPERLY ABANDONED AND ANY CONTAMINATED MATERIAL SHALL BE DISPOSED OF IN AN APPROVED MANNER. REESTABLISHMENT OF THE AREA MAY REQUIRE SOIL GRADING AND FILL AND WILL REQUIRE TOPSOIL AND SEEDING.

CONSULTANT TO COORDINATE AND DESIGN ALL ASPECTS OF THE CONNECTION OF THE EXISTING SANITARY SYSTEM TO THE TOWNSHIP INTERCEPTOR PRESENTLY LOCATED ON GREENSHIELD ROAD. CONSULTANT WILL BE RESPONSIBLE FOR SECURING ANY NECESSARY PERMITS.

TROUT LAKE BEACH REDEVELOPMENT - THE EXISTING SAND BEACH SHOULD RECEIVE APPROX. 925 CY OF CLEAN SAND. THE SAND FILL CONSISTS OF AN AREA OF APPROX. 600' X 25' X 4' DEPTH. A MINIMUM AREA AROUND THE SWIMMING BEACH SHOULD BE PREPARED TO CONTROL WEED GROWTH.

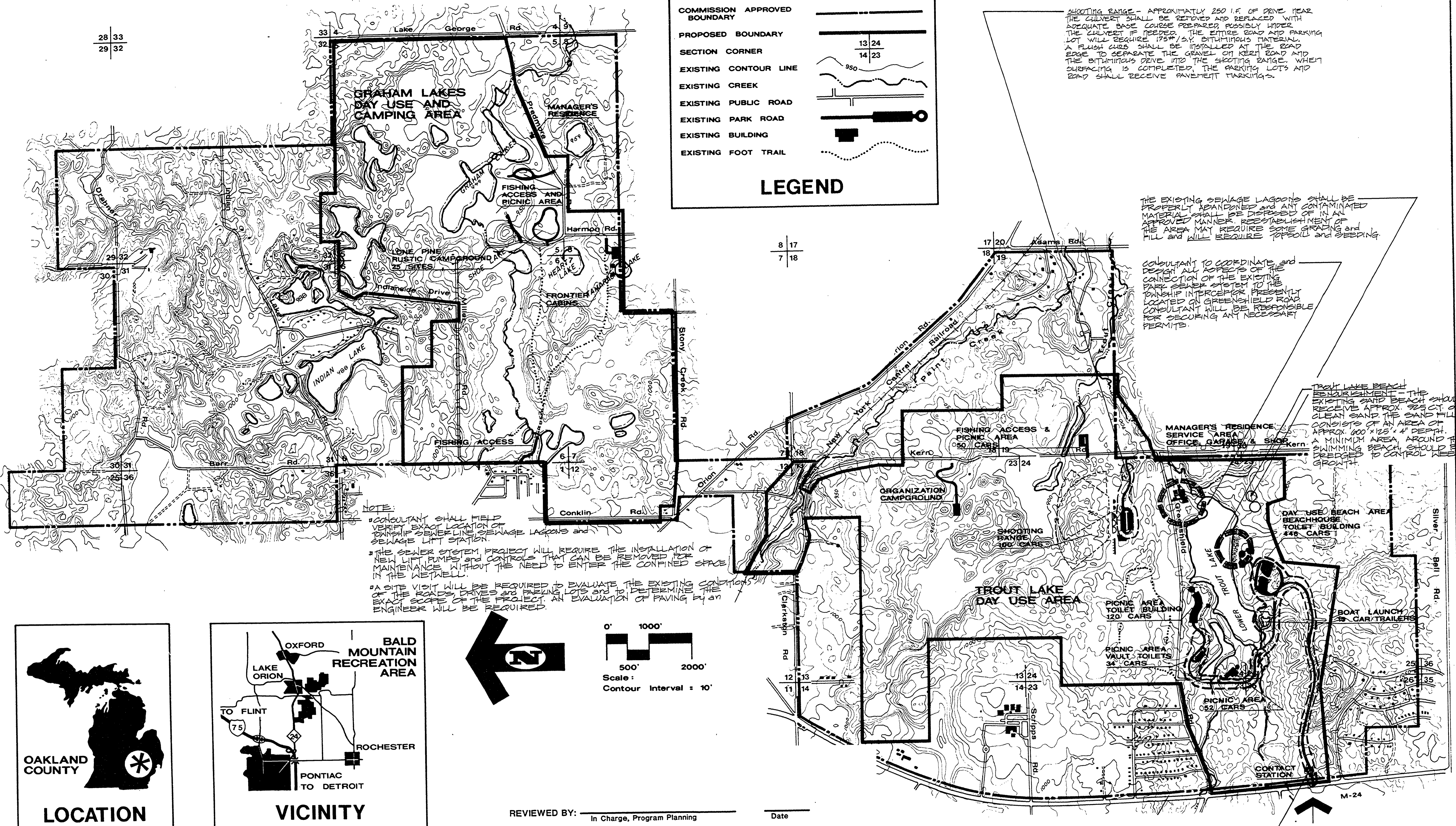

**NOTE:**

- CONSULTANT SHALL FIELD VERIFY EXACT LOCATION OF TOWNSHIP SEWERLINE, SEWAGE LAGOONS AND SEWAGE LIFT STATION.
- THE SEWER SYSTEM PROJECT WILL REQUIRE THE INSTALLATION OF NEW LIFT PUMPS AND CONTROLS THAT CAN BE REMOVED FOR MAINTENANCE WITHOUT THE NEED TO ENTER THE CONFINED SPACE IN THE WESTWELL.
- A SITE VISIT WILL BE REQUIRED TO EVALUATE THE EXISTING CONDITIONS OF THE ROADS, DRIVES AND PARKING LOTS AND TO DETERMINE THE EXACT SCOPE OF THE PROJECT. AN EVALUATION OF PAVING BY AN ENGINEER WILL BE REQUIRED.

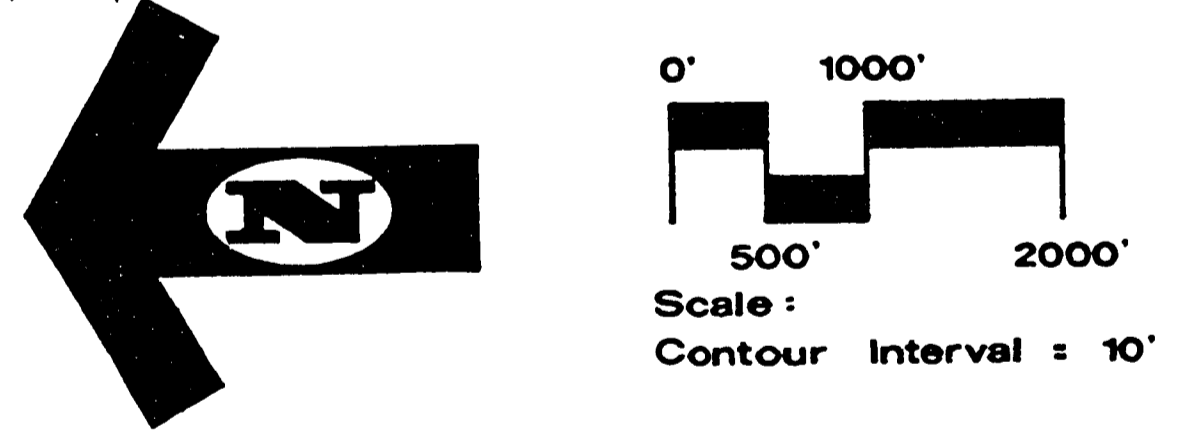
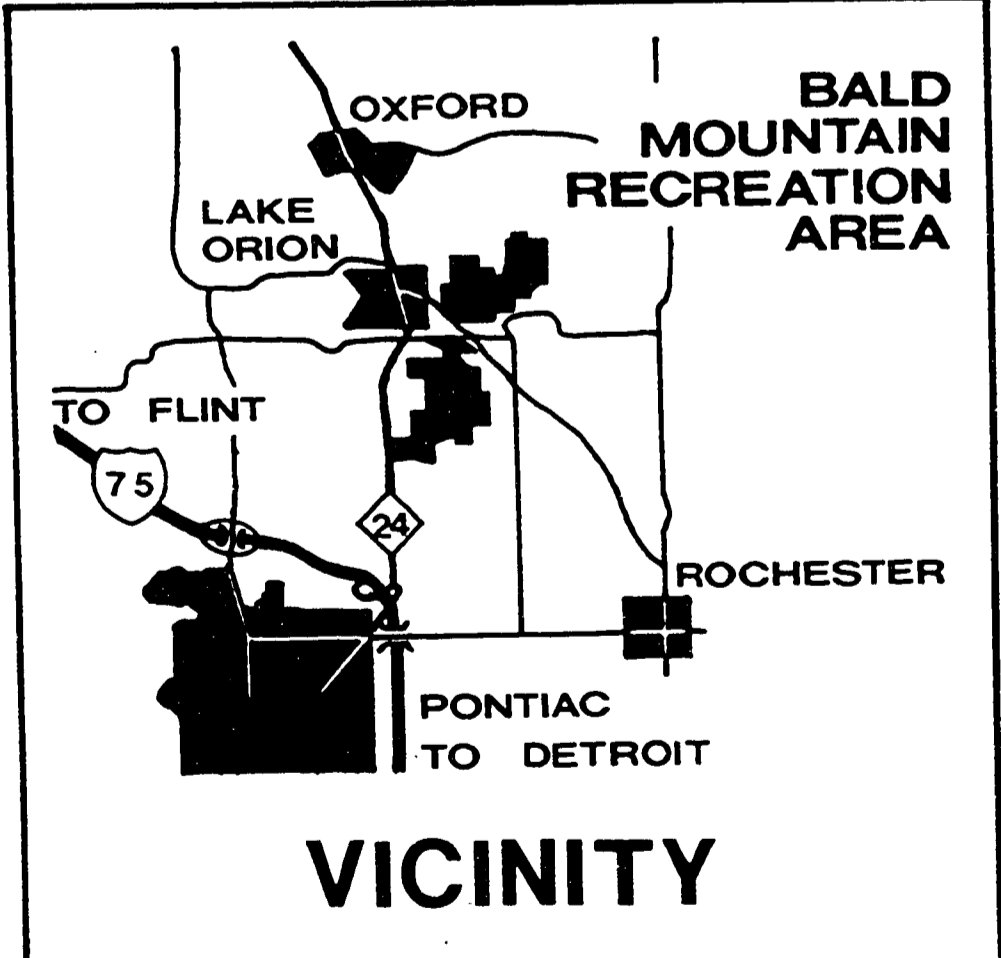

REVIEWED BY: \_\_\_\_\_ In Charge, Program Planning Date \_\_\_\_\_

APPROVED BY: Hans Neuberg Chief, Parks Division 8.29.90 Date

SEE SHEETS 2-5 FOR MORE DETAILED INFORMATION ON BITUMINOUS SURFACING. WORK TO BE DONE ALONG ENTRY, DAY USE BEACH PARKING AREA, BOAT LAUNCH AND SHOOTING RANGE.

SURVEYED BY		DRAWN BY P. PETERSEN		NO. DATE BY		REVISIONS		NO. DATE BY		REVISIONS		MICHIGAN DEPARTMENT OF NATURAL RESOURCES		BOND PROJECT RENOVATIONS SITE PLAN		BALD MOUNTAIN RECREATION AREA OR PARK		PROJECT NO.	
DESIGNED BY		CHECKED BY		NO. DATE BY		REVISIONS		NO. DATE BY		REVISIONS		MICHIGAN DEPARTMENT OF NATURAL RESOURCES		BOND PROJECT RENOVATIONS SITE PLAN		PROTECTING MICHIGAN'S FUTURE PROJECT		SHEET 1 OF 5 PLAN NO. L-121	