

CURVE #15
 T.O. = 104+12.57
 P.T. = 108+25.39
 P.C. = 104+33.29
 P.T. = 104+12.57
 SUPER. .04'/FT.
 ROTATION R.T. E.M.

CURVE #17
 T.O. = 116+30.69
 P.T. = 117+18.00
 P.C. = 116+30.69
 P.T. = 117+18.00
 SUPER. .04'/FT.
 ROTATION R.T. E.M.

BM 36 ELEV. 951.27
 PK. NUT # TAG IN W. ROOT OF
 32" OAK, S. SIDE GREENSHIELD RD.
 BM 50 ELEV. 953.60
 RR SPIKE IN W. SIDE OF 28" CHERY,
 S. SIDE STA. 119+95

WITNESSES
 P# 15 106+71.88 "T" IRON
 SPIKE 4" CHERRY S 80° E 9.92'
 SPIKE 5" OAK S 17° W 42.20'
 P# 16 111+66.52 "T" IRON
 SPIKE 4" POPLAR S 72° W 70.19'
 SPIKE 5" POPLAR S 18° W 90.81'
 P# 17 116+30.69 "T" IRON
 SPIKE 12" APPLE S 30° W 33.86'
 SPIKE 8" APPLE N 48° W 27.67'
 DOE 119+70.78 "T" IRON
 SPIKE 15" ELM S 37° E 18.27'
 SPIKE 5" POPLAR N 88° W 36.76'

CURVE #16
 T.O. = 113+19.70
 P.T. = 114+00.00
 P.C. = 113+19.70
 P.T. = 114+00.00
 SUPER. .04'/FT.
 ROTATION L.T. E.M.

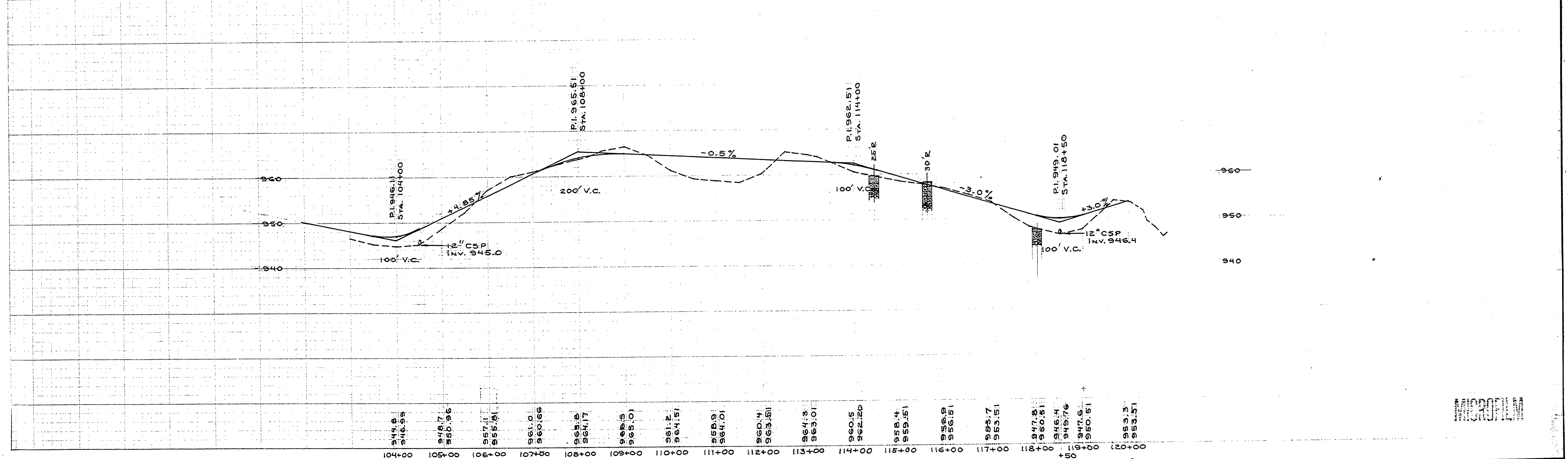

SURVEYED BY	DRAWN BY J. YMA	MAR. 75	NO.	DATE	BY	REVISIONS	NO.	DATE	BY	REVISIONS	MICHIGAN DEPARTMENT OF NATURAL RESOURCES	ENTRANCE ROAD STA. 104+00 TO STA. 120+00	SHEET NO. 4 OF 4	BALD MOUNTAIN RECREATION AREA
DESIGNED BY R. H. MERRILL	CHECKED BY	MAR. 75	1.	4-13-76	J.Y.	H.C. PARKING ADDED	3.						FOR PROJECT NO. 24-1173 Day Use Expansion	SHEET 4 OF 4 PLAN NO. E-105
			2.				4.							

MICROFILM