

SURVEY & REMONUMENTATION

APR 29 1996

COMMISSION

Allegan County Remonumentation LAND CORNER RECORDATION CERTIFICATE

Filing Requirement of Act 74, Mich. P.A. 1970

For corners in

Allegan
(County)

Located in:

Corner Code #

1. Public Land Survey

T R
T R
T R
T R

M 12-13

Wayland Twp.

(Sec. #2)

2. Property Controlling
in Section

S T R
S 36 T 3N R 11W

Wayland Twp.

3. Miscellaneous
Property in Sec.

S T R
S T R

4. Lot No. , Recorded Plat

5. Private Claims

I, John C. Bueche, in a field survey on September 20, 1995, do hereby certify that under requirements of P.A. 74, Michigan P.A. of 1970, the corner points mentioned in lines 1 and 2 above were in conformance with regulations and rules theretofore as required in the current manual of survey instructions of the United States Department of the Interior, Bureau of Land Management or by a decree of a Court of Law and/or that the corner points mentioned in lines 3, 4 and 5 above were in conformance with the rules of the Michigan Board of Land Surveyors or by a Decree of a Court of Law; established, re-established, monumented, re-monumented, recovered, found as expressed below:

NOTE: Not more than 4 corners, all in the same town and range, may be recorded on this certificate.

A. Description of original monument and accessories and/or subsequent restoration:

APPROVED REMONUMENTATION CORNER

P.A. 345 OF 1990

ALLEGAN COUNTY

DATE APPROVED 8-14-95

COUNTY REC. John C. Bueche

B. Description of corner evidence found and/or method applied in restoring or reestablishing corner:

Set Allegan Co. Mon. on East line of Gilger Park, record L5, P100. Allegan Co. as per recorded survey L001, P543 by Ratekin & Assoc., 1978.

Cor. is 390.00' South of E 1/4 cor., Sec. 36, 3-11

This position not established by original government surveyors. This monument is accepted as the best available evidence of the position of the corner...

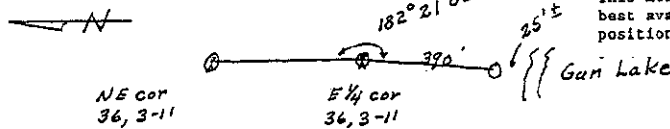

C. Description of monument for corner and accessories established to perpetuate locating the position of the corner:

Set Allegan Co. Mon. 3/4" x 24" pin with Cap

South edge of conc. sea wall, South 24.50'

SE cor. fnd. to sun porch S. ent. to hse. #13019 S 80 W 43.75'

NE cor. fnd. to hse. #13019 @ Annex N 30 E 27.85'

NW cor. brick hse. #3735 N 15 E 74.70'

SW cor. brick hse. #3735 N 30 E 65.28'



Signed by

John C. Bueche
Surveyor's Michigan License No. 13027

Date

Oct 2, 1995

FORM APPROVED BY MICHIGAN STATE BOARD OF LAND SURVEYORS, JAN. 28, 1971
REVISED MAY 14, 1978
REVISED JAN. 1982

USE 0005 PAGE 328