

SURVEY & REMONUMENTATION

Allegan County Remonumentation
LAND CORNER RECORDATION CERTIFICATE
Filing Requirement of Act 74, Mich. P.A. 1970

APR 29 1996
COMMISSION

For corners in
Allegan
(County)

Located In: Corner Code #

1. Public Land Survey	T	R	M 12-13
	T	R	Wayland Twp.
	T	R	(Sec. #2)
	T	R	
2. Property Controlling in Section	S	T	R
	S 36	T 3N	R 11W
			Wayland Twp.
3. Miscellaneous Property in Sec.	S	T	R
	S	T	R

4. Lot No. _____, Recorded Plat _____

5. Private Claims _____

FILED
1995 DEC 29 PM 4:05
Register of Deeds Stamp & File Number

I, John C. Bueche, in a field survey on September 20, 1995, do hereby certify that under requirements of P.A. 74, Michigan P.A. of 1970, the corner points mentioned in lines 1 and 2 above were in conformance with regulations and rules therefore as required in the current manual of survey instructions of the United States Department of the Interior, Bureau of Land Management or by a decree of a Court of Law and/or that the corner points mentioned in lines 3, 4 and 5 above were in conformance with the rules of the Michigan Board of Land Surveyors or by a Decree of a Court of Law; established, re-established, monumented, re-monumented, recovered, found as expressed below.

NOTE: Not more than 4 corners, all in the same town and range, may be recorded on this certificate.

A. Description of original monument and accessories and/or subsequent restoration:

APPROVED REMONUMENTATION CORNER
P.A. 245 OF 1990
ALLEGAN COUNTY
DATE APPROVED 8-14-95
COUNTY REP. John C. Bueche

B. Description of corner evidence found and/or method applied in restoring or reestablishing corner:

Set Allegan Co. Mon. on East line of Gilger Park, record L5, P100.
Allegan Co. as per recorded survey L001, P543 by Ratekin & Assoc., 1978.

Cor. is 390.00' South of E 1/4 cor., Sec. 36, 3-11

This position not established by original government surveyors. This monument is accepted as the best available evidence of the position of the corner.

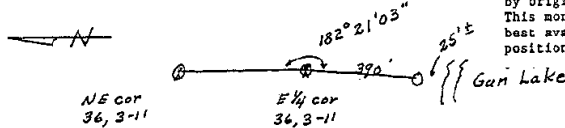

C. Description of monument for corner and accessories established to perpetuate locating the position of the corner:

Set Allegan Co. Mon. 3/4" x 24" pin with Cap
South edge of conc. sea wall, South 24.50'
SE cor. fnd. to sun porch S. ent. to hse. #13019 S 80 W 43.75'
NE cor. fnd. to hse. #13019 @ Annex N 30 E 27.85'
NW cor. brick hse. #3735 N 15 E 74.70'
SW cor. brick hse. #3735 N 30 E 65.28'



Signed by John C. Bueche
Surveyor's Michigan License No. 13027

Date Oct 2, 1995

FILE # 0005 PAGE 328

FORM APPROVED BY MICHIGAN STATE BOARD OF LAND SURVEYORS, JAN. 26, 1971
REVISED MAY 14, 1976
REVISED JAN., 1983