

LAND CORNER RECORDATION CERTIFICATE
Filing Requirement of Act 74, Mich. P.A. 1970

For corners in

Allegan

(County)

Located In:

Corner Code ~~##~~

1. Public Land Survey

4N 11W

M-2(E 1/4, 1)

Leighton Twp.

2. Property Controlling
in Section

S T R

3. Miscellaneous
Property in Sec.

S T R

4. Lot No. , Recorded Plat

5. Private Claims

Register of Deeds Stamp & File Number

SURVEY &
REMONUMENTATION

APR 29 1996

COMMISSION

Steven Koerber

August 31

95

I, Steven Koerber, in a field survey on August 31, 1995, do hereby certify that under requirements of P.A. 74, Michigan P.A. of 1970, the corner points mentioned in lines 1 and 2 above were in conformance with regulations and rules therefore as required in the current manual of survey instructions of the United States Department of the Interior, Bureau of Land Management or by a decree of a Court of Law and/or that the corner points mentioned in lines 3, 4 and 5 above were in conformance with the rules of the Michigan Board of Land Surveyors or by a Decree of a Court of Law, established, re-established, monumented, re-monumented, recovered, found as expressed below.

NOTE: Not more than 4 corners, all in the same town and range, may be recorded on this certificate.

A. Description of original monument and accessories and/or subsequent restoration:

M-2 GLO Lucius Lyons,
DS. 1826
Beech 18 S40½E 18
Beech 9 N38W 45

1. Barry Co. Rd. Comm.

no date
Stone & Iron
Cor. iron fnc. post E. 24.2'
36" Elm W. 22.9'
Fnc. line E & W
Power pole E. 34.1' Date 4-27-72
Fnc. post S50°E 46.3' Date 4-27-72

(Additional info. on back of sheet)

2. May 10, 1974

LCRC #176 (Barry Co.)
James King
Found 1/2" iron with cap
Corner iron post East 24.2'
Fence line E&W
Approx. C/L of N-S road
PK nail in rail road tie fence
corner S45°E 46.31'

B. Description of corner evidence found and/or method applied in restoring or reestablishing corner:

M-2 Found Capped rerod

Found SE cor. Hse. fndn. N40°W 116.84'
Found Nail & cap in S. side P. pole East 34.62'
Found Exxel capped rerod East 32.98'
Found P.K. Nail in face 6"x6" wood post S40°E 46.28'
Found Nail in S. side 24" Hickory (prev. called Ash tree) West 114.47'

And is accepted as a careful and faithful perpetuation of the position of the original corner.
Peer Group approval August 14, 1995

APPROVED REMONUMENTATION CORNER
P.A. 345 OF 1990
ALLEGAN COUNTY
DATE APPROVED 8-14-95
COUNTY REP. Robert L. Van Dine

C. Description of monument for corner and accessories established to perpetuate locating the position of the corner:

M-2 Replaced rerod with Standard Allegan Co. Mon. (3/4" x 24" Iron Rod with cap)

Set PK nail & Allegan Co. Remon. Tag in N. side P. Pole N 90° E 34.56'
Set PK nail & Allegan Co. Remon. Tag in NE side 4" x 4" wood RR tie post S 40° E 46.68'
SE cor. Hse. fndn. N 40° W 116.84'
Exxel capped rerod N 90° E 32.98'
Nail in S. side 24" Hickory (prev. called Ash tree) N 90° W 114.47'

M-2 corner is a common corner with A-2, Thornapple Township, Barry County.

Signed by Steven C. Koerber

Date 11-13-1995

Surveyor's Michigan License No. 39085

0005 PAGE 233

Page 1 of 2

FORM APPROVED BY MICHIGAN STATE BOARD OF LAND SURVEYORS, JAN. 24, 1979
REVISED MAY 12, 1981
MICHIGAN PROFESSIONAL SURVEYOR

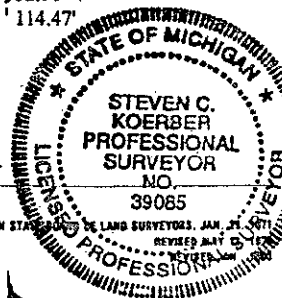

3. April 30, 1976
LCRC, L.3 PG.100. by Perry I. McPherson (Allegan Co.)
P.P. N71°W 212.64'
P.P. N88°E 34.61'
Square post S46°E 46.22'
4. August 9, 1977
Exxel Eng.
Recorded survey L. 1, Pg. 416 (Barry County)
Capped Iron
Nail & tag in S. side P.pole E 34.62'
PK Nail in NW side wood post SE 46.28'
Nail in S. side 18" Ash W 114.47'
SE cor. Mobile home NW 134.79'
5. July 21, 1978
Exxel Eng.
Recorded survey L. 1, Pg. 478 (Barry County)
Capped Iron
Nail & tag in S. side P.pole E 34.62'
PK Nail in NW side wood post SE 46.28'
Nail in S. side 18" Ash W 114.47'
SE cor. Mobile home NW 134.79'
6. Sept. 8, 1980
Exxel Eng.
Recorded survey (Allegan County)
Iron
Nail in S. side P.pole E 34.62'
Nail in NW side wood post SE 46.28'
Nail in S. side 18" Ash W 114.47'
SE cor. hse fndn. NW 116.84'
7. Holland Eng. witnesses
Iron
Nail in S. side P.pole E 34.62'
Nail in NW side wood post SE 46.28'
Nail in S. side 18" Ash W 114.47'
SE cor. hse fndn. NW 116.84'
8. Sept. 16, 1988
Reynolds Land Surveying
Used corner in survey as per LCRC #176 (Barry Co.)