

LAND CORNER RECORDATION CERTIFICATE  
Filing Requirement of Act 74, Mich. P.A. 1970 as Amended

For corners in

Baraga (County)	Located In:	Corner Code #
1. Public Land Survey	T R	
	T R	
	T R	
2. Property Controlling in Section	S 36 T 48N R 34W	5
	S 36 T 48N R 34W	L12
	S T R	
3. Miscellaneous Property in Sec.	S T R	
	S T R	
4. Lot No. _____, Recorded Plat		
5. Private Claims		

Register of Deeds Stamp & File Number

	A	B	C	D	E	F	G	H	I	J	K	L	M
1													
2	6		5		4		3		2		1		
3													
4	7		8		9		10		11		12		
5													
6	18		17		16		15		14		13		
7													
8	19		20		21		22		23		24		
9													
10	30		29		28		27		26		25		
11													
12	31		32		33		34		35				
13													

I, Stephan J. Szyszkoski, in a field survey on 06/09/2011 do hereby state  
that under requirements of P.A. 74, Michigan P.A. of 1970, the corner points mentioned in lines 1 and 2  
above were in conformance with regulations and rules therefore as required in the current manual of survey  
instructions of the United States Department of the Interior, Bureau of Land Management or by a decree of  
a Court of Law and /or that the corner points mentioned in lines 3, 4 and 5 above were in conformance with  
the rules of the Michigan Board of Land Surveyors or by a Decree of a Court of Law; established,  
re-established, monumented, recovered, found as expressed below:

NOTE: Not more than 2 corners, all in the same town and range, may be recorded  
on this certificate.

A. Description of original monument and accessories and/or subsequent restoration:

(5-Sec. 36) North 1/16 corner, Section 36. Not established in the original survey.

(L12) Center of Section 36. Not established in the original survey.

B. Description of corner evidence found and/or method applied in restoring or reestablishing corner:

(5-Sec. 36) Established the corner midway and on a straight line between Quarter corner 1318.12'  
North and Center of Section 36 1318.12' South.

(L12) Established the corner at the intersection of straight lines connecting opposite 1/4 corners  
2636.24' north, 2629.75' south, 2637.95' east, and 2634.54' west.

C. Description of monument for corner and accessories established to perpetuate locating the position of the corner:

(5) Set 1"IDx32" I.pipe with 4" alum. MDNR cap.  
Set measuring nail with MDNR tag in the side of:  
14" Tamarack N05E 41.75' mrkd "1/16S BT"  
4" Balsam N72E 14.75' do  
6" B.Spruce S12W 35.2' do  
5" Balsam S55W 25.85' do  
Set Sq'd Cedar post adjacent.  
Bearings are magnetic.

(L12) Set 1"IDx32" I.pipe with 4" alum. MDNR cap.  
Set measuring nail with MDNR tag in the side of:  
3" Maple N69E 0.95' mrkd "C1/4 BT"  
17" W.Pine S10W 23.6' do  
6" Maple N88W 40.75' do  
5" Balsam N31W 19.0' do  
Set sq'd Cedar post adjacent.  
Bearings are magnetic.

Signed by Stephan J. Szyszkoski  
Surveyor's Michigan License No. 33986

Date 06/29/2011

For the Michigan Department of Natural Resources, Forest Management Division

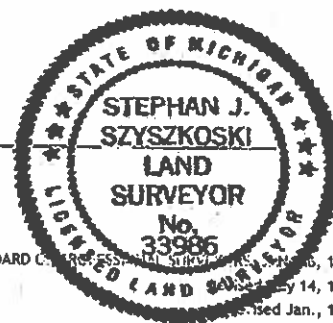

16639

16640

FORM APPROVED BY MICHIGAN STATE BOARD OF LAND SURVEYORS, 1971

Revised Jan., 1983

Revised Oct., 1995