

# SURVEY & REMONUMENTATION

SEP 13 1994

COMMISSION

## BARRY COUNTY REMONUMENTATION LAND CORNER RECORDATION CERTIFICATE Filing Requirement of Act 74, Mich. P.A. 1970

STATE OF MICHIGAN  
COUNTY OF BARRY  
RECEIVED FOR RECORD

MAR 16 4 24 PM '94

Sandy Schondelmayer

REGISTER OF DEEDS

002189

Register of Deeds Stamp & File Number

For corners in

BARRY

(County)

Located In:

Corner Code #

1. Public Land Survey

T 1N R 9W G-4

T BARRY TWNSP.

T H4 COR. SEC. 9 - 10

T R

2. Property Controlling  
in Section

S T R

S T R

3. Miscellaneous  
Property in Sec.

S T R

S T R

4. Lot No. , Recorded Plat

5. Private Claims

BRIAN REYNOLDS

31 JAN

94

I, , in a field survey on , 19 ,  
do hereby certify that under requirements of P.A. 74, Michigan P.A. of 1970, the corner points mentioned  
in lines 1 and 2 above were in conformance with regulations and rules therefore as required in the  
current manual of survey instructions of the United States Department of the Interior, Bureau of Land  
Management or by a decree of a Court of Law and/or that the corner points mentioned in lines 3, 4 and 5  
above were in conformance with the rules of the Michigan Board of Land Surveyors or by a Decree of a  
Court of Law; established, re-established, monumented, re-monumented, recovered, found as  
expressed below:

NOTE: Not more than 4 corners, all in the same town and range, may be recorded  
on this certificate.

A. Description of original monument and accessories and/or subsequent restoration:

-GENERAL LAND OFFICE: (SYLVESTER SIBLEY D.S., 1826, R9W, Pg. 25) SET POST & TOOK WITNESSES: W.

OAK - 14 - N39E - 23lks.; Do. -28 - S24W - 29lks.

- COBB, 17 JUNE 1889 (L.2, Pg. 268) (BOOK IX, Pg. 55) FOUND OLD GOV'T STUMP AND REMAINS OF STAKE.

SET STONE 18x12x3 - SMALL STONES - BRICK - CROCKERY:

W. OAK - 28 - S66E - 26

- DON DAVIS, PS# 17617, SURVEY FOR "FLORIA - SMITH", 4/14/81.

FOUND 2" x 8" STONE: 18" TWIN OAK - S85W - 14.50'

10" MAPLE - SOUTH - 6.10'

8" MAPLE - EAST - 19.80'

B. Description of corner evidence found and/or method applied in restoring or reestablishing corner:

-REYNOLDS (31JAN94): FOUND " DAVIS' WITNESSES. (TREES PRESENT NAILS OVERGROWN). PULLED  
DISTANCES AND DUG TO FIND A 15" x 12" x 3" GREEN QUARTZ STONE - SURROUNDED BY SMALL STONES -  
BRICK - CROCKERY AT INTERSECTION OF N. - S. - E. - W. FENCES. STONE MATCHES DESCRIPTION OF THAT  
SET BY COBB (1889). ACCEPTED STONE AS PERPETUATION OF CORNER BY COBB(1889).

ACT 345 BARRY COUNTY REMONUMENTATION  
APPROVED BY PEER REVIEW AT A MEETING HELD ON

FEBRUARY 1, 1994 BR  
BRIAN REYNOLDS COUNTY SURVEYOR

C. Description of monument for corner and accessories established to perpetuate locating the position of the corner:

- SET BARRY Co. REMON. MONUMENT SURROUNDED WITH SMALL STONES:

N&T - SE. FACE - 10" HICKORY - S30W - 34.13'

N&T - E. FACE - 10" MAPLE - S10E - 20.60'

N&T - E. FACE - 6" BLACK CHERRY - S35E - 45.19'

N&T - NW. FACE - 6" MAPLE - N45E - 38.22'

N&T - E. FACE - 6" MAPLE - N10W - 31.76'

TREE ROW AND TRACES OF FENCE N. - S. - E. - W.

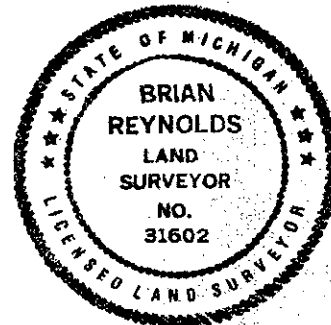

Signed by

*[Signature]*

Date

MARCH 8, 1994

Surveyor's Michigan License No.

31602