

FEB 17 1994

COMMISSION

12/03/93

111#3384 A33

CORNER \$7.00

12/03/93

111#3384 A33

STATE REMON FEE \$2.00

REGISTER OF DEEDS
BERRIEN COUNTY MICHIGAN

DEC 3 1 24 PM '93

RECORDED

LAND CORNER RECORDATION CERTIFICATE
Filing Requirement of Act 74, Mich. P.A. 1970
BERRIEN COUNTY REMONUMENTATION

For corners in

Berrien (County)	Located In:	Corner Code #
1. Public Land Survey	T 5S R 19W T 5S R 19W T _____ R _____ T _____ R _____	G13 H13
2. Property Controlling in Section	S _____ T _____ R _____ S _____ T _____ R _____	
3. Miscellaneous Property in Sec.	S _____ T _____ R _____ S _____ T _____ R _____	

Register of Deeds Stamp & File Number

- 4. Lot No. _____, Recorded Plat _____
- 5. Private Claims _____

	A	B	C	D	E	F	G	H	I	J	K	L	M
2	6		5		4		3		2		1		
3													
4	7		8		9		10		11		12		
5													
6	18		17		16		15		14		13		
7													
8	19		20		21		22		23		24		
9													
10	30		29		28		27		26		25		
11													
12	31		32		33		34		35		36		
13													

I, John G. Kamer, in a field survey on December 2, 19 93, do hereby certify that under requirements of P.A. 74, Michigan P.A. of 1970, the corner points mentioned in lines 1 and 2 above were in conformance with regulations and rules therefore as required in the current manual of survey instructions of the United States Department of the Interior, Bureau of Land Management or by a decree of a Court of Law and/or that the corner points mentioned in lines 3, 4 and 5 above were in conformance with the rules of the Michigan Board of Land Surveyors or by a Decree of a Court of Law; established, re-established, monumented, re-monumented, recovered, found as expressed below:

NOTE: Not more than 4 corners, all in the same town and range, may be recorded on this certificate.

A. Description of original monument and accessories and/or subsequent restoration:

- G-13 1830 government post. Accessories: 10" Oak N 58 1/2° E 26 links, 6" Whitewood N 9° W 10 links. 1973 & 1974 Richard Garrett stone in Mon. Box. Accessories: tele pole S 30° E 41.65', tele pole S 30° W 41.00' Phone Riser N 30° E 46.52'.
- H-13 1830 government post. Accessories: 18" Beech N 46° E 38 links, 15" Beech N 49° W 4 links. 1912 & 1917 William J. Cleary & W&A Notes, found stone. 1973 W&A Survey notes IP in Mon. Box. Accessories Iron Pipe South 33.0 feet, grape post N 15° W 38.23', PP S 50° W 56.62'. 1987 John G. Kamer 1" Iron in Mon. Box, Accessories: PP S 45° E 56.54', 1 1/2" pipe south 33.0', PK in RR tie wall S 80° E 66.65'. John G. Kamer 1989 found 3/4" rebar in Mon. Box. Accessories PK in PP S 50° W 56.61', PK in RR tie N 20° W 37.93', PK in RR Tie Wall S 80° E 66.65'.

B. Description of corner evidence found and/or method applied in restoring or reestablishing corner:

- G-13 Mon. Box w/ 5/8" Rod. Distances to adjacent corners were reasonable and consistent. Accepted 5/8" rod as best evidence of corner. Corner common to NW cor 3-6-19.
- H-13 3/4" Rod in Mon. Box. Distances to adjacent corners were reasonable and consistent. Accepted 3/4" rod as best evidence of corner. Corner common to N 1/2 cor. 3-6-19.

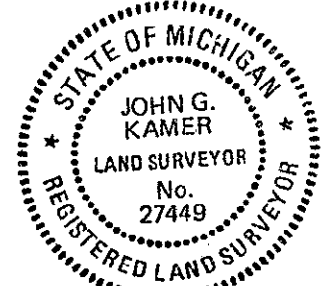

- C. Description of monument for corner and accessories established to perpetuate locating the position of the corner:
 - G-13 Set standard 3" pipe w/brass plate in Mon. Box in Place of 5/8" Rod and is accepted as a careful and faithful perpetuation of the position of the original corner
Set Nail w/witness tag in PP S 37° E 41.61'
Set Nail w/witness tag in S 45° W 40.91'
Set Nail w/witness tag in wood post N 32° E 45.61'
Top Hydrant S 27° W 66.86'
 - H-13 Set standard 10" pipe w/brass plate in Mon. Box in place of 3/4" rod, and is accepted as a careful and faithful perpetuation of the position of the origin corner.
Set Nail w/witness tag in grape post N 25° W 37.90'
Set Nail w/witness tag in PP S 58° W 56.88'
Set Nail w/witness tag on RR tie Re. wall S 72° E 66.64'
Found 1" IP S 3° W 32.94'

Signed by John G. Kamer Date 12-02-93
 Surveyor's Michigan License No. 27449