

REMONUMENTATION

FEB 22 1996

COMMISSION CALHOUN COUNTY REMONUMENTATION

LAND CORNER RECORDATION CERTIFICATE
Filing Requirement of Act 74, Mich. P.A. 1970

APPROVED

Date Nov. 20, 1995

CALHOUN COUNTY
REMONUMENTATION.

For corners in

Calhoun County

(County)

City of Battle Creek

Located in:

Corner Code #

1. Public Land Survey

T 2 S R 8 W

H-11

T R

T R

T R

2. Property Controlling
in Section

S T R

S T R

3. Miscellaneous

S T R

Property in Sec.

S T R

STATE OF MICHIGAN
CALHOUN COUNTY
RECORDED

4 DEC 95 2:22 P.M.

ANNE B. NORLANDER
CLERK - REGISTER OF DEEDS

Register of Deeds Stamp & File Number

4. Lot No. , Recorded Plat

5. Private Claims

I, William K. Crane, in a field survey on January 24, 1995, do hereby certify that under requirements of P.A. 74, Michigan P.A. of 1970, the corner points mentioned in lines 1 and 2 above were in conformance with regulations and rules therefore as required in the current manual of survey instructions of the United States Department of the Interior, Bureau of Land Management or by a decree of a Court of Law and/or that the corner points mentioned in lines 3, 4 and 5 above were in conformance with the rules of the Michigan Board of Land Surveyors or by a Decree of a Court of Law; established, re-established, monumented, re-monumented, recovered, found as expressed below:

NOTE: Not more than 4 corners, all in the same town and range, may be recorded on this certificate.

A. Description of original monument and accessories and/or subsequent restoration:

Original Government Field Notes:

7" W. Oak N 37° E 25 links
9" W. Oak S 31° E 7 links

Re-survey of Battle Creek Township
in 1887, by F. Hodgman:

Set post according to original survey

10" Y. Oak N 52½° E 79½ links
4" W. Oak N 41½° W 68½ links

Records of Dekeyser & Associates indicate a
3/4" solid iron stake with the following
witnesses:

14" Walnut N-NE 36.62'
24" Oak N 40.53'
26" Hickory W-SW 62.04'
9" Walnut S-SE 20.95'

B. Description of corner evidence found and/or method applied in restoring or reestablishing corner:

Found Bernsten Monument in monument box as recorded in Liber 1794, Page 333 for the plat of Minges Hills No. 5.

LIBER 1834 PAGE 250

C. Description of monument for corner and accessories established to perpetuate locating the position of the corner:

Calhoun County Remonumentation monument, (Bernsten Monument) in monument box.

6" Oak N 40° E 62.38'
8" Twin Oak S 65° E 68.02'
4" Cherry N 48° W 60.71'
18" Twin Maple S 85° W 165.10'
(all trees have nails and spotters)

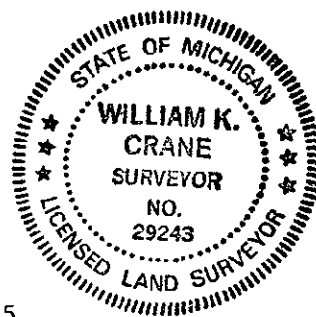

Signed by William K. Crane

William K. Crane

Surveyor's Michigan License No.

29243

Date November 20, 1995