

SURVEY & REMONUMENTATION

APR 26 1995

COMMISSION

LAND CORNER RECORDATION CERTIFICATE

Filing Requirement of Act 74, Mich. P.A. 1970 NOV 8 PM 2 54
CASS COUNTY REMONUMENTATION

For corners in

CASS

(County)

Located in:

Corner Code ##

1. Public Land Survey

T 6 R 16 (Sec. 1) M-2

T R

T R

T 6 R 15 (Sec. 6) A-2

2. Property Controlling in Section

S T R

S T R

3. Miscellaneous

S T R

Property in Sec.

S T R

4. Lot No. , Recorded Plat

5. Private Claims

STATE OF MICHIGAN
CASS COUNTY
RECEIVED FOR RECORD

Ann L. Simmons
CLERK/REGISTER

LIBER 2 PAGE 360

Register of Deeds Stamp & File Number

Ratified by Peer Group

In Accordance With P.A. 345

Chairman Dale Kesler

Date October 21, 1994

I, Dale L. Kesler, in a field survey on October 31, 1994

do hereby certify that under requirements of P.A. 74, Michigan P.A. of 1970, the corner points mentioned in lines 1 and 2 above were in conformance with regulations and rules therefore as required in the current manual of survey instructions of the United States Department of the Interior, Bureau of Land Management or by a decree of a Court of Law and/or that the corner points mentioned in lines 3, 4 and 5 above were in conformance with the rules of the Michigan Board of Land Surveyors or by a Decree of a Court of Law; established, re-established, monumented, re-monumented, recovered, found as expressed below:

NOTE: Not more than 4 corners, all in the same town and range, may be recorded on this certificate.

	A	B	C	D	E	F	G	H	I	J	K	L	M
2	6		5		4		3		2				
3													
4	7		8		9		10		11		12		
5													
6	18		17		16		15		14		13		
7													
8	19		20		21		22		23		24		
9													
10	30		29		28		27		26		25		
11													
12	31		32		33		34		35		36		
13													

A. Description of original monument and accessories and/or subsequent restoration:

(M-2) 1827 - William Brookfield set post, accessories 14" White Oak S. 35-1/2° W. 100 Lks., 22" White Oak N. 78-1/3° W. 34 Lks.; Notes on file at Wightman-Peirce, Inc. office found stone 3' deep; 1983 H. D. Peirce & Associates found 8" plug, no witnesses.

(A-2) 1983 - H. D. Peirce & Associates found R.R. spike, no witnesses; R.W. Prestine found 3/4" iron bar in concrete, accessories nail electric pole N. 40° W. 26.4', Nail electric pole S. 40° E. 34.85', 16" Maple S. 24° W. 46.75', Manhole N. 45° E. 8.05'.

B. Description of corner evidence found and/or method applied in restoring or reestablishing corner:

(M-2) Found stone 4.0 feet deep. Accepted stone as best evidence of corner.

(A-2) Nothing was found. Set corner 95.04' south of the east quarter corner of Section 1, T 6 S, R 16 W and on line between the east quarter corner Section 1, T 6 S, R 16 W and the southeast corner of Section 1, T 6 S, R 16 W.

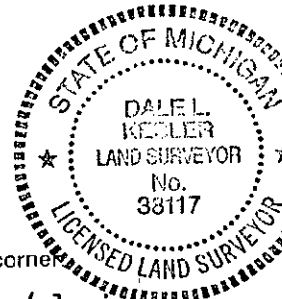

C. Description of monument for corner and accessories established to perpetuate locating the position of the corner:

(M-2) Set standard 2' iron pipe w/aluminum cap and accepted as a careful & faithful perpetuation of the position of the original corner.

Standard 2' iron pipe w/alum cap S. 95.04'
Set nail w/witness tag in power pole N. 21° 09' E. 60.67'
Set nail w/witness tag in 30" Maple S. 36° 01' E. 60.03'
Set nail w/witness tag in 38" Maple S. 35° 19' W. 66.33'
Found 1" iron pipe - S. 87° 22' W. 33.06'

(A-2) Set standard 2' iron pipe w/aluminum cap. This position not established by original Gov. surveyors. This monument is accepted as the best available evidence of the position of the corner.

Top bolt fire hydrant S. 56° 08' E. 23.10'
Set PK nail in 24" Maple N. 37° 31' E. 55.21'
Set PK nail in 36" Oak N. 43° 04' W. 57.07'
Set PK nail in power pole S. 86° 11' W. 41.28'

Signed by

Dale Kesler

Date

November 8, 1994

Surveyor's Michigan License No.

No. 38117