

SURVEY & REMONUMENTATION

FEB 02 1998

SECTION

REMONUMENTATION

SECTION 10, EAGLE TOWNSHIP

LAND CORNER RECORDATION CERTIFICATE

Filing Requirement of Act 74, Mich. P.A. 1970

LIBER 004 PAGE 227

For corners in

Clinton
(County)

Located In:

Corner Code #

RECORDED

1. Public Land Survey

T 5N R 4W

I-5

2. Property Controlling
in Section

S T R

3. Miscellaneous
Property in Sec.

S T R

4. Lot No. , Recorded Plat

5. Private Claims

OCT 17 9 19 AM '97

REGISTER OF DEEDS
CLINTON COUNTY, MICH.
C. W. WOOD

Register of Deeds Stamp & File Number

I, Arden S. Pierson, PS, in a field survey on July 23 19 97, do hereby certify that under requirements of P.A. 74, Michigan P.A. of 1970, the corner points mentioned in lines 1 and 2 above were in conformance with regulations and rules therefore as required in the current manual of survey instructions of the United States Department of the Interior, Bureau of Land Management or by a decree of a Court of Law and/or that the corner points mentioned in lines 3, 4 and 5 above were in conformance with the rules of the Michigan Board of Land Surveyors or by a Decree of a Court of Law; established, re-established, monumented, re-monumented, recovered, found as expressed below:

NOTE: Not more than 2 corners, all in the same town and range, may be recorded on this certificate.

	A	B	C	D	E	F	G	H	I	J	K	L	M
1													
2	6		5		4		3		2		1		
3													
4	7		8		9		10		11		12		
5													
6	18		17		16		15		14		13		
7													
8	19		20		21		22		23		24		
9													
10	30		29		28		27		26		25		
11													
12	31		32		33		34		35		36		
13													

A. Description of original monument and accessories and/or subsequent restoration:

- ◆Original Survey by Lucius Lyon, PS, 1827. Set Post Corner to Sections 10, 11, 14 and 15, witnessed by: W. Oak 10" - S25°W - 26 links; R. Oak 15" - N65½°E - 24 links.
- ◆Survey by H.H. Jenison, County Surveyor, dated May 24-25, 1876. Witness: Thorne 3" - S57°W - 71½ links.
- ◆Clinton County Survey Field Notes, witness: Thorne 3" - S57°W - 71½ links.

(OVER)

APPROVED BY
CLINTON COUNTY PEER GROUP
DATED 8/20/97

B. Description of corner evidence found and/or method applied in restoring or reestablishing corner:

Retraced recorded surveys and located 2 corner positions, excavated to 3.5' below the road surface and found the correct corner at the north excavation, found 1 & 5/8" solid shaft at this point.

Accepted steel shaft as a careful and faithful reestablishment of the position of the original corner. Set Standard Clinton County monument and monument box.

Found ¾" pipe at south excavation and raised to surface with ½" rod and monument box, this defective monument is 19.86' south of the correct corner.

C. Description of monument for corner and accessories established to perpetuate locating the position of the corner:

Southeast Corner, Section 10

*Standard Clinton County Monument and monument box

- nail & tag #13039 in East side Power Pole - S15°W - 138.33'
- nail & tag #13039 in S/W side 12" Hickory - S14°E - 125.61'
- nail & tag #13039 in N/W side 14" Hickory - S85°E - 40.92'
- nail & tag #13039 in N/E side 6" Maple - N24°W - 89.02'

*Standard Clinton County Monument is a 2½" diameter Steel tube 30" long with a stamped brass cap and a breakaway magnetic base.

Signed by

Arden S. Pierson

Date

July 30, 1997

Surveyor's Michigan License No.

13039

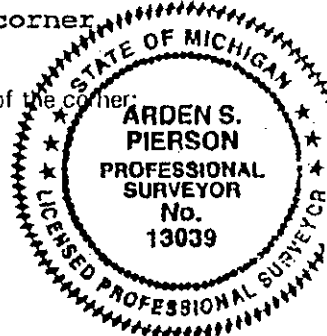

◆LCRC by Arthur A. Ivey, PS, #6519, dated October 22, 1977, Liber 2, Page 159. Located corner, using calls in G.L.O. records. Made some adjustment to better fit evidence of long occupation. A 1-5/8" x 24" steel shaft, set in westerly edge of Tallman Road gravel, about 0.5' below surface. About 215' North of the North end of bridge over the Looking Glass River. Witnessed by:
 Nail & tag in South side 15" Wild Cherry - S77°E - 32.59'
 Nail & tag in South side 26" W. Ash - S80°W - 26.03'
 Nail & tag in SE side 9" R. Cedar - S40°W - 44.01'

◆Certificate of Survey by Fred N. White, PS, #12034, dated November 26, 1980, Liber 2, Page 389.

◆LCRC by Fred N. White, PS, #12034, dated February 4, 1981, Liber 2, Page 374. Found axle and shaft, witnessed by:
 Nail & tag South side 15" Wild Cherry - S77°E - 31.50'
 Nail & tag 36" White Ash - S80°W - 26.43'
 Nail & tag SE side 9" Red Cedar - S40°W - 43.45'

◆Certified Boundary Survey by Larry A. Bryan, PS, #25832, dated March 15, 1982, Liber 5, Pages 35-36.

◆Certificate of Survey by Fred N. White, PS, #12034, dated July 31, 1985, Liber 2, Pages 851-852.

◆Certificate of Property Survey by David R. Lohr, PS, #30090, Liber 4, Page 724 dated July 16, 1993. Found 1" pipe in center of Tallman Road, witnessed by:

Set N&T 30090 SE/S 8" Maple - N37°E - 51.44'
 Found N&T 6519 S/S 16" Stump - N63°E - 33.19'
 Set N&T 30090 SW/S 12" Ash - S54°E - 59.64'
 Set N&T 30090 - S/S - 26" Willow - N62°W - 32.45'