

SURVEY & MONUMENTATION

JAN 11 2001

FILED

Copy

SECTION

LAND CORNER RECORDATION CERTIFICATE - 3 PM 1:33
Filing Requirement of Act 74, Mich. P.A. 1970

For corners in

EATON COUNTY

Located In:

Corner Code #

(County)

ROXAND TOWNSHIP

1. Public Land Survey

T 4N R 5W

L-11

T R

T R

T R

2. Property Controlling in Section

S T R

S T R

3. Miscellaneous

S T R

Property in Sec.

S T R

LINDA M. TWITCHELL
REGISTER OF DEEDS
EATON COUNTY, MICH.

LIBER

4 PAGE 155

Register of Deeds Stamp & File Number

4. Lot No. , Recorded Plat

5. Private Claims

I, DAVID L. CLIFFORD, in a field survey on JULY 24, 2000

do hereby state that under requirements of P.A. 74, Michigan P.A. of 1970, the corner points mentioned in lines 1 and 2 above were in conformance with regulations and rules therefore as required in the current manual of survey instructions of the United States Department of the Interior, Bureau of Land Management or by a decree of a Court of Law and for that the corner points mentioned in lines 3, 4 and 5 above were in conformance with the rules of the Michigan Board of Land Surveyors or by a Decree of a Court of Law, established, re-established, monumented, recovered, found as expressed below:

NOTE: Not more than 2 corners, all in the same town and range, may be recorded on this certificate.

A. Description of original monument and accessories and/or subsequent restoration:

1. ORANGE RISDON D.S. SET POST IN ORIGINAL GOVERNMENT SURVEY IN JANUARY 1826; ELM 5" S49°W 14 LKS; ASH 12" N49°E 04 LKS

2. W.H. BAILEY, COUNTY SURVEYOR, USED CORNER IN A SURVEY RECORDED IN

VOL. 2 PAGE 129 COUNTY SURVEYORS RECORD IN MARCH 1880 AS "FOUND GOVT. STAKE

B. Description of corner evidence found and/or method applied in restoring or reestablishing corner:

SEARCHED AT APPARENT LOCATION OF CORNER AND FOUND WOOD POST AT NORTH-SOUTH- WEST FENCE INTERSECTION. EXCAVATED 3' DIAMETER AROUND POST AND FOUND MANY STONES. ACCEPTED POST AS CORNER AS PERPETUATED BY BAILEY AND SET 3/4" X 24" STEEL BAR & ALUMINUM CAP ON SOUTH SIDE OF IT. AFTER TRAVERSE OF SECTIONS 25 & 36 REVEALED THAT CORNER SHOULD BE ABOUT 22' SOUTH RETURNED TO AREA AND SEARCHED 22' SOUTH OF POST. FOUND AXLE SHAFT SURROUNDED BY BROKEN CROCKERY IN MIDDLE OF ABANDONED ROAD BED. ACCEPTED AXEL AS PERPETUATION OF CORNER AND CAPPED IT WITH ALUMINUM CAP. MEASURED EAST 2646.16 TO M-11. MEASURED WEST 2647.63 TO K-11. MEASURED NORTH 2644.58' TO L-10. MEASURED SOUTH 2645.01' TO L-12.

C. Description of monument for corner and accessories established to perpetuate locating the position of the corner:

L-11 T4N, R5W

1" AXLE & 2 1/2" ALUMINUM CAP IMPRINTED PA 345 PS 25837 EATON COUNTY

SET NAIL & TAG #25837 EAST SIDE 14" TWIN ASH, N7°W, 47.8'

SET NAIL & TAG #25837 NORTH SIDE 120" MULT. MAPLE, N80°W, 81.2'

SET NAIL & TAG #25837 WEST SIDE 22" ASH, S8°W, 14.7'

SET NAIL & TAG #25837 EAST SIDE 20" ASH, N9°W, 11.95'

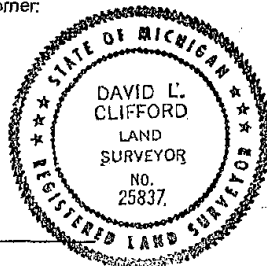

Signed by

David Clifford

Date JULY 29, 2000

Surveyor's Michigan License No. 25837

FORM APPROVED BY MICHIGAN STATE BOARD OF PROFESSIONAL SURVEYORS, JAN. 28, 1971

REVISED MAY 14, 1975

REVISED JAN. 1983

REVISED OCT. 1996

P.A. 345 EATON COUNTY

PEER APPROVED 8/01/2000 M