

SURVEY &  
REMONUMENTATION

JAN 17 1996

COMMISSION

LAND CORNER RECORDATION CERTIFICATE  
Filing Requirement of Act 74, Mich. P.A. 1970

LIBER 001 PAGE 93

STATE OF MICHIGAN  
GLADWIN COUNTY  
FILED-REMONUMENTATION

26 DEC 95 10:55 A.M.

BONNIE K. HOUSE  
REGISTER OF DEEDS

For corners in

GLADWIN  
(County)

Located In:

Corner Code #

1. Public Land Survey T 19N R 2W I-10  
T R  
T R  
T R  
2. Property Controlling S T R  
in Section S T R  
3. Miscellaneous S T R  
Property in Sec. S T R

4. Lot No. Recorded Plat  
5. Private Claims

Register of Deeds Stamp & File Number

I, PAUL B. LAPHAM, in a field survey on MAY-NOVEMBER, 19 95 do hereby state that under requirements of P.A. 74, Michigan P.A. of 1970, the corner points mentioned in lines 1 and 2 above were in conformance with regulations and rules therefore as required in the current manual of survey instructions of the United States Department of the Interior, Bureau of Land Management or by a decree of a Court of Law and for that the corner points mentioned in lines 3, 4 and 5 above were in conformance with the rules of the Michigan Board of Land Surveyors or by a Decree of a Court of Law; established, re-established, monumented, recovered, found as expressed below:

NOTE: Not more than 2 corners, all in the same town and range, may be recorded on this certificate.

	A	B	C	D	E	F	G	H	I	J	K	L	M
1													
2	6		5		4		3		2		1		
3													
4	7		8		9		10		11		12		
5													
6	18		17		16		15		14		13		
7													
8	19		20		21		22		23		24		
9													
10	30		29		28		27		26		25		
11													
12	31		32		33		34		35		36		
13													

- A. Description of original monument and accessories and/or subsequent restoration:
- 1856 LEVI H. CANNON SET POST WIT.-(1)W. PINE 14" S74°W 10 (2)HEMLOCK 12" N30°E 25
- 1950 EDMANDS DUNDAS WORKING DWG'S AND WITNESSES WIT.-(3)33.1' W GUY POST (4)P. POLE 37.25' (5)S.E. POWER POLE 61.60' (6)N.W. POWER POLE 103.7'
- 1963 LAPHAM WITNESSES CARD SET IRON
- 1974 LAPHAM L.C.R.C. #92 FOUND P.K. NAIL WIT.-(7)S30°E 66.42' POWER POLE (8)S40°W 57.73' EAST END POST RAIL FENCES (9)S75°W 91.20' WEST END POST RAIL FENCES
- 1976 LAPHAM SURVEY #760856 SAME AS (7), (8) & (9)
- 1979 LAPHAM SURVEY #792611 SAME AS (7), (8) & (9)
- 1987 LAPHAM SURVEY G-877395 SAME AS (7), (8) & (9)
- 1989 LAPHAM SURVEY G-899627 SAME AS (7), (8) & (9)
- 1989 LAPHAM SURVEY G899197 SAME AS (7), (8) & (9)
- 1989 LAPHAM SURVEY G898934 SAME AS (7), (8) & (9)
- LAPHAM UNRECORDED L.C.R.C. FOR COUNTY ROAD CONSTRUCTION FOUND P.K. NAIL, SET C.I. WIT.-(10)S30°E POWER POLE 66.38' (11)N25°W POWER POLE 105.23' AND (8) & (9)
- B. Description of corner evidence found and/or method applied in restoring or reestablishing corner:
- FOUND CAPPED IRON INTERSECTION ASPHALT ROADS, EXCAVATED FOUND 3/4"x18" PINCH PIPE, NO OTHER CORNERS FOUND SET GLADWIN MONUMENT FROM FOUND PINCH IRON AND WITNESSES (7), (10) & (11) AND FOUND PINCH IRON SET BY LAPHAM IN 1963.

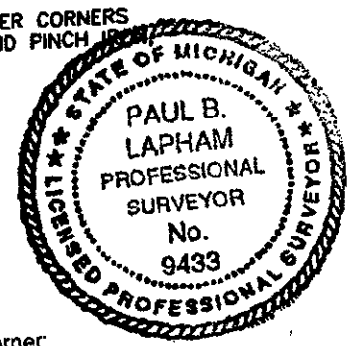

This Corner established in Gladwin County Remonumentation Program.  
See dossier for detailed report.

C. Description of monument for corner and accessories established to perpetuate locating the position of the corner:

I-10: CORNER COMMON TO 26 & 27  
SET 5/8"x36" RE-ROD WITH GLADWIN COUNTY RE-MON CAP, MARKED P.S. #9433.

WITNESSES:  
S30°E 66.38' - NAIL & TAG IN POWER POLE  
N25°W 105.23' - NAIL & TAG IN POWER POLE  
S50°W 133.30' N.W. CORNER BLK. BLD.  
N45°E 62.93' - 1/2"x18" RE-ROD, BELOW SURFACE  
NORTH P.K. NAIL 2.0'  
EAST P.K. NAIL 2.0'

APPROVED LAND CORNER  
P.A. 345 of 1990  
Gladwin County

Co. Rep. [Signature]  
Date 12/18/95

Signed by Paul B. Lapham  
Surveyor's Michigan License No. 9433

Date 12-22-95