

OCT 03 1996

COMMISSION

**LAND CORNER RECORDATION CERTIFICATE**  
**Filing Requirement of Act 74, Mich. P.A. 1970**

For corners in

Gogebic

(County)

Located In:

Corner Code ~~==~~

## 1: Public Land Survey

T4 5N R 4 3W

C 11-12

T R

T B

T R

T R

## 2. Property Controlling in Section

S T R

S T R

### 3. Miscellaneous

S \_\_\_\_\_ T \_\_\_\_\_ R \_\_\_\_\_

Property in Sec.

S \_\_\_\_\_ T \_\_\_\_\_ R \_\_\_\_\_

4. Lot No. \_\_\_\_\_, Recorded Plat \_\_\_\_\_

## 5. Private Claims

C.C. corner between Sec's. 31 & 32 on State Line  
between Michigan and Wisconsin

John P. Goss in a field survey on July 20, 1996

do hereby certify that under requirements of P.A. 74, Michigan P.A. of 1970, the corner points mentioned in lines 1 and 2 above were in conformance with regulations and rules therefore as required in the current manual of survey instructions of the United States Department of the Interior, Bureau of Land Management or by a decree of a Court of Law and/or that the corner points mentioned in lines 3, 4 and 5 above were in conformance with the rules of the Michigan Board of Land Surveyors or by a Decree of a Court of Law; established, re-established, monumented, re-monumented, recovered, found as expressed below:

**NOTE:** Not more than 4 corners, all in the same town and range, may be recorded on this certificate.

A. Description of original monument and accessories and/or subsequent restoration:

Original Corner established by Algernon Merryweather, July 29, 1852

Original corner Balsam 4". Original bearing tree: Sugar 12"- East 2 links.

James D. Rein, RLS 26464 re-established this corner 3.75 chain westerly of of meander corner in Section 32. He set a 3/4" by 36" rebar with a 2 "dia. aluminum cap marked: T45N, R43W; S-31; S-32; C.C.; 26464 1982; He recorded recorded said corner in Liber 2 pages 270 & 271 of Land corners for Gogebic Gogebic County, with the following witnesses: 9" Basswood-S 87°E-50.4'; 4" Sugar Maple-S 28° E- 43.6'; 5" Sugar Maple- N 53° E- 45.4'; 8" Sugar Maple N 36° W- 38.1'.

B. Description of corner evidence found and/or method applied in restoring or reestablishing corner:

I found the 3/4 inch rebar with 2 inch aluminum cap and it checked with James D. Rein witnesses. I updated the accessories as noted below to state and county specification.

Act 74 research on file.

PEER GROUP IDENTIFIED

Reclaim L. Drain 8/8/98  
COUNTY REPRESENTATIVE

# COUNTY REPRESENTATIVE

C. Description of monument for corner and accessories established to perpetuate locating the position of the corner:

From the 3/4 inch rebar with 2 inch aluminum cap I established the following existing and new bearing trees and reference objects.

D.H. Nail & tag in 12" Basswood	S 87° E	50.40'
D.H. Nail & tag in 8" Sugar Maple	N 53° E	45.37'
D.H. Nail & tag in 11" Sugar Maple	N 36° W	37.87'
D.H. Nail & tag in 5" Aspen	S 66° W	39.80'
6' rail and sign	Due N.	0.88'

S 87° E	50.40'
N 53° E	45.37'
N 36° W	37.87'
S 66° W	39.80'
Due N.	0.88'

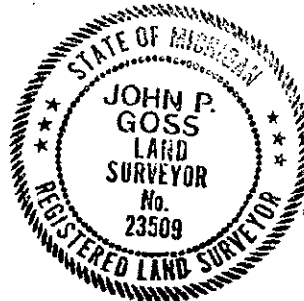

Signed by John V. Doso

Date July 22, 1996

Surveyor's Michigan License No. 23509

Fed. No. V-W-5

FORM APPROVED BY MICHIGAN STATE BOARD OF LAND SURVEYORS, JAN. 28, 1971  
REVISED MAY 14, 1975  
REVISED JAN., 1983