

APRIL 30, 1999  
Robert W. Campbell

LAND CORNER RECORDATION CERTIFICATE  
Filing Requirement of Act 74, Mich. P.A. 1970

For corners in

Houghton

(County)

Located In: 27

Corner Code #

1. Public Land Survey

T 54N R 33W

H/I 9 (18)

MARY SCHOOS 05/19/99 2  
HOUGHTON COUNTY, REGISTER 13:56  
LC 3/ 610 PAU Fee: 9.00  
Page 1 of 1

2. Property Controlling  
in Section

S T R

3. Miscellaneous  
Property in Sec.

S T R

Register of Deeds Stamp & File Number

4. Lot No. , Recorded Plat

5. Private Claims

I, Robert A. Goodreau in a field survey on September, 1998 do hereby state that under requirements of P.A. 74, Michigan P.A. of 1970, the corner points mentioned in lines 1 and 2 above were in conformance with regulations and rules therefore as required in the current manual of survey instructions of the United States Department of the Interior, Bureau of Land Management or by a decree of a Court of Law and for that the corner points mentioned in lines 3, 4 and 5 above were in conformance with the rules of the Michigan Board of Land Surveyors or by a Decree of a Court of Law; established, re-established, monumented, recovered, found as expressed below:

NOTE: Not more than 2 corners, all in the same town and range, may be recorded on this certificate.

|    | A | B  | C | D  | E | F  | G | H  | I | J  | K | L  | M |
|----|---|----|---|----|---|----|---|----|---|----|---|----|---|
| 1  |   |    |   |    |   |    |   |    |   |    |   |    |   |
| 2  |   | 6  |   | 5  |   | 4  |   | 3  |   | 2  |   | 1  |   |
| 3  |   |    |   |    |   |    |   |    |   |    |   |    |   |
| 4  |   | 7  |   | 8  |   | 9  |   | 10 |   | 11 |   | 12 |   |
| 5  |   |    |   |    |   |    |   |    |   |    |   |    |   |
| 6  |   | 18 |   | 17 |   | 16 |   | 15 |   | 14 |   | 13 |   |
| 7  |   |    |   |    |   |    |   |    |   |    |   |    |   |
| 8  |   | 19 |   | 20 |   | 21 |   | 22 |   | 23 |   | 24 |   |
| 9  |   |    |   |    |   |    |   |    |   |    |   |    |   |
| 10 |   | 30 |   | 29 |   | 28 |   | 27 |   | 26 |   | 25 |   |
| 11 |   |    |   |    |   |    |   |    |   |    |   |    |   |
| 12 |   | 31 |   | 32 |   | 33 |   | 34 |   | 35 |   | 36 |   |
| 13 |   |    |   |    |   |    |   |    |   |    |   |    |   |

A. Description of original monument and accessories and/or subsequent restoration:

H/I 9 Set Meander Post - 1845 by D. Houghton  
Fir, 9", N68°E, 32 LKS  
Fir, 8", S65°E, 21 LKS

No original evidence found.

B. Description of corner evidence found and/or method applied in restoring or reestablishing corner:

H/I 9 Found 4" Alm. Cap in concrete monument. Stamped. Mich. Cons. Department.  
Corner lies on south side of public access site and 16' ± from shore of Portage Lake.  
Accepted corner as found.

C. Description of monument for corner and accessories established to perpetuate locating the position of the corner:

H/I 9 Witness set with 60d nail, brass "UPEA" tags.  
Willow, 9", S45°W, 25.15'  
Sugar Maple, 12", N88°E, 41.84'  
Sugar Maple, 9", S08°E, 16.67'  
Boundary Sign for Public Access, N48°E, 1.50'  
Sugar Maple, 4", N12°W, 3.66'

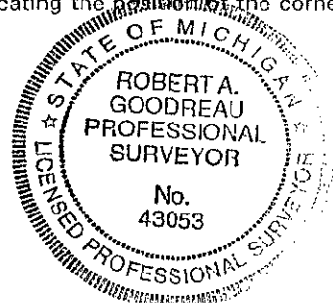

Signed by Robert A. Goodreau

Date 3-30-99

Surveyor's Michigan License No. 43053