

April 30, 1999
Robert A. Goodreau

LAND CORNER RECORDATION CERTIFICATE
Filing Requirement of Act 74, Mich. P.A. 1970

For corners in

Houghton
(County)

Located In: 34

Corner Code #

1. Public Land Survey T 54N R 33W H/I-13(30)
T R
T R
T R
2. Property Controlling S T R
in Section S T R
3. Miscellaneous S T R
Property in Sec. S T R

MARY SCHOOS 05/19/99 2
HOUGHTON COUNTY, REGISTER 13:56
LC 3/ 612 PAU Fee: 9.00
Page 1 of 1

Register of Deeds Stamp & File Number

4. Lot No. , Recorded Plat
5. Private Claims

I, Robert A. Goodreau in a field survey on September, 1998 do hereby state that under requirements of P.A. 74, Michigan P.A. of 1970, the corner points mentioned in lines 1 and 2 above were in conformance with regulations and rules therefore as required in the current manual of survey instructions of the United States Department of the Interior, Bureau of Land Management or by a decree of a Court of Law and /or that the corner points mentioned in lines 3, 4 and 5 above were in conformance with the rules of the Michigan Board of Land Surveyors or by a Decree of a Court of Law; established, re-established, monumented, recovered, found as expressed below:

NOTE: Not more than 2 corners, all in the same town and range, may be recorded on this certificate.

- A. Description of original monument and accessories and/or subsequent restoration:
H/I-13 Certificate of survey by John I. Haataja R.L.S. No. 19833 indicates meander corner. (#30)
SW Corner Gov't Lot 4. Set 3/4" capped iron pipe
Tag 16" spruce N2°E, 39.37'
Tag 6" spruce S55°E, 34.46'
Meander Post set 1845 by D. Houghton
Cedar 4" S66°E, 8 LKS

No original evidence found.

- B. Description of corner evidence found and/or method applied in restoring or reestablishing corner:
H/I-13 Found 3/4" pipe with cap #19833 approx. 8' ± from shore of Portage Lake.
Accepted corner as found.

- C. Description of monument for corner and accessories established to perpetuate locating the position of the corner:
H/I-13 Set 2" Brass remon cap on top of found pipe. No witnesses found. Witness set with 30" nail, brass "UPEA" tags.
Balsum Fir, 7", S05°E, 2.23'
Balsum Fir, 8", N10°W, 15.59'
Balsum Fir, 6", N63°E, 24.66'
Balsum Fir, 5", S59°E, 13.24'

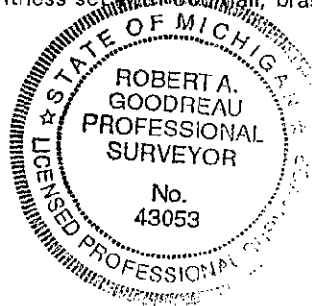

Signed by Robert A. Goodreau
Surveyor's Michigan License No. 43053

Date 3-30-99

	A	B	C	D	E	F	G	H	I	J	K	L	M
1													
2		6		5		4		3		2		1	
3													
4		7		8		9		10		11		12	
5													
6		18		17		16		15		14		13	
7													
8		19		20		21		22		23		24	
9													
10		30		29		28		27		26		25	
11													
12		31		32		33		34		35		36	
13													

MEANDER CORNER #30