

JAN 19 2001

SECTION

Re-Mon Liber 2, Page 105

2000 REMONUMENTATION
LAND CORNER RECORDATION CERTIFICATE
Filing Requirement of Act 74, Mich. P.A. 1970

For Corners in BINGHAM Township

Huron
(County)

Located in:

Corner Code #

1. Public Land Survey T 15N R 13E A - 8
T _____ R _____
T _____ R _____
T _____ R _____
T _____ R _____
2. Property Controlling S T _____ R _____
in Section S T _____ R _____
3. Miscellaneous S T _____ R _____
Property in Sec. S T _____ R _____

STATE OF MICHIGAN
HURON COUNTY
RECORDED

8 DEC 2000 9:57 AM

FRANCES L. HOLDWICK
REGISTER OF DEEDS

Register of Deeds Stamp & File Number

4. Lot No. _____, Recorded Plat _____
5. Private Claims _____

I, Russell L. Brown, in a field survey on June 9, 2000 do hereby state that under requirements of P.A. 74, Michigan P.A. of 1970, the corner points mentioned in lines 1 and 2 above were in conformance with regulations and rules therefore as required in the current manual of survey instructions of the United States Department of the Interior, Bureau of Land Management or by a decree of a Court of Law and/or that the corner points mentioned in lines 3, 4, and 5 above were in conformance with the rules of the Michigan Board of Land Surveyors or by a Decree of a Court of Law; established, re-established, monumented, recovered, found as expressed below:

NOTE: Not more than 2 corners, all in the same town and range, may be recorded on this certificate.

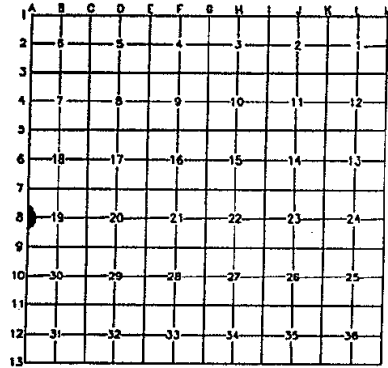

- A. Description of original monument and accessories and/or subsequent restoration:
1834 G.L.O. H. Parke D.S. Set quarter Section Post East side, Sec. 24, T15N-R12E, Lynn 10 S12W 31, Beech 10 N2W 18
COUNTY SURVEY RECORD - None
COUNTY ROAD COMMISSION RECORDS - Monument, Witnesses: Spike N. Side F.P., N83E 43.1', Spike N. Side F.P., N85W 62.7', 3/4" Iron in Monument Box, N45°W 85.70' Spike in Post, East 39.92' Capped Iron.
L.C.R.C. - None
RECORDED SURVEYS- 3-30-79, Case Surveying, Stewart G. Case P.S. 15399
E. 1/4 Cor. Sec. 24, T15N-R12E, Found 3/4" Iron Pin in Monument Box, WITNESS: Spike in S. Side T.P., N20°W 85.85', Spike in N. Side F. P., N80°E 43.70', 1/2" Iron Pin, N85°W 43.75'
UNRECORDED SURVEYS - None

- B. Description of corner evidence found and/or method applied in restoring or reestablishing corner:
No evidence of original corner or accessories found.

Found 3/4" Dia. Re-Rod in Monument Box.

Accepted 3/4" Dia. Re-Rod as best evidence of original corner position.

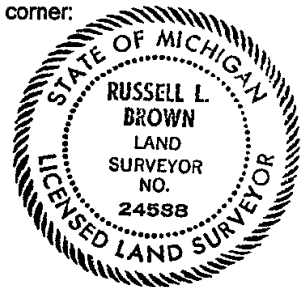

- C. Description of monument for corner and accessories established to perpetuate locating the position of the corner:
A - 8, W. 1/4 Cor. Sec. 19, T15N-R13E
Found 3/4" Dia. Re-Rod in Monument Box
WITNESSES:
East 39.94' to 1/2" Iron Capped 15399
N30°W 85.75' to Spike in S.W. Face Wood Post
N75°W 37.15' to Notch in S. end 18" C.M.P.
N45°W 50.80' to Notch in N. end 18" C.M.P.
South 2628.21', A-9, S.W. Cor. Sec. 19, T15N-R13E
North 2643.66', A-7, N.W. Cor. Sec. 19, T15N-R13E

NOTE:

This corner is common with
M-8, T15N-R12E

Signed by Russell L. Brown
Surveyor's Michigan License No. 24588

Date Nov. 9, 2000

Peer group approved at meeting held November 2, 2000. R.L.B.