

JAN 19 2001

SECTION

2000 REMONUMENTATION
LAND CORNER RECORDATION CERTIFICATE
Filing Requirement of Act 74, Mich. P.A. 1970

For Corners in VERONA Township

Huron
(County)

Located in:

Corner Code #

1. Public Land Survey

T 16N R 13E

A - 11

2. Property Controlling S
In Section S

T _____ R _____
T _____ R _____
T _____ R _____
T _____ R _____
T _____ R _____
T _____ R _____

3. Miscellaneous S
Property in Sec. S

4. Lot No. _____, Recorded Plat _____
5. Private Claims _____

I, Russell L. Brown, in a field survey on June 23, 2000 do hereby state that under requirements of P.A. 74, Michigan P.A. of 1970, the corner points mentioned in lines 1 and 2 above were in conformance with regulations and rules therefore as required in the current manual of survey instructions of the United States Department of the Interior, Bureau of Land Management or by a decree of a Court of Law and/or that the corner points mentioned in lines 3, 4, and 5 above were in conformance with the rules of the Michigan Board of Land Surveyors or by a Decree of a Court of Law; established, re-established, monumented, recovered, found as expressed below:

NOTE: Not more than 2 corners, all in the same town and range, may be recorded on this certificate.

A. Description of original monument and accessories and/or subsequent restoration:

1834 GLO H. Parke D.S. Set post corner Section 25 and 36, East side T16N-R12E,
Cedar 7 N34W 15; Hemlock 12 S33W 12

COUNTY SURVEYOR RECORD: None

COUNTY ROAD COMMISSION RECORD: Iron Pin; WITNESSES: Spike in F.P. S60°W 80.4'; Spike in F.P. N65°W 75.8'; Found P.K. Nail; WITNESSES: East 42.18' Spike in R.R. Tie Anchor Post; S45°W 64.20' Spike in R.R. Tie Fence Post; N45°W 55.23' Spike in Corner Post.

L.C.R.C.: None

RECORDED SURVEYS: Continued next page

UNRECORDED SURVEYS: None

B. Description of corner evidence found and/or method applied in restoring or reestablishing corner:

No evidence of original corner or accessories found.

Found 5/8" Re-Rod in Monument Box.

Accepted Found 5/8" Re-Rod as best evidence of original corner position.

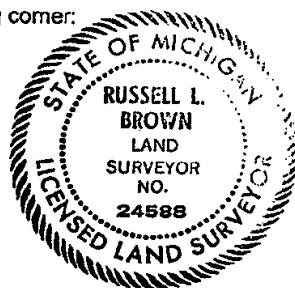

C. Description of monument for corner and accessories established to perpetuate locating the position of the corner:

A - 11, S.W. Corner Section 30, N.W. Corner Section 31, T16N-R13E

Found 5/8" Re-Rod in Monument Box

WITNESSES:

East 42.18' to Spike in N. Face of Fence Post

S45°W 64.20' to Spike in N.W. Face of Corner Post

N45°W 55.22' to Spike in S.W. Face of Corner Post

N45°E 27.08' to 1/2" Dia. Re-Rod Set

South 2617.34' A-12; S.W. Corner Section 30, T16N-R13E

North 2619.50' A-10; N.W. Corner Section 30, T16N-R13E

NOTE:

This corner is common with
M-11, T16N-R12E

Signed by Russell L. Brown
Surveyor's Michigan License No. 24588

Date Nov 2, 2000

Peer group approved at meeting held November 2, 2000. RLB

JAN 19 2001

SECTION

Re-Mon Liber 2, Page 122 A

2000 REMONUMENTATION
LAND CORNER RECORDATION CERTIFICATE
Filing Requirement of Act 74, Mich. P.A. 1970

For Corners in VERONA Township

Huron County, T16N-R13E
A - 11 Continued

RECORDED SURVEY:

5-27-77, Case Surveying, Stewart G. Case P.S. 15399, Liber 3 Surveys, page 241 of Huron County Records.
Found $\frac{3}{4}$ " Pin in place, raised with 1" Pipe

WITNESSES:

Spike in N.E. side of Cedar Post, N40°W 60.04'
Spike in N.W. side of Corner Fence Post, S65°W 54.3'
Spike in N. Side Corner Fence Post, S75°E 42.5'

5-3-78, Case Surveying, Stewart G. Case P.S. 15399, Liber 3 Surveys, Page 559 of Huron County Records.
S.W. Cor. Frac. Sec. 30, T16N-R13E,
Found Monument Box in Place

WITNESSES:

Spike in N.E. Side of Cedar Post, N40°W 60.04'
Spike in N.W. Side of Corner Fence Post, S65°W 54.30'
Spike in N. Side of Corner Fence Post S75°E 42.5'

