

Re-Mon, Liber 1, Page 178

REMONUMENTATION

LAND CORNER RECORDATION CERTIFICATE
Filing Requirement of Act 74, Mich. P.A. 1970

For corners in

| Huron (County) | Located In: | Corner Code # |
|------------------------------------|----------------|---------------|
| 1. Public Land Survey Sand Beach | T16N R15E | 1 (01-01) |
| | T___ R___ | _____ |
| | T___ R___ | _____ |
| | T___ R___ | _____ |
| 2. Property Controlling in Section | S___ T___ R___ | _____ |
| | S___ T___ R___ | _____ |
| 3. Miscellaneous Property in Sec. | S___ T___ R___ | _____ |
| | S___ T___ R___ | _____ |

STATE OF MICHIGAN
HURON COUNTY
RECORDED

25 NOV 98 10:09 A.M.

FRANCES L. HOLDWICK
REGISTER OF DEEDS

Register of Deeds Stamp & File Number

4. Lot No. _____, Recorded Plat _____
5. Private Claims _____

I, Charles S. Getz, in a field survey on Nov. 12, 1998 do hereby state that under requirements of P.A. 74, Michigan P.A. of 1970, the corner points mentioned in lines 1 and 2 above were in conformance with regulations and rules therefore as required in the current manual of survey instructions of the United States Department of the Interior, Bureau of Land Management or by a decree of a Court of Law and /or that the corner points mentioned in lines 3, 4 and 5 above were in conformance with the rules of the Michigan Board of Land Surveyors or by a Decree of a Court of Law; established, re-established, monumented, recovered, found as expressed below:

NOTE: Not more than 2 corners, all in the same town and range, may be recorded on this certificate.

| | | | | | | | | | | | | |
|----|---|----|---|----|---|----|---|----|---|----|---|----|
| 1 | A | B | C | D | E | F | G | H | I | J | K | L |
| 2 | | 6 | | 5 | | 4 | | 3 | | 2 | | 1 |
| 3 | | | | | | | | | | | | |
| 4 | | 7 | | 8 | | 9 | | 10 | | 11 | | 12 |
| 5 | | | | | | | | | | | | |
| 6 | | 19 | | 17 | | 16 | | 15 | | 14 | | 13 |
| 7 | | | | | | | | | | | | |
| 8 | | 19 | | 20 | | 21 | | 22 | | 23 | | 24 |
| 9 | | | | | | | | | | | | |
| 10 | | 30 | | 29 | | 28 | | 27 | | 26 | | 25 |
| 11 | | | | | | | | | | | | |
| 12 | | 31 | | 32 | | 33 | | 34 | | 35 | | 36 |
| 13 | | | | | | | | | | | | |

A. Description of original monument and accessories and/or subsequent restoration:

| | |
|----------------------------------|---|
| Meander Corner | County Surveyor Records - NONE |
| 1834 G.L.O., H. Parke D.S. | |
| Set post on border of Lake Huron | County Road Commission Records - Meander Post |
| W Ash 10", N46°W, 23 Links | "X" in 1/2 Yd. Stone |
| B. Ash 12", S26½°W, 12 Links | |
| | Recorded Surveys - NONE |
| | Unrecorded Surveys - NONE |
| L.C.R.C. - NONE | |

SURVEY &
REMONUMENTATION

JAN 28 1999

B. Description of corner evidence found and/or method applied in restoring or reestablishing corner:

SECTION

GLO Meander Cor, Section 1, T16N-R15E
Original GLO Meander Corner position is inaccessible, due to Lake Huron
Set Witness Corner to GLO Meander Corner
Used SW Cor, Section 36, T17N-R15E and existing 5/8" Iron Bar in
Old U.S. 25 for line.
(On Rapson Road)

C. Description of monument for corner and accessories established to perpetuate locating the position of the corner:

Witness Cor to GLO Meander Cor, Section 1, T16N-R15E
Set 1/2" Re-Rod (Capped)
East 76.70' to Recorded Position of GLO Meander Cor
S85°E 15.00' to Road Sign
South 35.60' to Nail in 24" Ash
S45°W 44.60' to Nail in 12" Ash
S70°W 92.10' to Nail in 36" Ash
West 489.30' to 5/8" Iron Bar in N&S Gravel Road
West 2167.30' to SW Cor, Sec 36, T17N-R15E

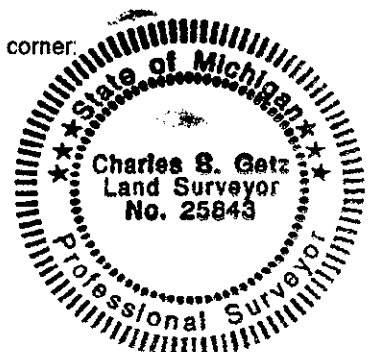

Signed by Charles S. Getz
Surveyor's Michigan License No. 25843

Date November 15, 1998

PEER GROUP APPROVED AT

MEETING 11-24-98 R2L13