

Re-Mon. Liber 2, Page 45

1999 REMONUMENTATION
LAND CORNER RECORDATION CERTIFICATE
Filing Requirement of Act 74, Mich. P.A. 1970

For Corners in PORT AUSTIN Township

Huron
(County)

Located in: Corner Code #

1. Public Land Survey T 19N R 12E 1
T-----R-----
T-----R-----
T-----R-----
2. Property Controlling S
in Section S T-----R-----
3. Miscellaneous S T-----R-----
Property in Sec. S T-----R-----

STATE OF MICHIGAN
HURON COUNTY
RECORDED

30 DEC 99 2:17 P.M.

FRANCES L. HOLDWICK
REGISTER OF DEEDS

Register of Deeds Stamp & File Number

4. Lot No. _____, Recorded Plat _____
5. Private Claims _____

SECTION

I, Russell L. Brown, in a field survey on Dec. 21, 1999 do hereby state that under requirements of P.A. 74, Michigan P.A. of 1970, the corner points mentioned in lines 1 and 2 above were in conformance with regulations and rules therefore as required in the current manual of survey instructions of the United States Department of the Interior, Bureau of Land Management or by a decree of a Court of Law and/or that the corner points mentioned in lines 3, 4, and 5 above were in conformance with the rules of the Michigan Board of Land Surveyors or by a Decree of a Court of Law; established, re-established, monumented, recovered, found as expressed below:

1	A	B	C	D	E	F	G	H	I	J	K	L	M
2		6		5		4		3		2		1	
3													
4		7		8		9		10		11		12	
5													
6		18		17		16		15		14		13	
7													
8		19		20		21		22		23		24	
9													
10		30		29		28		27		26		25	
11													
12		31		32		33		34		35		36	
13													

NOTE: Not more than 2 corners, all in the same town and range, may be recorded on this certificate.

A. Description of original monument and accessories and/or subsequent restoration:

Meander Corner

1834 G.L.O. H. Parke D.S. Set post on border of Lake Huron; Pine 9 N29E 48; Do. 12 S59 1/2W 86

County Surveyors Records - None

County Road Commission Records - None

L.C.R.C. - None

Recorded Surveys - None

Unrecorded Surveys - None

B. Description of corner evidence found and/or method applied in restoring or reestablishing corner:

Original meander corner position is inaccessible due to Saginaw Bay.

Set 1/2" x 18" Steel Stake capped P.S. 24588 Witness corner to original meander corner position by extending line from K-13 through J-13 West to Shore of Saginaw Bay, G.L.O. measurement (3009.60')

C. Description of monument for corner and accessories established to perpetuate locating the position of the corner:

Witness Corner to G.L.O. Meander Corner

Set 1/2" x 18" Steel Stake capped P.S. 24588

WITNESSES:

West 8.80' to Spike in North Side 38" maple

S20°E 29.30' to Spike in East Side 28" Pine

S85°E 96.77' to 3/4" Pipe at Easterly corner of lots 429 and 430 Port Austin Heights Subdivision No. 1

N30°E 34.95' to Spike in Easterly Side of 12" Oak

East 253.54' to J-13, South 1/4 Corner Section 35, T19N-R12E

West 116.06' to G.L.O. Meander Corner Position

East 3009.60' to K-13, South Corner Sections 35 and 36, T19N-R12E

Signed by Russell L. Brown
Surveyor's Michigan License No. 24588

Date DEC. 27, 1999

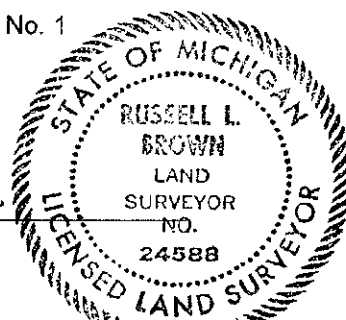

Peer group approved at meeting held 12-27-99, RLB