

1993

COMMISSION

For corners in

Iron

(County)

Located In:

Corner Code ##

- |                                    |   |            |   |            |            |
|------------------------------------|---|------------|---|------------|------------|
| 1. Public Land Survey              | T | <u>42N</u> | R | <u>35W</u> | <u>K-3</u> |
|                                    | T |            | R |            |            |
|                                    | T |            | R |            |            |
|                                    | T |            | R |            |            |
| 2. Property Controlling in Section | S |            | T | R          |            |
|                                    | S |            | T | R          |            |
| 3. Miscellaneous Property in Sec.  | S |            | T | R          |            |
|                                    | S |            | T | R          |            |

4. Lot No. \_\_\_\_\_, Recorded Plat \_\_\_\_\_
5. Private Claims \_\_\_\_\_

Section Corner 1-2-11-12 T42N R35W

I, Gary L. Pisoni, in a field survey on December 20, 1993, do hereby certify that under requirements of P.A. 74, Michigan P.A. of 1970, the corner points mentioned in lines 1 and 2 above were in conformance with regulations and rules therefore as required in the current manual of survey instructions of the United States Department of the Interior, Bureau of Land Management or by a decree of a Court of Law and/or that the corner points mentioned in lines 3, 4 and 5 above were in conformance with the rules of the Michigan Board of Land Surveyors or by a Decree of a Court of Law; established, re-established, monumented, re-monumented, recovered, found as expressed below:

NOTE: Not more than 4 corners, all in the same town and range, may be recorded on this certificate.

A. Description of original monument and accessories and/or subsequent restoration:

Original corner established by Harvey Mellen, U.S. Deputy Surveyor in 1851.

Original corner: Wood Post

Original bearing trees:

Sugar Maple	12"	N 65° E	15 links ( 9.90 feet)
Sugar Maple	16"	S 35° W	17 links (11.22 feet)

B. Description of corner evidence found and/or method applied in restoring or reestablishing corner:

No evidence of original corner or bearing tree remains. Corner position found marked by a concrete plat monument. Plat monument being part of the Brady Estates sub-division of Caspian and also located at a fence corner. Replaced plat monument with an aluminum pipe monument as described below. Monument is 2" below ground surface.

This corner is accepted as the best available evidence of the position of the original corner.

C. Description of monument for corner and accessories established to perpetuate locating the position of the corner:

At the corner position, I set a 2" diameter by 30" long split base aluminum pipe monument with a 3" cast aluminum cap, stamped to read: Iron County Remonumentation, T42N, R35W, S-2, S-1, S-11, S-12, 1993, RLS 27457; from which I established the following new blazed and scribed bearing trees; (all measurements taken to a nail in side of tree)

Fire Hydrant		N 42° E	66.32 feet
Basswood	6"	S 78° E	79.75 feet
Sugar Maple	11"	N 52° W	94.20 feet
Sugar Maple	12"	N 28° W	72.17 feet
Steel Sign Post		South	4.74 feet

IRON COUNTY  
MICHIGAN  
RECEIVED FOR RECORD

93 DEC 29 PM 2:20

L.C. RECORDS L.6 P.242

*Gilbert Stetson*  
REGISTER OF DEEDS

Register of Deeds Stamp & File Number

	A	B	C	D	E	F	G	H	I	J	K	L	M
2	6	5	4	3	2	1							
3													
4	7	8	9	10	11	12							
5													
6	18	17	16	15	14	13							
7													
8	19	20	21	22	23	24							
9													
10	30	29	28	27	26	25							
11													
12	31	32	33	34	35	36							
13													

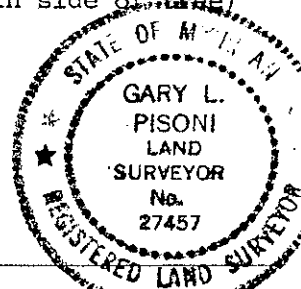

Signed by Gary L. Pisoni  
Surveyor's Michigan License No. 27457

Date 12-28-93