

LAND CORNER RECORDATION CERTIFICATE  
Filing Requirement of Act 74, Mich. P.A. 1970 as Amended

For corners in

Iron (County)	Located In:	Corner Code #
1. Public Land Survey	T _____ R _____ T _____ R _____ T _____ R _____	_____ _____ _____
2. Property Controlling in Section	S 4 T 44N R 32W S 4 T 44N R 32W S _____ T _____ R _____	12 F2 _____
3. Miscellaneous Property in Sec.	S _____ T _____ R _____ S _____ T _____ R _____	_____ _____
4. Lot No. _____, Recorded Plat		
5. Private Claims		

Register of Deeds Stamp & File Number

1	A	B	C	D	E	F	G	H	I	J	K	L	M
2		6		5				3		2		1	
3													
4		7		8		9		10		11		12	
5													
6		18		17		16		15		14		13	
7													
8		19		20		21		22		23		24	
9													
10		30		29		28		27		26		25	
11													
12		31		32		33		34		35		36	
13													

I, Stephan J. Szyszkoski, in a field survey on 12 10/31/2011 do hereby state  
that under requirements of P.A. 74, Michigan P.A. of 1970, the corner points mentioned in lines 1 and 2  
above were in conformance with regulations and rules therefore as required in the current manual of survey  
instructions of the United States Department of the Interior, Bureau of Land Management or by a decree of  
a Court of Law and /or that the corner points mentioned in lines 3, 4 and 5 above were in conformance with  
the rules of the Michigan Board of Land Surveyors or by a Decree of a Court of Law; established,  
re-established, monumented, recovered, found as expressed below:

NOTE: Not more than 2 corners, all in the same town and range, may be recorded  
on this certificate.

A. Description of original monument and accessories and/or subsequent restoration:

(12-Sec. 4) South 1/16 corner of Section 4. Not previously monumented.

(F2) Center of Section 4. Not previously monumented.

B. Description of corner evidence found and/or method applied in restoring or reestablishing corner:

(12-Sec. 4) Established the corner position midway and on a straight line between Quarter corner  
1318.10' south and Center of Section 4 1318.10' north.

(F2) Established the corner position at the intersection of straight lines connecting opposite 1/4  
corners.

C. Description of monument for corner and accessories established to perpetuate locating the position of the corner:

(12) Set 1"IDx32" I.pipe with 4" alum. MDNR cap.  
Set measuring nail with MDNR tag in the side of:  
20" Sugar N12E 8.05' mrkd "1/16S BT"  
12" Sugar S75E 13.0' do  
11" Sugar South 25.35' do  
14" Maple S86W 4.4' do  
Set sq'd cedar post adjacent.  
Bearings are magnetic.

(F2) Set 1"IDx32" I.pipe with 4" alum. MDNR cap.  
Set measuring nail with MDNR tag in the side of:  
6" Sugar N79E 7.1' mrkd "C1/4 BT"  
5" Sugar S31E 20.0' do  
10" Sugar S46W 22.7' do  
10" Sugar N18W 14.3' do  
Set sq'd cedar post adjacent.  
Bearings are magnetic.

Signed by Stephan J. Szyszkoski  
Surveyor's Michigan License No. 33986

Date 01/11/2012

For the Michigan Department of Natural Resources, Forest Management Division

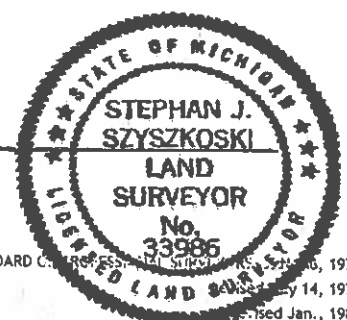

16788

16789