

\$7.00  
\$2.00 SEP 13 1995

COMMISSION

LAND CORNER RECORDATION CERTIFICATE  
Filing Requirement of Act 74, Mich. P.A. 1970  
KENT COUNTY REMONUMENTATION

For corners in

Kent  
(County)

Located in:

Corner Code #

1. Public Land Survey

T 5N R 12W E-11

2. Property Controlling  
in Section

S T R

3. Miscellaneous  
Property in Sec.

S T R

4. Lot No. , Recorded Plat

5. Private Claims

REC. OF DEEDS

8594

95 AUG 28 AM 10:50

STATE OF MICHIGAN  
COUNTY OF KENT  
RECEIVED FOR RECORD

Register of Deeds Stamp & File Number

I, Randy Kolehose, in a field survey on April 11 19 95,  
do hereby certify that under requirements of P.A. 74 Michigan P.A. of 1970, the corner points  
mentioned in lines 1 and 2 above were in conformance with regulations and rules therefore as required  
in the current manual of survey instructions of the United States Department of the interior, Bureau of  
Land Management or by a decree of a Court of Law and/or that the corner points mentioned in lines 3,  
4 and 5 above were in conformance with the rules of the Michigan Board of Land Surveyors or by a  
Decree of a Court of Law; established, re-established, monumented, re-monumented, recovered,  
found as expressed below:

NOTE: Not more than 4 corners, all in the same town and range, may be recorded  
on this certificate.

A. Description of original monument and accessories and/or subsequent restoration:

E-11	1831	G.L.O. Notes	Mullett	Set Post
	1945	Wit. Map	K.C. Surveyor	1 1/2" Iron
	1972	L.C.R.C. #212	Exxel Engineering	Fnd. Square Sp./set 1" Solid Iron
	1972	L.C.R.C. #320	Williams & Works	Set Bt. Spk. by Wits per K.C.R.C.
	1981	L.C.R.C. #1636	Nederveld & Jonker	Fnd. 1" Square Iron/Set K.C. Monument
	1988	L.C.R.C. #4617	Olson, Meyers & May	K.C. Monument

P.A. 345 1990 KENT COUNTY

PEER APPROVED 5/25/95  
CHAIRMAN [Signature]

This corner was originally approved by the Kent County Remonumentation Peer Group and monumented by Nederveld & Jonker on 4/9/81 and was recorded per L.C.R.C. #L.C.R.C. #1636.

B. Description of corner evidence found and/or method applied in restoring or reestablishing corner:

E-11 Found standard Kent County Monument 2.5' South of the C/L of 100th Street running E-W and on the C/L of Ivanrest Avenue running N-S per L.C.R.C.'s #1636 and #4617 as set by Nederveld & Jonker in place of a 1" square iron they found which checked L.C.R.C. #212.

L.C.R.C. #1636

L.C.R.C. #4617

Nail & Remon. tag on NE side 16" Apple S25°E 106.30'  
Nail & Remon. tag on NW side guy pole N40°E 47.60'  
NE corner house fnd. S45°W 107.95'  
Centerline "X" of B.T. is N 2.8'

Nail & Remon. tag on NE sde 18" Apple S 25 E 106.30'  
Nail & Remon tag on NW sde guy pole N 40 E 47.60'  
Nail & Remon tag on S sde P pole S 75 W 68.43'  
NE cor hse fndn S 45 W 107.95'  
On C/L bit rd N & S  
C/L bit rd E & W is N 2.8'

The selected location is accepted by me and is generally accepted by professional surveyors as the best available evidence of the position of the original corner.

C. Description of monument for corner and accessories established to perpetuate locating the position of the corner:

E-11 Standard Kent County Monument

Nail & K.C. remon. tag on NE side 24" Apple S 25° E 106.30'  
Nail & K.C. remon. tag on NW side Guy pole N 40° E 47.60'  
Nail & K.C. remon. tag on S side P. pole S 75 W 68.43'  
NE cor. hse. fndn. S 45° W 107.81'  
Nail & K.C. remon. tag on NE side 12" Elm S 20° E 115.50'

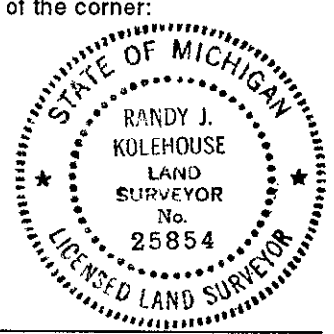

Signed by Randy J. Kolehose  
EARTH TECH

Date 8/21/95

Surveyor's Michigan License No. 25854