

FEB 14 1997

KENT COUNTY REMONUMENTATION

COMMISSION

LAND CORNER RECORDATION CERTIFICATE
Filing Requirement of Act 74, Mich. P.A. 1970

For corners in
KENT COUNTY
(County)

Located In:

Corner Code #

1. Public Land Survey

T _____ R _____
T _____ R _____
T _____ R _____
T _____ R _____

2. Property Controlling
in Section

S 2 T 8N R 11W
S _____ T _____ R _____

3. Miscellaneous
Property in Section

S _____ T _____ R _____
S _____ T _____ R _____

Wit. Mon. on
E-W 1/4 line
Sec. 2

9103

Register of Deeds Stamp & File Number

4. Lot No. _____, Recorded Plat _____

5. Private Claims _____

I, **Kirk Breitels**

, in a field survey on **Jan. 16**, 19 **96**

do hereby certify that under requirements of P.A. 74, Michigan P.A. of 1970, the corner points mentioned in lines 1 and 2 above were in conformance with regulations and rules therefore as required in the current manual of survey instructions of the United States Department of the Interior, Bureau of Land Management or by a decree of a Court of Law and/or that the corner points mentioned in lines 3, 4 and 5 above were in conformance with the rules of the Michigan Board of Professional Surveyors or by a Decree of a Court of Law; established, re-established, monumented, re-monumented, recovered, found as expressed below:

NOTE: Not more than 4 corners, all in the same town and range, may be recorded on this certificate.

A. Description of original monument and accessories and/or subsequent restoration:

1837	GLO	Not set
1879-1960	Williams & Works	Set and used Leaded Stone, <u>198' West</u> of the East 1/4 corner of Sec. 2, T8N, R11W
1975	Kistler & Assoc.	Witnesses to corner found and used
1990	LCRC #5306 - Bueche	Set Kent County Witness Monument

The position of this corner was previously approved by the Kent County Remonumentation Peer Group, monumented (Witness Monument) by John C. Bueche on 2/13/90 and was recorded per LCRC #5306.

B. Description of corner evidence found and/or method applied in restoring or reestablishing corner:

Found Standard Kent County Witness Monument per witnesses from above LCRC as set by John C. Bueche in place of the Leaded Stone he found. Said Leaded Stone checks with information from Williams & Works and Kistler & Assoc.

LCRC #5306

Nail & KC Remon. tag SW side 10" Elm	S40°E	60.44'
Nail & KC Remon. tag W. side 8' dia. Box Elder	S60°E	145.30'
Nail & KC Remon. tag W. side Power Pole	N40°E	149.51'
Nail & KC Remon. tag S. side Power Pole	N65°W	42.20'
West of river - East 145'±		
C/L RR tracks - West 200'±		

P.A. 345 1990 KENT COUNTY

PEER APPROVED 3/7/96
CHAIRMAN Harry Hubert

The selected location is accepted by me and is generally accepted by professional surveyors as the best available evidence of the corner.

C. Description of monument for corner and accessories established to perpetuate locating the position of the corner:

Standard Kent Co. Witness Monument (witnesses by EDM)

New Nail & KC Remon. tag SW side 14" Elm	S40°E	60.38'
New Nail & KC Remon. tag W. side 8' dia. Box Elder	S60°E	144.98'
Nail & KC Remon. tag W. side Power Pole	N40°E	149.54'
Nail & KC Remon. tag S. side Power Pole	N65°W	42.24'
West of river - East 145'±		
C/L old RR bed - West 200'±		

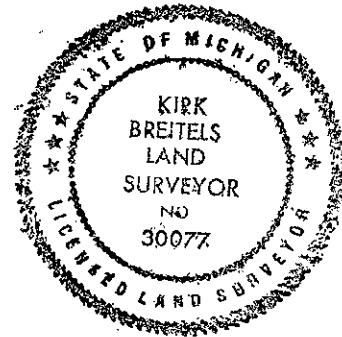

Signed by

Kirk Breitels

Date

2/6/96

Surveyor's Michigan License No.

30077

FORM APPROVED BY MICHIGAN STATE BOARD OF PROFESSIONAL SURVEYORS, JAN. 23, 1971
REVISED MAY 14, 1975
REVISED JAN., 1983