

SURVEY &
REMONUMENTATION
SEP 18 1995

COMMISSION

KENT COUNTY REMONUMENTATION

LAND CORNER RECORDATION CERTIFICATE
Filing Requirement of Act 74, Mich. P.A. 1970

For corners in
KENT COUNTY
(County)

Located In:

Corner Code #

1. Public Land Survey

T _____ R _____
T _____ R _____
T _____ R _____
T _____ R _____

Other Code

#2

2. Property Controlling
in Section

S 6 T 8N R 12W

Wit. Mon. on

S. line

3. Miscellaneous

S _____ T _____ R _____

Sec. 6

Property in Section

S _____ T _____ R _____

4. Lot No. _____, Recorded Plat _____

5. Private Claims _____

STATE OF MICHIGAN
COUNTY OF KENT
RECEIVED FOR RECORD
95 AUG 29 AM 10:38
REG. OF DEEDS
8680

Register of Deeds Stamp & File Number

I, Kirk Breitels, in a field survey on July 31, 19 95,

do hereby certify that under requirements of P.A. 74, Michigan P.A. of 1970, the corner points mentioned in lines 1 and 2 above were in conformance with regulations and rules therefore as required in the current manual of survey instructions of the United States Department of the Interior, Bureau of Land Management or by a decree of a Court of Law and/or that the corner points mentioned in lines 3, 4 and 5 above were in conformance with the rules of the Michigan Board of Professional Surveyors or by a Decree of a Court of Law; established, re-established, monumented, re-monumented, recovered, found as expressed below:

NOTE: Not more than 4 corners, all in the same town and range, may be recorded on this certificate.

A. Description of original monument and accessories and/or subsequent restoration:

1837 GLO Brookfield Meander Corner Set
1992 LCRC #6574 Marshall Set Kent Co. Witness Mon.
S. line Sec. 6

The position of this corner was previously approved by the Kent County Remonumentation Peer Group, monumented by Chris Marschall on 10/9/92 and was recorded per LCRC #6573.

B. Description of corner evidence found and/or method applied in restoring or reestablishing corner:

Found Standard Kent Co. Witness Mon. (Harrison) per witnesses from above LCRC as set by Chris Marschall at the described location.

LCRC #6574

P.A. 345 1995 KENT COUNTY

PEER APPROVED 8/24/95

CHAIRMAN Chris Marschall

T.B. of pond 10' more or less South
W. edge of pond extended N. West 3' more or less
Centerline of mowed path W. 30' more or less
Beginning of swamp W. 40' more or less
Nail & KC Remon. tag NW side fence post S45°W 2.04'
Nail & KC Remon. tag N. side fence post N80°E 13.93'
SW corner of plowed field N70°E 50' ±
Pond is approx. 100' E & W and 200' N & S more or less

C. Description of monument for corner and accessories established to perpetuate locating the position of the corner:

Standard Kent Co. Witness Monument

T.B. of pond 5' ± South
W. edge of pond extended N. West 3' ±
Centerline of mowed path W. 30' ±
Beginning of swamp W. 40' ±
Nail & KC Remon. tag NW side fence post S45°W 2.04'
Nail & KC Remon. tag N. side fence post N80°E 13.93'
SW corner of plowed field N70°E 50' ±
Set Nail & KC Remon. tag W. side 16" Poplar N10°E 46.67'
Pond is approx. 100' E & W and 200' N & S more or less

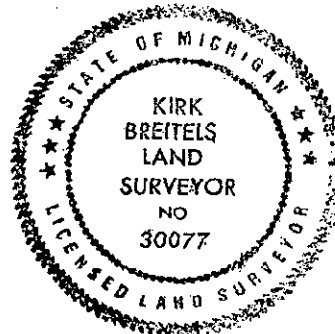

Signed by

Kirk Breitels

Date

8/24/95

Surveyor's Michigan License No. 30077

FORM APPROVED BY MICHIGAN STATE BOARD OF PROFESSIONAL SURVEYORS, JAN. 28, 1971
REVISED MAY 14, 1975
REVISED JAN., 1983