

KENT COUNTY REMONUMENTATION

LAND CORNER RECORDATION CERTIFICATE Filing Requirement of Act 74, Mich. P.A. 1970

STATE OF MICHIGAN
COUNTY OF KENT
RECEIVED FOR RECORD
1999 MAR 24 AM 8:03

REG. OF DEEDS

11200

Register of Deeds Stamp & File Number

For corners in

KENT COUNTY
(County)

Located in:

Corner Code #

1. Public Land Survey

T10N R12W M-2 Tyrone Twp.
T R Common
T10N R11W A-2 Solon Twp.

2. Property Controlling
in Section

S T R
S T R
S T R
S T R

3. Miscellaneous
Property in Sec.

4. Lot No. , Recorded Plat
5. Private Claims

I, Kirk Breittels, in a field survey on Feb. 9, 1999 do hereby state that under requirements of P.A. 74, Michigan P.A. of 1970, the corner points mentioned in lines 1 and 2 above were in conformance with regulations and rules therefore as required in the current manual of survey instructions of the United States Department of the Interior, Bureau of Land Management or by a decree of a Court of Law and/or that the corner points mentioned in lines 3, 4 and 5 above were in conformance with the rules of the Michigan Board of Land Surveyors or by a Decree of a Court of Law, established, re-established, monumented, recovered, found as expressed below:

NOTE: Not more than 2 corners, all in the same town and range, may be recorded on this certificate.

	A	B	C	D	E	F	G	H	I	J	K	L	M
1													
2		6	5	4	3	2	1						
3													
4		7	8	9	10	11	12						
5													
6		19	17	16	15	14	13						
7													
8		19	20	21	22	23	24						
9													
10		30	29	28	27	26	25						
11													
12		31	32	33	34	35	36						
13													

A. Description of original monument and accessories and/or subsequent restoration:

M-2 1837	GLO	Brookfield	Set Post
	Kent Co. Wits		Iron
1986	LCRC #4497	Hackbardt	Vertical Flat Steel Iron
1986	LCRC #4451	Kolehouse	Set Kent County Monument
1991	LCRC #6038	Byl	Kent County Monument

P.A. 345 1990 KENT COUNTY

PEER APPROVED 2/25/99
CHAIRMAN Randy J. Kolehouse

The position of this corner was previously approved by the Kent County Remonumentation Peer Group, monumented by Randy J. Kolehouse on 4-5-86 and was recorded per LCRC #4451.

B. Description of corner evidence found and/or method applied in restoring or reestablishing corner:

M-2 Found Kent County Monument (Harrison) per witnesses from above LCRC as set by Randy J. Kolehouse in place of the 1/2" x 3" Leaf Spring he found. Said Leaf Spring checks with Kent Co. Wits. and LCRC #4497.

LCRC #4451	Nail & Remon. tag 18" Pine N30°W 33.89'
Nail & N & J tag 14" Pine N30°W 35.80'	Nail & Remon. tag 18" Pine S55°E 59.97'
Nail & N & J tag 16" Pine S55°E 60.00'	Nail & N & J tag 12" Cherry S20°W 13.35'
Nail & N & J tag 12" Cherry S20°W 13.42'	Nail & Remon. tag 8" Elm S00°W 17.27'
Corner fence post North 33'	Nail & Remon. tag 6" Maple N60°E 40.44'

C/L trail to N. is 20' E. ±

The selected location is accepted by me and is generally accepted by professional surveyors as the best available evidence of the position of the original corner.

C. Description of monument for corner and accessories established to perpetuate locating the position of the corner:

M-2 Standard Kent County Monument	N30°W 33.89'
Nail & KC Remon. tag SW side 20" Pine	S55°E 60.01'
Nail & KC Remon. tag SW side 24" Pine	S20°W 13.35'
Nail & N & J tag E. side 12" stump	S00°W 17.27'
Nail & KC Remon. tag W. side 8" Elm	N60°E 40.48'
Nail & KC Remon. tag SE side 8" Maple	
On C/L old E-W road bed ±	
C/L trail to N. is 20' E. ±	

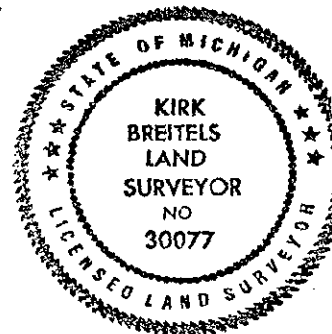

Signed by

Kirk Breittels

Date

2/25/99

Surveyor's Michigan License No.

30077