

**SURVEY &
REMONUMENTATION**

MAY 22 2000

KENT COUNTY REMONUMENTATION

LAND CORNER RECORDATION CERTIFICATE
Filing Requirement of Act 74, Mich. P.A. 1970

For corners in

KENT COUNTY

(County)

Located In:

Corner Code #

1. Public Land Survey

T R
T R
T R
T R

**2. Property Controlling
in Section**

S 2 T 10N R 12W

**3. Miscellaneous
Property in Sec.**

S T R
S T R

Wit. Mon. on
E-W 1/4 Line
(Tyrone Twp.)

4. Lot No. , Recorded Plat

5. Private Claims

I, Kirk Breitels, in a field survey on Nov. 2, 19 99 do hereby state that under requirements of P.A. 74, Michigan P.A. of 1970, the corner points mentioned in lines 1 and 2 above were in conformance with regulations and rules therefore as required in the current manual of survey instructions of the United States Department of the Interior, Bureau of Land Management or by a decree of a Court of Law and /or that the corner points mentioned in lines 3, 4 and 5 above were in conformance with the rules of the Michigan Board of Land Surveyors or by a Decree of a Court of Law; established, re-established, monumented, recovered, found as expressed below:

NOTE: Not more than 2 corners, all in the same town and range, may be recorded on this certificate.

A. Description of original monument and accessories and/or subsequent restoration:

No Information

B. Description of corner evidence found and/or method applied in restoring or reestablishing corner:

Established location on E-W 1/4 line (S. line of NE 1/4)

Computed C 1/4 corner at Intersection of 1/4 lines falls in Rogue River

1999.92' to E 1/4 corner

645.37' to C 1/4 corner (computed)

The above location is accepted by me and is generally accepted by professional surveyors as the best available evidence of the position of the Witness Corner.

C. Description of monument for corner and accessories established to perpetuate locating the position of the corner:

Set Kent County Witness Monument as described above

Nail & KC Remon. tag N. side 12" Birch	N65°W 33.66'
Nail & KC Remon. tag E. side 12" Poplar	N15°E 54.07'
Nail & KC Remon. tag W. side 16" Poplar	S50°W 34.06'
Nail & KC Remon. tag S. side 24" Tree	S70°E 27.80'

REG. OF DEEDS

1999 DEC 15 AM 8:57

STATE OF MICHIGAN
COUNTY OF KENT
RECEIVED FOR RECORD

"other" corner # 2

11611

Register of Deeds Stamp & File Number

	A	B	C	D	E	F	G	H	I	J	K	L	M
1													
2		6		5		4		3		2		1	
3													
4		7		8		9		10		11		12	
5													
6		18		17		16		15		14		13	
7													
8		19		20		21		22		23		24	
9													
10		30		29		28		27		26		25	
11													
12		31		32		33		34		35		36	
13													

P.A. 345 1990 KENT COUNTY

PEER APPROVED 12/6/99

CHAIRMAN Harry Huber

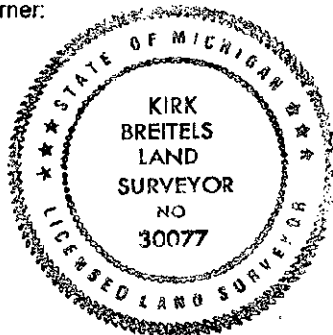

Signed by Kirk Breitels

Date 12/6/99

Surveyor's Michigan License No. 30077