

APR 01 1996

KALAMAZOO COUNTY REMONUMENTATION

LAND CORNER RECORDATION CERTIFICATE

Filing Requirement of Act 74, Mich. P.A. 1970

STATE OF MICHIGAN  
COUNTY OF KALAMAZOO  
RECEIVED FOR RECORD

'95 NOV 17 AM 9 38

9- COMMISSION

For corners in  
KALAMAZOO

(County)

Located In:

Corner Code #

1. Public Land Survey  
CORNER COMMON TO ROSS  
AND RICHLAND TOWNSHIPS  
ON BASE LINE

2. Property Controlling  
in Section

3. Miscellaneous  
Property in Sec.

4. Lot No. , Recorded Plat

5. Private Claims

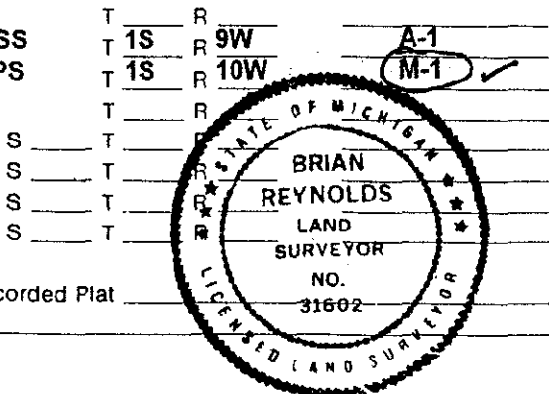

*James J. [Signature]*  
CLERK-REGISTER

LIBER 1 1383

Register of Deeds Stamp & File Number

T1S, R9W	A	B	C	D	E	F	G	H	I	J	K	L	M	T1S, R10W
2	6	5	4	3	2	1								
3														
4	7	8	9	10	11	12								
5														
6	18	17	16	15	14	13								
7														
8	19	20	21	22	23	24								
9														
10	30	29	28	27	26	25								
11														
12	31	32	33	34	35	36								
13														

BRIAN REYNOLDS

OCTOBER 26

95

I, BRIAN REYNOLDS, in a field survey on OCTOBER 26, 1995, do hereby certify that under requirements of P.A. 74, Michigan P.A. of 1970, the corner points mentioned in lines 1 and 2 above were in conformance with regulations and rules therefore as required in the current manual of survey instructions of the United States Department of the Interior, Bureau of Land Management or by a decree of a Court of Law and/or that the corner points mentioned in lines 3, 4 and 5 above were in conformance with the rules of the Michigan Board of Land Surveyors or by a Decree of a Court of Law; established, re-established, monumented, re-monumented, recovered, found as expressed below:

NOTE: Not more than 4 corners, all in the same town and range, may be recorded on this certificate.

A. Description of original monument and accessories and/or subsequent restoration:

1. TOWNSHIP CORNER ESTABLISHED BY GENERAL LAND OFFICE DEPUTY SURVEYOR JOHN MULLETT, 1826  
W. OAK 8 S35W 19 Do. 16 S31 1/2E 24 (VOL5, P2 & VOL6, P23)
2. F. HODGEMAN, KALAMAZOO COUNTY SURVEYOR, NOVEMBER 1883, "FOUND OLD STAKE HOLE IN LINE OF FENCE 180 LINKS WEST OF STAKE AT INTERSECTION OF ROADS FOR 1/4 POST SEC. 31, T1N R9W. NO WITNESSES TO TOWNSHIP CORNER. BORED 3 FT PUT BRICK IN BOTTOM AND 2 FT EARTHEN POST OVER AND MARKED Y. OAK 8" DI. S85°W 32LKS BK. WALNUT 4" N84°E 147" (V2, PP10-11)
3. E. STRONG, KALAMAZOO COUNTY SURVEYOR, SHOWN AS TILE 1.80 CHAINS W. OF IRON AT APPARENT INTERSECTIONS OF ROAD CENTERLINES, NO WITNESSES (V3, P118)
4. PLAT OF WOODLAWN, SEC 31, T1N R9W, DATED APRIL 1, 1909, SURVEYED BY E. STRONG, SHOWS TOWNSHIP CORNER 118.8 FEET WEST OF S 1/4 CORNER OF SEC. 31, AND ON LINE WITH APPARENT MEANDER POST AT EAST SHORE OF GULL LAKE. NOT WITNESSED. (L1 OF BARRY CO. PLATS, P71)

SEE REVERSE OF THIS FORM FOR ADDITIONAL HISTORICAL DATA

B. Description of corner evidence found and/or method applied in restoring or reestablishing corner:

EXCAVATED THROUGH 3" OF BITUMINOUS ROADWAY AND A PREVIOUS SEAL-COAT SURFACE, AND THROUGH 3+/- FEET OF GRAVEL, 118.8 FEET WEST OF A FOUND IRON AT S1/4 CORNER OF SEC 31, T1N R9W, AS INDICATED IN THE WILKINS & WHEATON SURVEY, FOUND NOTHING. IT APPEARS CERTAIN THAT THE TILE PLACED BY HODGEMAN WAS DESTROYED BY SEWER CONSTRUCTION. RESTORED POSITION OF IRON ON BASE LINE AT EAST SHORE OF GULL LAKE, BY BEARING AND DISTANCE FROM THE FOUND IRONS SHOWN AS BEING 33 FEET SOUTH OF BASE LINE ON THE WILKINS & WHEATON SURVEY, 1967, THEN PLACED THE HARRISON MONUMENT AND MONUMENT BOX ON RESTORED BASE LINE AND 118.80 FEET WEST OF STANDARD CORNER. ALL 3 WALNUT WITNESSES BY GOVE (BUDZIK) REMAIN, BUT NAILS ARE LONG GROWN OVER. CHECKED DISTANCE FROM CENTER OF ALL WALNUTS, IN EACH CASE THE DISTANCE FELL NEAR THE CENTER OF THE MONUMENT. ACCEPTED THIS AS BEST METHOD OF RESTORING THE POSITION OF THE TILE SET BY HODGEMAN, AND PERPETUATED BY WILKINS AND WHEATON, AND GOVE (BUDZIK).

SEE REVERSE OF THIS FORM FOR RELATIVE POSITION OF CORNERS

RATIFIED  
BY KALAMAZOO COUNTY  
REMONUMENTATION  
PEER GROUP  
11-16-95

C. Description of monument for corner and accessories established to perpetuate locating the position of the corner:

SET STANDARD KALAMAZOO COUNTY REMONUMENTATION MONUMENT (HARRISON) IN MONUMENT BOX  
SET 20d NAIL WITH PLASTIC TAG IN THE NORTH ROOT OF A 28" BLACK WALNUT S71°E 67.08'  
SET 20d NAIL WITH PLASTIC TAG IN THE WEST SIDE OF A 16" BLACK WALNUT N29°E 20.76'  
SET 20d NAIL WITH PLASTIC TAG IN THE EAST SIDE OF A 12" BLACK WALNUT N37°W 23.65'  
NORTHEAST CORNER OF A FRAME RESIDENTIAL BUILDING S04°E 76.48'  
SOUTHWEST CORNER OF A FRAME GARAGE S29°E 78.57' CENTERLINE OF EAST-WEST BITUMINOUS ROADWAY IS SOUTH 3+/-  
B-13 T-1N, R-8-W, BARRY TOWNSHIP, BARRY COUNTY, S89°40'30"E 118.80' (BARRY COUNTY REMON IRON)

Signed by

Date

Surveyor's Michigan License No.

31602

PART "A" (CONTINUED)

- 5. PLAT OF "HICKORY POINT", 1902, (L6 OF PLATS, P30) BY E. STRONG, KALAMAZOO COUNTY SURVEYOR, CORNER IS INDICATED AS 180 (LINKS) WEST OF B-13, T1N R9W, APPARENTLY NOT WITNESSED.
- 6. PLAT OF "NEW PLAT OF HICKORY POINT", 1923, (L9 OF PLATS, P31) BY GLEN WHEATON, CORNER INDICATED AS 118.8' WEST OF B-12, T1N R9W, NO MONUMENT OR WITNESSES RECITED.
- 7. ACT 132 SURVEY BY (L1 OF SURVEYS, P348) BY JOHN M. BUDZIK, PS #18982, GOVE ASSOCIATES INC.  
IRON OVER TILE IN MON. BOX. 12" WALNUT N70°E 56.94'; 16" WALNUT S60°E 68.12'; 10" WALNUT N40°W 46.75'
- 8. UNRECORDED SURVEY BY WILKINS & WHEATON, SEPTEMBER 14, 1967, UPDATE JUNE 12, 1985, OF PART OF LOT 1 OF "NEW PLAT OF HICKORY POINT" INDICATES TOWNSHIP CORNER IS ON LINE BETWEEN B-13 T1N R9W AND AN IRON AT THE SHORE OF GULL LAKE, PLAT DISTANCE 118.80' WEST OF B-13, MEASURED DISTANCE 118.78', NOT WITNESSED.
- 9. TOPOGRAPHIC SURVEY OF A SECTION OF BASE LINE ROAD, 1991, BY WILKINS & WHEATON, CORNER SYMBOL INDICATED IN PROPER PLACE, CORNER NOT LABELED OR WITNESSED.

LIBER 1 1384

