

APR 01 1996

COMMISSION

LAND CORNER RECORDATION CERTIFICATE

Filing Requirement of Act 74, Mich. P.A. 1970

STATE OF MICHIGAN  
COUNTY OF KALAMAZOO  
RECEIVED FOR RECORD

'95 DEC 8 AM 10 55

For corners in

Kalamazoo  
(County)

Located In:

Corner Code #

Climax Twp.

1. Public Land Survey T 3S R 9W C12  
T R  
T R  
T R  
2. Property Controlling S T R  
in Section S T R  
3. Miscellaneous S T R  
Property in Section S T R
4. Lot No. , Recorded Plat  
5. Private Claims

*James Young*  
CLERK-REGISTER

LIBER 1 1388

Register of Deeds Stamp & File Number

I, Gary D. Hahn, in a field survey on July 21, 19 95, do hereby certify that under requirements of P.A. 74, Michigan P.A. of 1970, the corner points mentioned in lines 1 and 2 above were in conformance with regulations and rules therefore as required in the current manual of survey instructions of the United States Department of the Interior, Bureau of Land Management or by a decree of a Court of Law and/or that the corner points mentioned in lines 3, 4 and 5 above were in conformance with the rules of the Michigan Board of Professional Surveyors or by a Decree of a Court of Law; established, re-established, monumented, re-monumented, recovered, found as expressed below:

**NOTE:** Not more than 4 corners, all in the same town and range, may be recorded on this certificate.

A. Description of original monument and accessories and/or subsequent restoration:

1826 Quarter post established by U.S. Deputy Surveyor Robert Clark, Jr.  
Sugar 9in. S42°W 12½ lks. Beech 16in. N52°E 13½ lks.

1875 F. Hodgman Co. Sur. "Found stone from witnesses. Set marked stone."

1883 F. Hodgman Co. Sur. "Found stone of former survey. Set 3 ft. earthen post and marked." Beech 6' di. N44°E 33¼ lks. Beech 6" di. N47°W 23¼ lks.

B. Description of corner evidence found and/or method applied in restoring or reestablishing corner:

Original monument and accessories not recovered.  
Hodgman's stone not recovered.

Found railroad rail protruding from ground 3'. Rail is used as a post for a wire fence running to the west. Dug a 4' dia. 3' deep hole around rail removing very large tightly packed rocks as we dug. Found three 6" to 8" long broken (but still cylindrical) sections of tile in various locations amongst the rocks. Believe to have found remains of all three sections of tile set by Hodgman. Rail is leaning slightly to the west.

**RATIFIED**  
**BY KALAMAZOO COUNTY**  
**REMONUMENTATION**  
**PEER GROUP**

C. Description of monument for corner and accessories established to perpetuate locating the position of the corner: 9-21-95

C12, East quarter corner Section 31, T3S, R9W, Ratified by Kalamazoo County Remonumentation Peer Group on September 21, 1995. Railroad rail is accepted as the best available evidence of the position of the original corner. Since railroad rail can not be easily removed it will remain as the monument for this corner. Witness ties below go to the east side of the rail at its base.

Set P.K. nail in 18" Maple N8°W 15.51'  
Set P.K. nail in 12" Locust N80°E 26.69'  
Set P.K. nail in 15" Maple West 20.33'  
Set P.K. nail in 11" Hickory South 8.76'

Signed by

Surveyor's Michigan License No. 38116

Date September 23, 1995

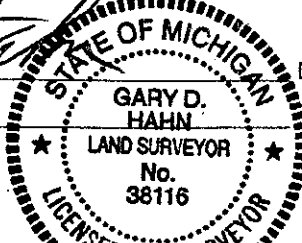

FORM APPROVED BY MICHIGAN STATE BOARD OF PROFESSIONAL SURVEYORS, JAN. 28, 1971  
REVISED MAY 14, 1975  
REVISED JAN., 1983