

LAND CORNER RECORDATION CERTIFICATE
Filing Requirement of Act 74, Mich. P.A. 1970

For corners in
KALAMAZOO

Located In:

Corner Code ##

1. Public Land Survey

T 3S R 12W

M-9

T R

T R

T R

T R

2. Property Controlling
in Section

S T R

S T R

3. Miscellaneous

S T R

Property in Sec.

S T R

Register of Deeds Stamp & File Number

4. Lot No. , Recorded Plat

5. Private Claims

I, GARY C. BILOW, in a field survey on AUGUST 15, 19 90, do hereby certify that under requirements of P.A. 74, Michigan P.A. of 1970, the corner points mentioned in lines 1 and 2 above were in conformance with regulations and rules therefore as required in the current manual of survey instructions of the United States Department of the Interior, Bureau of Land Management or by a decree of a Court of Law and/or that the corner points mentioned in lines 3, 4 and 5 above were in conformance with the rules of the Michigan Board of Land Surveyors or by a Decree of a Court of Law; established, re-established, monumented, re-monumented, recovered, found as expressed below:

NOTE: Not more than 4 corners, all in the same town and range, may be recorded on this certificate.

A. Description of original monument and accessories and/or subsequent restoration:

CORNER POST ESTABLISHED BY U.S. GOVERNMENT DEPUTY SURVEYOR WM. BROOKFIELD, 1827. ACCESSORIES: W. OAK 16 S27W 1.34, W. OAK 6 N18W S.61. RECORD 6LO FALLING FROM SW CORNER SECTION 19, T3S-R11W TO M-9 IS NORTH 4 LINKS. NO RECORD OF PERPETUATION FOUND.

	A	B	C	D	E	F	G	H	I	J	K	L	M
2	6		5		4		3		2		1		
3													
4	7		8		9		10		11		12		
5													
6	18		17		16		15		14		13		
7													
8	19		20		21		22		23		24		
9													
10	30		29		28		27		26		25		
11													
12	31		32		33		34		35		36		
13													

B. Description of corner evidence found and/or method applied in restoring or reestablishing corner:

ORIGINAL CORNER POST AND ACCESSORIES NOT RECOVERED. FOUND 1/2" REBAR IN MONUMENT BOX 2.64' NORTH OF SOUTHWEST CORNER SECTION 19 (A-9) T3S-R11W AS RECORDED ON LCRC L. 1, P. 487. THE DESIGNATION OF THIS MONUMENT AS M-9 IS IN CONFLICT WITH 1) APPARENT ACCEPTANCE OF THIS POSITION AS A-9 BY THE MICHIGAN STATE HIGHWAY DEPARTMENT (PROJECT 39013RN, BOOK 5 OF B, PAGE 6 AND RIGHT-OF-WAY MAP FOR US-131 CONTROL SECTION 39013, SHEET 7); 2) BEARINGS AND DISTANCES SHOWN ON THE RECORDED PLATS OF "STAGECOACH TRAILS NO. 1" (LIBER 31 OF PLATS, PAGE 3) AND "STAGECOACH TRAILS NO. 2" (LIBER 33 OF PLATS PAGE 27) WHICH APPEAR TO SUPPORT THIS MONUMENT AS BEING ACCEPTED BY OTHERS AS A-9. 3) THE LOCATION OF THE WEST 1/4 CORNER OF SECTION 19 T3S-R11W (A-8). A-8 BEING FOUND EQUIDISTANT BETWEEN THIS MONUMENT AND A-7. SEE ALSO RECORDATION CERTIFICATE ALSO FILED THIS DATE FOR A-9, T3S-R11W. NO ATTEMPT WAS MADE ON MY PART TO RESOLVE THIS CONFUSED CORNER. AT THIS TIME, I NEITHER ACCEPT NOR REJECT THE MONUMENTATION FOUND AS OCCUPYING THE LOCATION OF M-9.

C. Description of monument for corner and accessories established to perpetuate locating the position of the corner:

FOUND 1/2" REBAR IN MONUMENT BOX

SOUTH 2.64' FOUND 1/2" REBAR PREVIOUSLY RECORDED AS SOUTHWEST CORNER SECTION 19, T3S-R11W

N59W 69.36' SET NAIL AND MICHIGAN DEPARTMENT OF NATURAL RESOURCES 1/2" S. FACE LIGHT POLE

N43E 38.39' SET NAIL AND MONR TAG IN W. FACE 8" CHINESE ELM

S23E 56.68' SET NAIL AND MONR TAG IN WEST FACE 8" CHINESE ELM

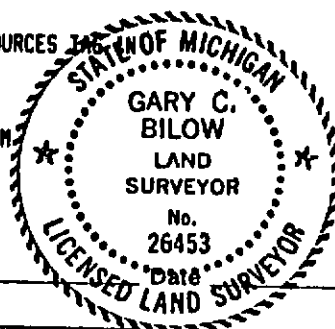

Signed by Gary C. Bielow

Surveyor's Michigan License No. 26453

2/8/91