

MAR 23 2000

REMONUMENTATION

RECEIVED FOR RECORD

99 DEC 23 AM 9:13

SECTION

LAND CORNER RECORDATION CERTIFICATE  
Filing Requirement of Act 74, Mich. P.A. 1970

Melissa DeVaugh  
REGISTER OF DEEDS  
LAPEER COUNTY, MICHIGAN

For corners in

Lapeer  
(County)

Located in:  
Hadley Township

Corner Code #

1. Public Land Survey

	T6N	R9E	I-1
	T	R	
	T	R	
	T	R	
	T	R	
S	T	R	
S	T	R	
S	T	R	
S	T	R	

2. Property Controlling  
in Section

3. Miscellaneous  
Property in Sec.

4. Lot No. \_\_\_\_\_ Recorded Plat \_\_\_\_\_  
5. Private Claims \_\_\_\_\_

I, Huston K. Kennedy, in a field survey on August 5, 1999 do hereby state that under requirements of P.A. 74, Michigan P.A. of 1970, the corner points mentioned in lines 1 and 2 above were in conformance with regulations and rules therefore as required in the current manual of survey instructions of the United States Department of the Interior, Bureau of Land Management or by a decree of a Court of Law and/or that the corner points mentioned in lines 3, 4 and 5 above were in conformance with the rules of the Michigan Board of Land Surveyors or by a Decree of a Court of Law, established, re-established, monumented, recovered, found as expressed below:

NOTE: Not more than 2 corners, all in the same town and range, may be recorded on this certificate.

	A	B	C	D	E	F	G	H	I	J	K	L	M
1													
2	6		5		4		3		2		1		
3													
4	7		8		9		10		11		12		
5													
6	18		17		16		15		14		13		
7													
8	19		20		21		22		23		24		
9													
10	30		29		28		27		26		25		
11													
12	31		32		33		34		35		36		
13													

- A. Description of original monument and accessories and/or subsequent restoration:  
1817-GLO Wampler, D.S.; Set Post 15" White Oak N59°W 50 Links; 12" White Oak S74°E 38 Links  
1.) 1995-Kennedy, PS #17623; LCRC for (I-13 Elba Twp.) L.0005, Pg.0232 - Set 1/2" Iron Rod encased in a 4" diameter concrete cylinder 36" long w/2" diameter brass cap stamped Lapeer County Remonumentation, #17623  
2.) 1978-Henderson, PS #16043; Survey L.4, Pg.954 - Corner falls in Lake Lapeer  
3.) 1980-Pangus, PS #21578; Survey L.005, Pg.922 - Corner falls in Lake Lapeer  
4.) 1998-Hay, PS #41101; Survey L.0012, Pg.0575 - Fnd a 1/2" Iron  
(Con't on back side)
- B. Description of corner evidence found and/or method applied in restoring or reestablishing corner:  
1999-Kennedy Surveying, Inc. - Kennedy, PS #17623 - Fnd a 1/2" Iron Rod 6 feet South of the existing centerline of Stewart Road extending to the West and Northeast, which has a gravel surface and 177 feet East of the existing centerline of Lakehill Drive extending to the South, which has a bituminous surface. Corner common to Sections 34 & 35, T7N, R9E, Elba Township (I-13) is located 268.46 feet to the East. I-1 as found is 1.43 feet South of the town line.

Witnesses from Survey #4, unrecorded Survey #6 and the found monumentation in "LAKE LAPEER ESTATES NO. 4" were used to recover and verify the location of the found 1/2" Iron Rod.

I accepted the found 1/2" Iron Rod as the best evidence of the original corner position.

FIELD MEASUREMENTS BETWEEN

I-1 to H-1  
No GLO  
No recorded distances  
2662.77 Ft. (MEA 1999)

I-1 to I-13  
GLO = 56 links or 36.96 Ft.  
268.46 Ft. (MEA 1999)

I-1 to J-1  
No GLO, corner falls in Lake Lapeer  
No recorded distances  
2618.98 Ft. (CAL)

- C. Description of monument for corner and accessories established to perpetuate locating the position of the corner:  
I-1 I replaced the found 1/2" Iron Rod with a 1/2" x 24" Iron Rod w/2" diameter brass cap stamped Lapeer County Remonumentation, #17623  
N08°E 49.00' Set Mag Nail & Remon Washer NW face 6" Poplar  
Due South 61.21' NE corner of house #3027  
S42°E 57.49' Set Mag Nail & Remon Washer NE face 6" Hickory  
S48°W 37.64' Set Mag Nail & Remon Washer SE face 48" Oak  
East 268.46 feet corner common to Sections 34 & 35, T7N, R9E, Elba Twp. (I-13)

The selected location is accepted by me and is generally accepted by Professional Surveyors as the best available evidence of the position of the original corner.

Signed by: Huston K. Kennedy  
Surveyor's Michigan License No. 17623

Date 11-19-99

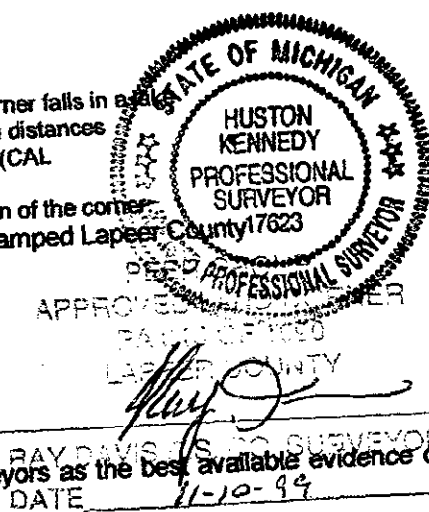

- 5.) 1999-Powell, PS #44298; Survey L.0013, Pg.0130 -- Fnd a 1/2" Iron Rod, used same wit as 1998 Survey
- 6.) 1995-Gravelin, PS #23510; Unrecorded Survey -- Fnd a 1/2" Iron Rod, used same wit as 1998 Survey
- 7.) 1971 "LAPEER LAKE ESTATES NO. 6" Liber 5, page 44

SURVEY &  
REMONUMENTATION

MAR 23 2000

SECTION

FIELD	9.00
REMO	ROUTE
REMO	2.00