

SURVEY & REMONUMENTATION

FEB 26 2001

SECTION

LAND CORNER RECORDATION CERTIFICATE Filing Requirement of Act 74, Mich. P.A. 1970

FILED

For corners in

LIVINGSTON

(County)

Located In:

Corner Code #

1. Public Land Survey

T 1 N R 4 E

E-07

2. Property Controlling
in Section

S
S

T R
T R

3. Miscellaneous
Property in Sec.

S
S

T R
T R

2000 SEP 28 1A 9:17

NANCY HAVILAND
REGISTER OF DEEDS
LIVINGSTON COUNTY, MI.
48843

LSC #1272m

Register of Deeds Stamp & File Number

4. Lot No. _____, Recorded Plat _____

5. Private Claims _____

I, JACK K. SMITH, in a field survey on AUGUST 25, 2000, do hereby state that under requirements of P.A. 74, Michigan P.A. of 1970, the corner points mentioned in lines 1 and 2 above were in conformance with regulations and rules therefore as required in the current manual of survey instructions of the United States Department of the Interior, Bureau of Land Management or by a decree of a Court of Law and /or that the corner points mentioned in lines 3, 4 and 5 above were in conformance with the rules of the Michigan Board of Land Surveyors or by a Decree of a Court of Law; established, re-established, monumented, recovered, found as expressed below:

NOTE: Not more than 2 corners, all in the same town and range, may be recorded on this certificate.

A	B	C	D	E	F	G	H	I	J	K	L	M
1												
2	6		5		4		3		2		1	
3												
4	7		8		9		10		11		12	
5												
6	18		17		16		15		14		13	
7												
8	19		20		21		22		23		24	
9												
10	30		29		28		27		26		25	
11												
12	31		32		33		34		35		36	
13												

A. Description of original monument and accessories and/or subsequent restoration:

GLO 1825 JOSEPH WAMPLER SET POST
BLACK OAK 14" S48°W 13.20'
BLACK OAK 18" S36 1/2°E 33.00'

B. Description of corner evidence found and/or method applied in restoring or reestablishing corner:

THE EXISTING CORNER IS A 3/4" IRON PIPE ROUGHLY ON LINE WITH A TREE ROW TO THE NORTH AND WITH LIGHT OCCUPATION TO THE EAST AND APPROXIMATELY 45' NORTH OF THE OLD RAILROAD RIGHT OF WAY FENCE.

C. Description of monument for corner and accessories established to perpetuate locating the position of the corner:

E-07 SOUTHWEST CORNER SECTION 16, T1N, R4E, PUTNAM TOWNSHIP, LIVINGSTON COUNTY, MICHIGAN:
SET 1 1/4" X 36" STEEL PIPE WITH LIVINGSTON COUNTY REMONUMENTATION BRASS CAP STAMPED WITH SURVEYOR #35999 IN PLACE OF THE 3/4" IRON PIPE APPROXIMATELY 63.3' SOUTH OF CENTERLINE OF A POWER LINE.

S15°E SPIKE AND REMON TAG ON WEST SIDE OF A 24" OAK
S50°W SPIKE AND REMON TAG ON NORTH SIDE OF A 20" OAK
N05°W SPIKE AND REMON TAG ON WEST SIDE OF A 6" OAK
N85°W SPIKE AND REMON TAG ON WEST SIDE OF A 18" POPLAR
APPROXIMATELY 63.3' SOUTH OF CENTERLINE OF POWER LINE

28.37'
48.90'
164.37'
118.90'

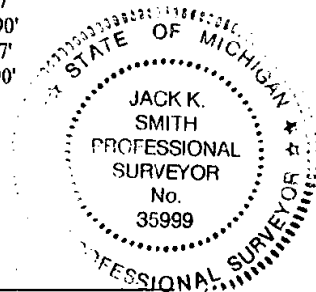

Signed by

Date

Surveyor's Michigan License No. 35999

P.A. 345 1990, APPROVED BY LIVINGSTON COUNTY

PEER GROUP ON 2-16-2000 CO. REP JED

FORM APPROVED BY MICHIGAN STATE BOARD OF PROFESSIONAL SURVEYORS, JAN. 28, 1971

REVISED MAY 14, 1975

REVISED JAN., 1983

REVISED OCT., 1995