

SURVEY &
REMONUMENTATION

APR 28 1995

COMMISSION

For corners in
Livingston
(County)

LAND CORNER RECORDATION CERTIFICATE

Filing Requirement of Act 74, Mich. P.A. 1970

NANCY HAVILAND
REGISTER OF DEEDS
LIVINGSTON COUNTY, MI
48843

Nov 16 2 06 PM '94

Located In: Corner Code #

1. Public Land Survey T 1N R 5E C-11
T R
T R
T R
2. Property Controlling S T R
in Section S T R
3. Miscellaneous S T R
Property in Sec. S T R

L.S.C. #371m

Register of Deeds Stamp & File Number

4. Lot No. , Recorded Plat
5. Private Claims

I, Bryan Boss, in a field survey on 11-3, 19 94,
do hereby certify that under requirements of P.A. 74, Michigan P.A. of 1970, the corner points mentioned
in lines 1 and 2 above were in conformance with regulations and rules therefore as required in the
current manual of survey instructions of the United States Department of the Interior, Bureau of Land
Management or by a decree of a Court of Law and/or that the corner points mentioned in lines 3, 4 and 5
above were in conformance with the rules of the Michigan Board of Land Surveyors or by a Decree of a
Court of Law; established, re-established, monumented, re-monumented, recovered, found as
expressed below:

NOTE: Not more than 4 corners, all in the same town and range, may be recorded
on this certificate.

A. Description of original monument and accessories and/or subsequent restoration:

Post set in pond no witnesses

Additional data on back.

B. Description of corner evidence found and/or method applied in restoring or reestablishing corner:

West reference point set by Christopher Newman R.L.S. #24607 on Act 74 L.S.C. #
1573. South reference point Oscar Boss Survey, certified land survey no. 1124
- Liber 661 Page 21.

C. Description of monument for corner and accessories established to perpetuate locating the position of the corner:

WEST 331.34' MEANDER CORNER:

Set 1 1/2" x 36" iron pipe with brass cap marked Livingston County Monument WIT.
Corner. 20' ± West of Lake;

North 50.35' N&T E/S 12" Elm
S10°E 38.92' N&T E/S 12" Tri-Maple
N80°W 21.67' N&T S/S 15" Oak
S40°W 18.47' N&T E/S 21" Oak

SOUTH 304.78' MEANDER CORNER:

Set 1 1/2" x 36" iron pipe with brass cap marked Livingston County Monument
50' ± South of Lake;

N5°W 17.62' N&T W/S 26" Box Elder
N50°W 19.66' N&T S/S 8" Hickory
S10°W 28.78' N&T W/S 30" Twin Oak
S55°E 16.61' N&T SW/S 4" Pine

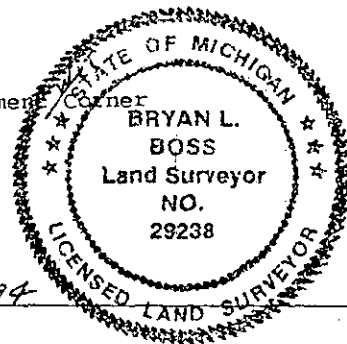

Signed by Bryan L. Boss

Date 11-10-1994

Surveyor's Michigan License No. 29238

FORM APPROVED BY MICHIGAN STATE BOARD OF LAND SURVEYORS, JAN. 28, 1971

P.A. 345 1990, APPROVED BY LIVINGSTON COUNTY

NOTED GROUP ON 19 Oct 94 CO. SET

REVISED MAY 14, 1975
REVISED JAN., 1983

TIN-R5E

C-11

Page 1

SUMMARY
C-11

NORTHWEST CORNER, SECTION 32, T1N-R5E HAMBURG TOWNSHIP,
LIVINGSTON COUNTY, MICHIGAN.

This corner falls into Bullhead Lake. 1823 field notes (page 7) calls for post set in pond.

On August 6, 1969, Clay Gordon survey (page 8) places Northwest corner Section 32 into lake.

On January 18, 1972, Boss Engineering survey (pages 9, 10) shows corner approximately 495 feet West and approximately 210 feet North of shoreline of lake.

On 9-10-90 Christopher Newman survey and Act 74 (pages 12, 13) calls for corner in lake. Newman Survey states that the Section Corner was established from Boss Survey (Pages 9 and 10).

On June 26, 1991 David Finney set a traverse point 40 feet ± South of South shoreline of Bullhead Lake (page 14, 15).

Marvin Fouty platted "Rivendell" and set a meander corner 10 feet ± East of lake (see page 16 this Dossier).

On 12-15-93, Boss Engineering utilized Tri-County Surveys reference point on line to B-11 for survey (page 17) and witnesses (page 18).

Conclusion: We recommend accepting reference point set by Christopher Newman found on Act 74 (page 13 this Dossier) at a distance of 331.34 feet Westerly from the Corner. We also recommend accepting intermediate Traverse Point set by Oscar Boss found on survey (page 10 this Dossier) at a distance of 304.78 feet Southerly from the corner and reference point East at meander corner 10 feet ± East of shoreline as found on the Plat of "Rivendell", Liber 26, pages 41-43, Livingston County Records. The aforementioned reference points shall have 4 Witnesses and will give future descriptions an exact location of the Northwest Corner of Section 32, Hamburg Township.

HSUMC-11

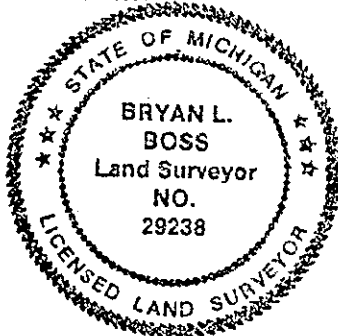

Bryan L. Boss