

OCT 26 1995

COMMISSION

LAND CORNER RECORDATION CERTIFICATE

Filing Requirement of Act 74, Mich. P.A. 1970

For corners in

Livingston

(County)

Located In:

Corner Code =#

- Public Land Survey T 1N R 5E K-9
T R
T R
T R
- Property Controlling S T R
in Section S T R
- Miscellaneous S T R
Property in Sec. S T R

L.S.C. #472m

Register of Deeds Stamp & File Number

OCT 6 11 56 AM '95
HAROLD HAMILTON
REGISTER OF DEEDS
LIVINGSTON COUNTY, MI
60843

FILED

- Lot No. , Recorded Plat
- Private Claims

I, Bryan Boss, in a field survey on 8-23, 19 95, do hereby certify that under requirements of P.A. 74, Michigan P.A. of 1970, the corner points mentioned in lines 1 and 2 above were in conformance with regulations and rules therefore as required in the current manual of survey instructions of the United States Department of the Interior, Bureau of Land Management or by a decree of a Court of Law and/or that the corner points mentioned in lines 3, 4 and 5 above were in conformance with the rules of the Michigan Board of Land Surveyors or by a Decree of a Court of Law; established, re-established, monumented, re-monumented, recovered, found as expressed below:

NOTE: Not more than 4 corners, all in the same town and range, may be recorded on this certificate.

	A	B	C	D	E	F	G	H	I	J	K	L	M
2	6	5	4	3	2	1							
3													
4	7	8	9	10	11	12							
5													
6	18	17	16	15	14	13							
7													
8	19	20	21	22	23	24							
9													
10	30	29	28	27	26	25							
11													
12	31	32	33	34	35	36							
13													

A. Description of original monument and accessories and/or subsequent restoration:

White Oak 19" N 24½ E 17 links
White Oak 13" S 42 W 75 links
Black Oak 8" S 71 3/4 E 1.07½ chains
Hard Maple 14" N 52 W .79 chains

B. Description of corner evidence found and/or method applied in restoring or reestablishing corner:

Found iron pipe in monument box two feet +/-
South of centerline M-36 Highway
N 49 W 52.26' 22" Maple
N 2 W 27.93' 6" Walnut
S 56 E 29.40' 5" W. Cherry
South 24.80' Fence Post

C. Description of monument for corner and accessories established to perpetuate locating the position of the corner:

Set Brass Cap on 1/2" pipe in monument box
28.22' North nail & tag west side 15" walnut
38.61' South nail & tag west side fence post
53.12' N45°W nail & tag southwest side 30" maple
129.02' N75°W nail & tag south side 28" maple

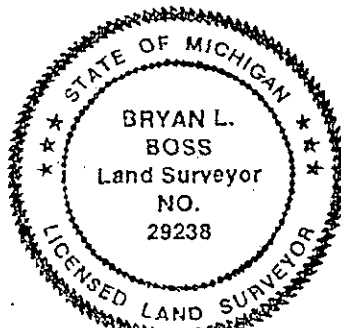

Signed by Bryan L. Boss

Date Oct 4, 1995

Surveyor's Michigan License No. 29238

FORM APPROVED BY MICHIGAN STATE BOARD OF LAND SURVEYORS, JAN. 28, 1971
REVISED MAY 14, 1975
REVISED JAN., 1993

P.A. 345 1990, APPROVED BY LIVINGSTON COUNTY
PEER GROUP ON 5-3-95 CO. REP JED

SUMMARY
K-9

Northwest Corner, Section 25, T1N-R5E, Hamburg Township, Livingston County, Michigan.

Found iron pipe in Monument box 2 feet ± South of Centerline M-36 Highway. This corner is open for G.P.S.

On page 11 this dossier, Grant H. Dunning witnessed to a hard maple 14" N52°W .79 chains in 1909. This witness agrees with Munsell surveys on 4/1956 and 6/1960. It also agrees with witness #1 on page 7.

Allen Rentschler R.L.S. #15411 found iron pipe (see page 17), on 10-8-80, Jack Erickson R.L.S. #16929 placed Monument Box around pipe (see page 18). Surveys by Tri-County and Boss Engineering also utilized same pipe in monument box.

Conclusion:

We find the iron pipe in Monument Box to be at the same location as found by Lyle Munsell in 1956 and recommend it's acceptance as found.

HAMK-9S

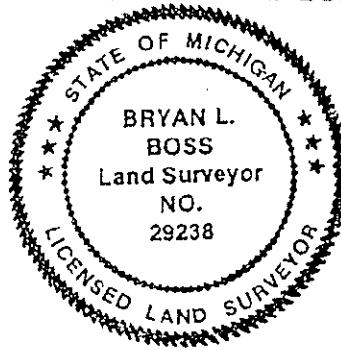

Bryan L. Boss