

LAND CORNER RECORDATION CERTIFICATE  
Filing Requirement of Act 74, Mich. P.A. 1970

For Corners in GREEN OAK TWP.

LIVINGSTON  
(COUNTY)

Located In

Corner Code #

FILED

1. Public Land Survey

T1N R6E

A-10

T\_\_\_ R\_\_\_

T\_\_\_ R\_\_\_

T\_\_\_ R\_\_\_

2. Property Controlling  
in Section

S\_\_\_ T\_\_\_ R\_\_\_

S\_\_\_ T\_\_\_ R\_\_\_

3. Miscellaneous

S\_\_\_ T\_\_\_ R\_\_\_

Property in Sec.

S\_\_\_ T\_\_\_ R\_\_\_

1996 DEC 19 A 11:27

NANCY HAVILAND  
REGISTER OF DEEDS  
LIVINGSTON COUNTY, MI.  
48843

L.S.C.#639m

REGISTER OF DEEDS STAMP & FILE NUMBER

4. Lot No. \_\_\_\_\_, Recorded Plat \_\_\_\_\_

5. Private Claims \_\_\_\_\_

I, BRYAN L. BOSS In a field survey on NOVEMBER 21, 1996,  
do hereby certify that under requirements of P.A. 74, Michigan P.A. of 1970, the corner points mentioned  
in lines 1 and 2 above were in conformance with regulations and rules therefore as required in the  
current manual of survey instructions of the United States Department of the Interior, bureau of Land  
Management or by a decree of a Court of Law and/or that the corner points mentioned in lines 3, 4 and 5  
above were in conformance with the rules of the Michigan Board of Land Surveyors or by a Decree of a  
Court of Law, established, re-established, monumented, re-monumented, recovered, found as  
expressed below:

NOTE: Not more than 4 corners, all in the same town and range, may be recorded  
on this certificate.

A. Description of original monument and accessories and/or subsequent restoration:

HICKORY 8" N 10° W 2.40

HICKORY 6" NORTH 2.95

B. Description of corner evidence found and/or applied in restoring or reestablishing corner:

FOUND 3/4" IRON PIPE 2 FEET ± WEST OF FENCE CORNER POST AND 2.68 FEET  
WEST OF TOWNSHIP LINE, IN POND.

C. Description of monument for corner and accessories established to perpetuate location the position of the corner:

SET 1 1/4" X 36" IRON PIPE WITH BRASS CAP STAMPED  
"LIVINGSTON COUNTY REMONUMENTATION CORNER".

N 25° W NAIL & TAG EAST SIDE 12" OAK 130.59'

N 45° W NAIL & TAG WEST SIDE 24" OAK 90.06'

S 85° W NAIL & TAG NORTH SIDE 8" APPLE 121.89'

S 15° W NAIL & TAG WEST SIDE 6" OAK 97.81'

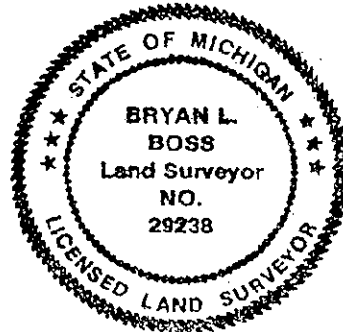

Signed by Bryan L. Boss Date 12-12-1996  
Surveyor's Michigan License No. 29238

FORM APPROVED BY MICHIGAN STATE BOARD OF LAND SURVEYORS, JAN. 28, 1971

REVISED MAY 14, 1975

REVISED JAN., 1983

P.A. 345 1990, APPROVED BY LIVINGSTON COUNTY

PEER GROUP ON 8-28-96 CO. REP JED

## SUMMARY

### A-10

West ¼ Corner, Section 30, T1N-R6E, Green Oak Township, Livingston County, Michigan

Found a 3/4" iron pipe 2 feet ± West of fence corner post and 2.68 feet West of the township line between M-11 and M-10, Hamburg Township.

Patrick Benton survey on page 14 of this dossier, denotes West ¼ corner (not in) on June 26, 1979 and again on December 10, 1979, West ¼ corner not in. Boss Engineering surveys on page 16 and 17 did not witness or call what was found or set in 1982 and 1986.

On December 21, 1987, Boss Engineering traversed Southwest ¼ of Section 30 and found 1" iron pipe, see pages 18 & 19 of this dossier.

On March 4, 1992, Christopher W. Newman recorded an Act 74 and witnesses checked with Boss Engineering surveys, see pages 16 & 23 (note the location of the iron found North 93.94 feet).

All evidence established West ¼ corner of Section 30 at 3/4" iron pipe and we recommend acceptance as found.

This corner is located in a fence row and wooded area resulting in a difficult G.P.S. Station.

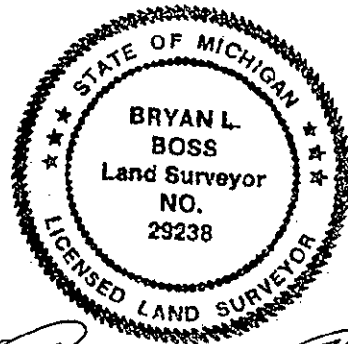

*Bryan L. Boss*  
Bryan L. Boss No. 29238