

MAR 17 2000

SECTION

LAND CORNER RECORDATION CERTIFICATE
Filing Requirement of Act 74, Mich. P.A. 1970

FILED

For corners in

LIVINGSTON

(County)

Located in: GENOA

Corner Code #

9

1999 NOV 22 A 11:07

NANCY HAVILAND
REGISTER OF DEEDS
LIVINGSTON COUNTY, MI.
48843

LSC# 1103m

Register of Deeds Stamp and File Number

1. Public Land Survey T 2N R 5E F-9
2. Property Controlling in Section S T R
3. Miscellaneous Property in Sec. S T R
4. Lot No. , Recorded Plat
5. Private Claims

I, Bryan L. Boss, in a field survey on NOVEMBER 4, 1999

do hereby certify that under requirements of P.A. 74, Michigan P.A. of 1970, the corner points mentioned in lines 1 and 2 above were in conformance with regulations and rules therefor as required in the current manual of survey instructions of the United States Department of the Interior, Bureau of Land Management or by a decree of a Court of Law and/or that the corner points mentioned in lines 3, 4 and 5 above were in conformance with the rules of the Michigan Board of Land Surveyors or by a Decree of a Court of Law; established, re-established, monumented, re-monumented, recovered, found as expressed below.

NOTE: Not more than 4 corners, all in the same town and range, may be recorded on this certificate.

A. Description of original monument and accessories and/or subsequent restoration:

SET POST AT AVERAGE DISTANCE ON TRUE LINE
16" B. OAK S40°W 2.26 CHAINS
8" TAMARACK 0 1/4°E 2.75 CHAINS

B. Description of corner evidence found and/or method applied in restoring or reestablishing corner:

FOUND BOSS 1/2" IRON ROD

C. Description of monument for corner and accessories established to perpetuate locating the position of the corner:

SET 1 1/4"X36" PIPE WITH BRASS CAP STAMPED
"LIVINGSTON COUNTY REMONUMENTATION
CORNER"
N15°E 15.73' S REMON NAIL & TAG W/SIDE
DEAD WILLOW
S15°E 34.02' S REMON NAIL & TAG W/SIDE
MULTI-STEM TREE
S05°W 30.70' S REMON NAIL & TAG E/SIDE
TWIN TREE
S75°W 29.47' S REMON NAIL & TAG NW/SIDE
MULTI-STEM TREE

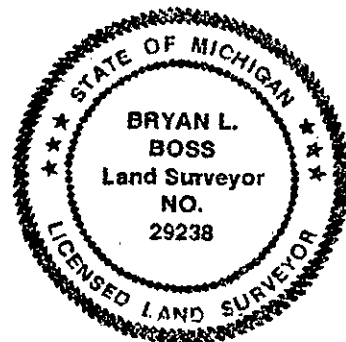

PA. 345 1980, APPROVED BY LIVINGSTON COUNTY

PEER GROUP ON 10-20-99, CO. REP JED

Signed by *Bryan L. Boss*

Date NOV. 10, 1999

Surveyor's Michigan License No. 29238